

M 8x1

KM 8



Locknut

AH 8

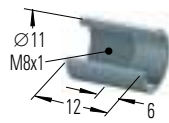

Stop Collar

MB 8

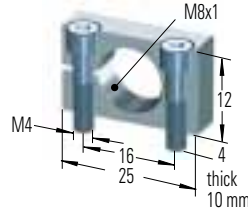

Clamp Mount

BV 8

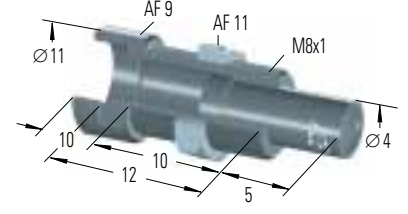

Side Load Adaptor

PB 8

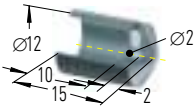

Steel Shroud

PS 8

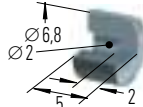

Steel Button
(for switch)

AS 8

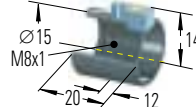

Switch Stop Collar
inc. Proximity Switch

Accessories, mounting, installation... see pages 24 to 28.

M 10x1

KM 10

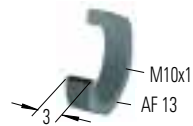

Locknut

AH 10

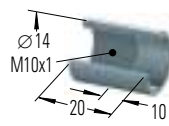

Stop Collar

MB 10

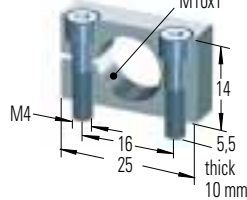

Clamp Mount

UM 10

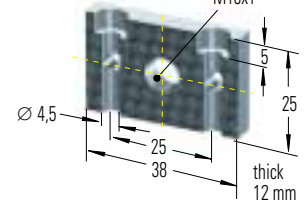

Universal Mount

BV 10

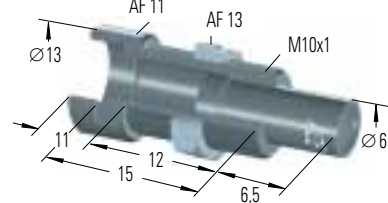

Side Load Adaptor

PB 10

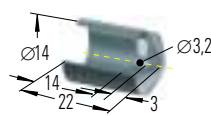

Steel Shroud

PS 10

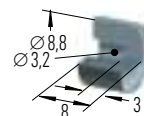

Steel Button
(for switch)

AS 10



Switch Stop Collar
inc. Proximity Switch

Accessories, mounting, installation... see pages 24 to 28.

M 12x1

KM 12



Locknut

AH 12

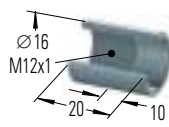

Stop Collar

MB 12

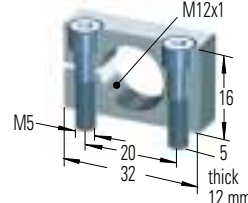

Clamp Mount

UM 12

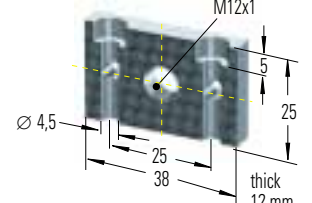

Universal Mount

BV 12

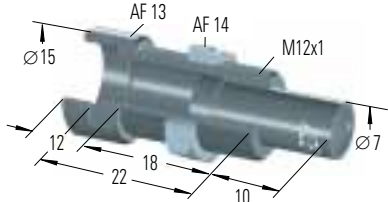

Side Load Adaptor

PB 12

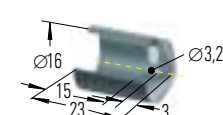

Steel Shroud

PS 12



Steel Button
(for switch)

AS 12



Switch Stop Collar
inc. Proximity Switch

Accessories, mounting, installation... see pages 24 to 28.

M 14x1,5

KM 14



Locknut

AH 14

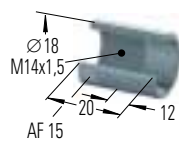

Stop Collar

MB 14

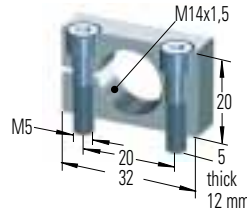

Clamp Mount

UM 14

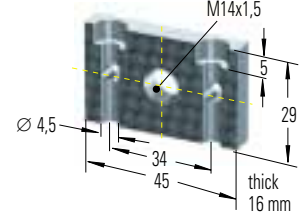

Universal Mount

PP 150

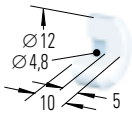

Nylon Button for MC 150 M

BV 14

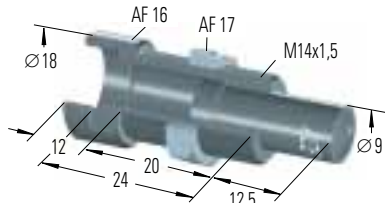

Side Load Adaptor for MC 150 M and MA 150 M

BV 14 SC

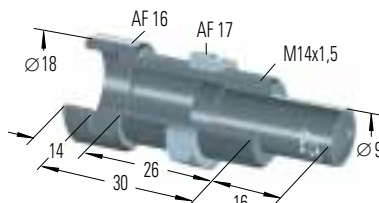

Side Load Adaptor for SC 190 M

SP 14

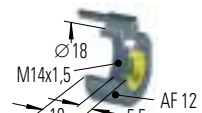

Air Bleed Collar for MC 150 M

PB 14

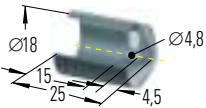

Steel Shroud PB 14 for MA 150 M, MC 150 M

PB 14 SC

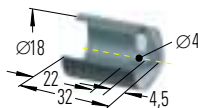

Steel Shroud PB 14 SC for SC 190 M

PS 14

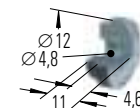

Steel Button for MC 150 M and MA 150 M

AS 14

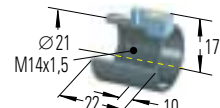

Switch Stop Collar inc. Proximity Switch

Accessories, mounting, installation... see pages 24 to 28.

M 20x1,5

KM 20



Locknut

AH 20

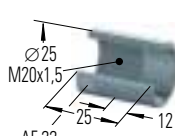

Stop Collar

MB 20

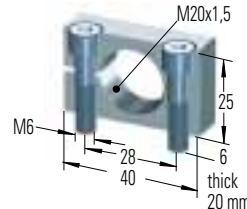

Clamp Mount

UM 20

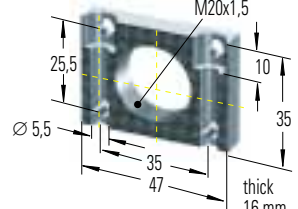

Universal Mount

PP 225

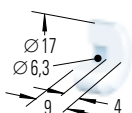

Nylon Button for MC 225 M

BV 20

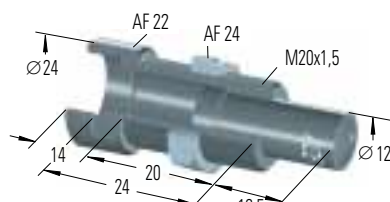

Side Load Adaptor for MC 225 M

BV 20 SC

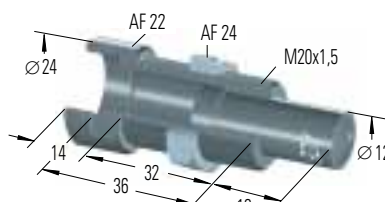

Side Load Adaptor for SC 300 M and MA 225 M

SP 20

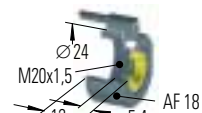

Air Bleed Adaptor for MC 225 M

PB 20

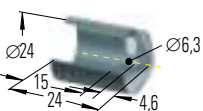

Steel Shroud PB 20 for MC 225 M

PB 20 SC

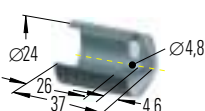

Steel Shroud PB 20 SC for SC 300 M & MA 225 M

PS 20

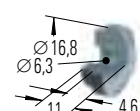

Steel Button PS 20 for MC 225 M

AS 20

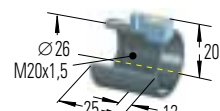

Switch Stop Collar inc. Proximity Switch

Accessories, mounting, installation... see pages 24 to 28.

M 25x1,5

KM 25



Lock Nut

AH 25

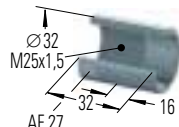

Stop Collar

MB 25

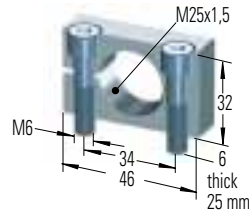

Clamp Mount

UM 25

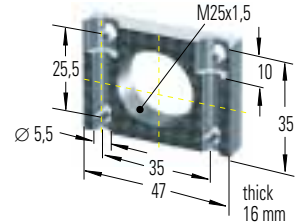

Universal Mount

PP 600

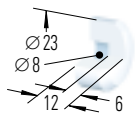

Nylon Button
for MC 600 M

BV 25

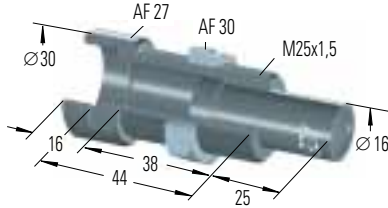

Side Load Adaptor
for MC 600 M

BV 25 SC

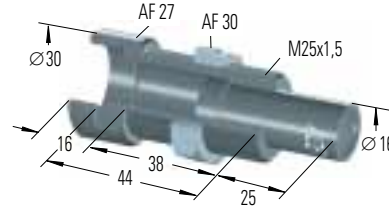

Side Load Adaptor
for SC 650 M and MA 600 M

SP 25

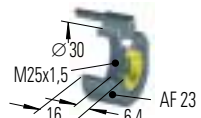

Air Bleed Adaptor
for MC 600 M

PB 25

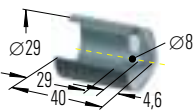

Steel Shroud
PB 25 for MC 600 M

PB 25 SC

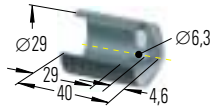

Steel Shroud
PB 25 SC for SC 650 M
and MA 600 M

PS 25

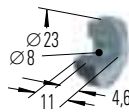

Steel Button
PS 25 for MC 600 M

AS 25

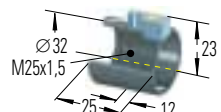

Switch Stop Collar
inc. Proximity Switch

CR 25

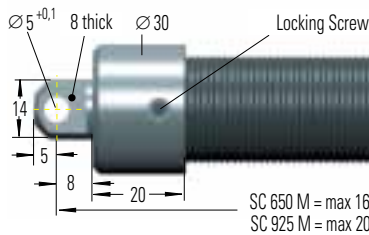

Rear Clevis
for SC 650 M and SC 925 M

CF 25

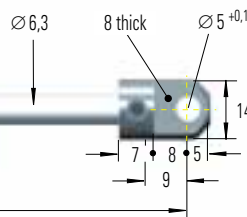

Front Clevis
for SC 650 M and SC 925 M

Installation:

1. Warm standard button and remove from shock absorber.
2. Mount CF 25 and lock in place.
3. Thread on CR or CRA to body and adjust centre to centre length.
4. Lock CR or CRA in place.
5. Mechanical stops must be fitted at both ends of travel. (approx. 0.5 to 1 mm before end of stroke).

CRA 25

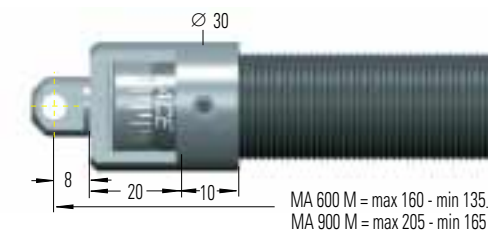

Rear Clevis
for MA 600 M and MA 900 M

CF 25



Front Clevis
for MA 600 M and MA 900 M

Accessories, mounting, installation... see pages 24 to 28.