

LV HRC fuse element, NH00, In: 100 A, gG, Un AC: 690 V, Un DC: 250 V, Front indicator, live grip lugs



Model	
Product brand name	SETRON
Product designation	LV HRC fuse link
Design of the product	With blade contacts
Design of an identification indicator	Front indicators
Design of the switching contact	Non-corroding, silver-plated
Design of the fuse link	LV HRC fuse link
General technical data	
Size of fuse system / acc. to DIN EN 60269-1	NH00
Operating class of the fuse link	gG
circuit-breaker / Design	3NA3
Type of voltage	AC/DC
Current / at AC / rated value	100 A
Supply voltage	
• at AC / rated value	690 V
• at DC	250 V
Protection class	
Protection class IP	IP20, with connected conductors

Switching capacity

Switching capacity current	
• at DC / acc. to IEC 60947-2 / rated value	25 kA
• acc. to IEC 60947-2 / rated value	120 kA

Dissipation

Power loss [W]	9.28 W
Power loss [W] / for rated value of the current / at AC / in hot operating state / per pole	9.28 W

Current

Tripping residual / rated value / derated current / at 40 Cel	95 A
Diken-export / Let-through energy	DE_3NA_00_690_gG_100

Mechanical Design



Width	
• of the enclosure	30 mm
Mounting position	Any, preferably vertical
Net weight	190 g

Environmental conditions

Ambient temperature	
• minimum	-5 °C
• maximum	40 °C
Ambient temperature / during storage	Air humidity 90% at 20 °C
Environmental category	-20 to +50 at 95% relative humidity

Certificates

Reference code	
• acc. to DIN EN 61346-2	F
• acc. to DIN EN 81346-2	F

General Product Approval	Declaration of Conformity	Test Certificates			
 CCC	 VDE	 EG-Konf.	Type Test Certificates/Test Report	Special Test Certificate	Miscellaneous

Shipping Approval	other		
 GL	Environmental Conformations	Miscellaneous	

Further information

Information- and Downloadcenter (Catalogs, Brochures,...)

<http://www.siemens.com/lowvoltage/catalogs>

Industry Mall (Online ordering system)

<https://mall.industry.siemens.com/mall/en/en/Catalog/product?mlfb=3NA3830-6>

Service&Support (Manuals, Certificates, Characteristics, FAQs,...)

<https://support.industry.siemens.com/cs/ww/en/ps/3NA3830-6>

Image database (product images, 2D dimension drawings, 3D models, device circuit diagrams, ...)

http://www.automation.siemens.com/bilddb/cax_en.aspx?mlfb=3NA3830-6

CAX-Online-Generator

<http://www.siemens.com/cax>

Tender specifications

<http://www.siemens.com/specifications>

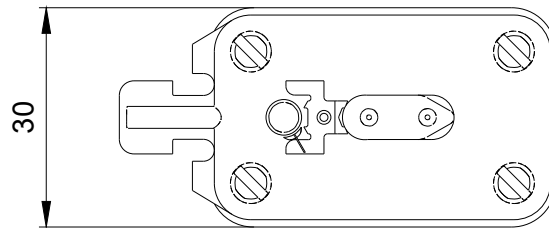
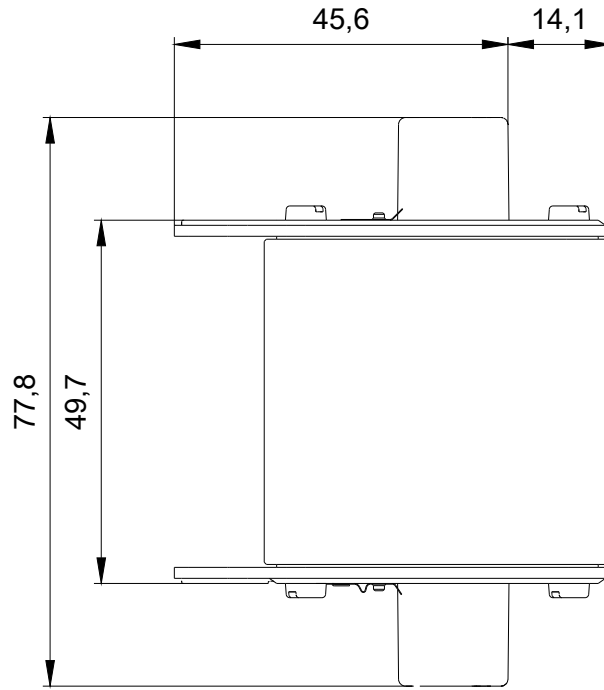

1

-F1

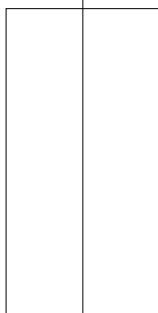

2