

Low Voltage Products

HRC Fuse Links OFAFN_ and OFFN_
DIN and BS types, gG





Fuse protection - safe and reliable

2A...1250 A, 500 V

DIN-Type HRC fuse links (blade-type), 2A...1250 A, 500 V

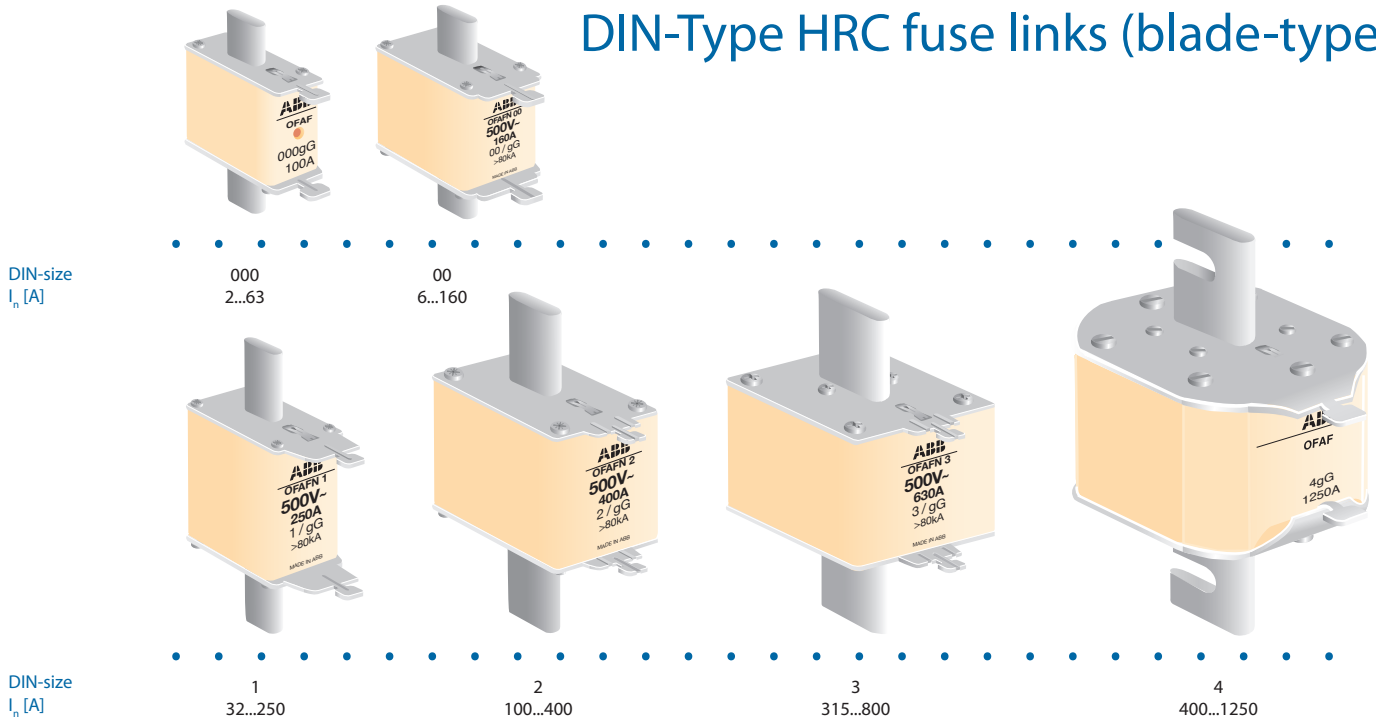

BS-Type HRC fuse links (bolted-type), 2A...800 A, 500 V

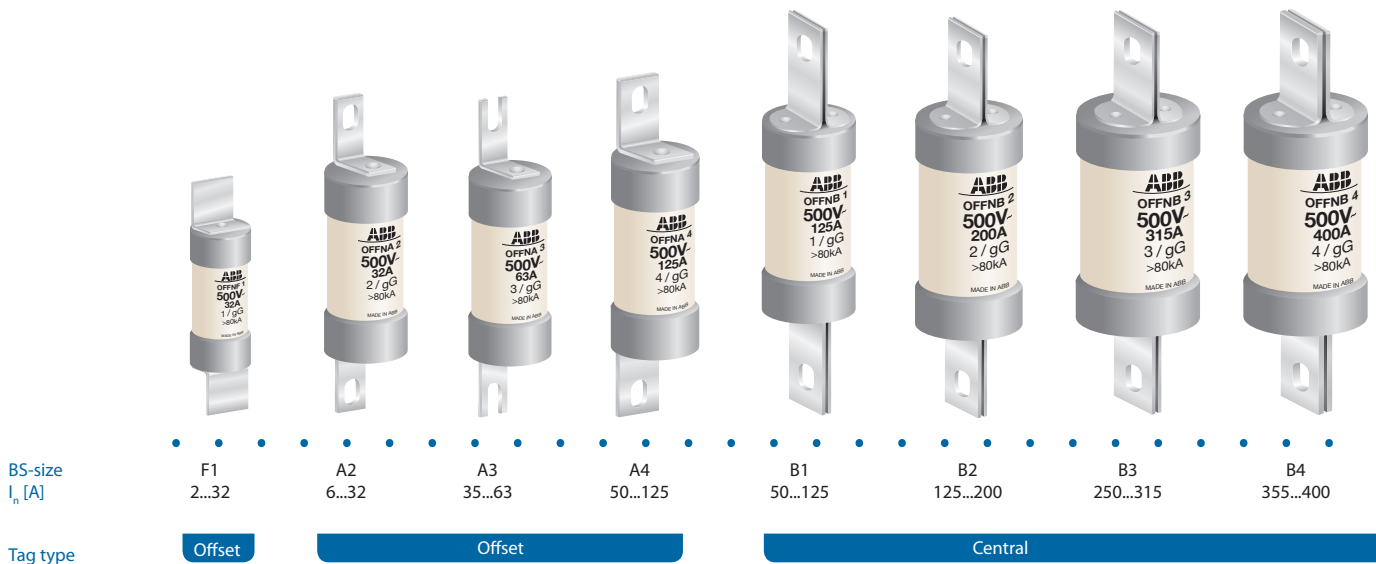

and reliable

...1250 A, 500 V

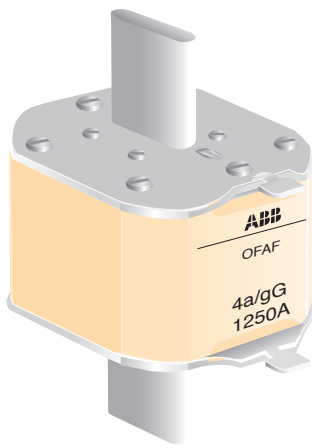

4a
500...1250



C2
400...800



HRC fuse links

DIN and BS-type

OFAFN_ and OFAF_

OFFN_

Contents:

| | |
|---|-----|
| Features..... | 4 |
| Ordering information..... | 5-6 |
| DIN-type OFAFN_ and OFAF_ fuse links, type gG, 500 V..... | 5 |
| BS-type OFFN_ fuse links, type gG, 500 V..... | 6 |
| Time-current characteristics..... | 7-8 |
| Cut off -current characteristics..... | 9 |
| I ² t -values..... | 10 |
| Dimension drawings..... | 11 |

2A...1250 A, 500 V

- ▶ Total safety for your cables, motors and electronics protection.
- ▶ Wide and dense current ratings for optimal dimensioning of other circuit components.
- ▶ Low let through energy, low cut off characteristics, reduced electro magnetic stress.
- ▶ Energy saving through low power losses.
- ▶ No deration required for connected equipment in normal situation.
- ▶ High breaking capacity 80 kA at 500 V (AC).
- ▶ Fault indication on the top of the fuse link.
- ▶ Confirm the standards IS:13703 / IEC 60269.
- ▶ Available with ISI and CE marking.

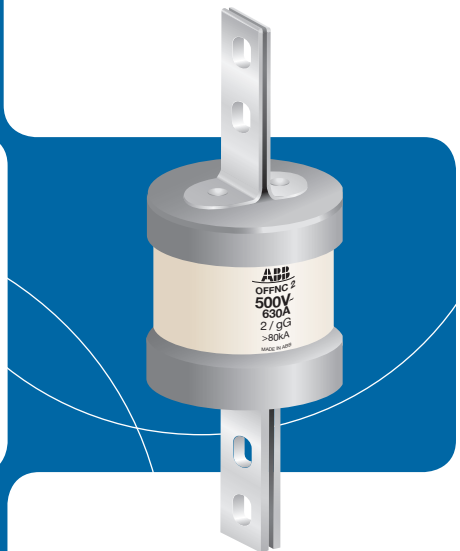
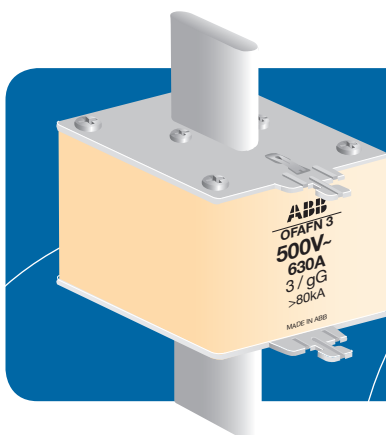
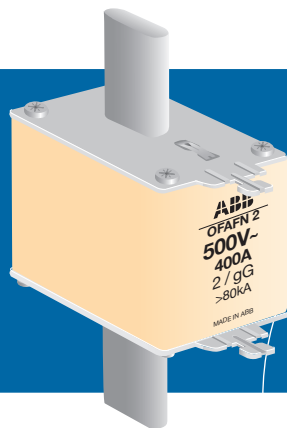
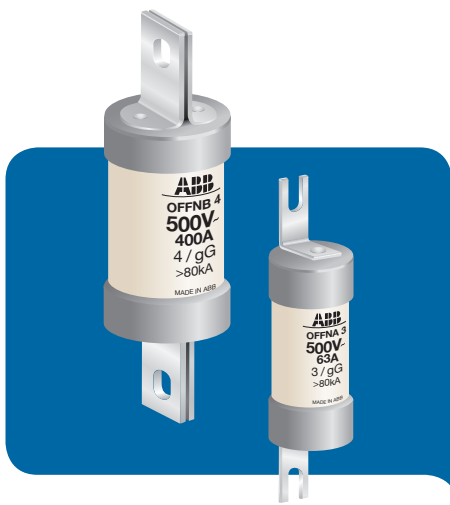

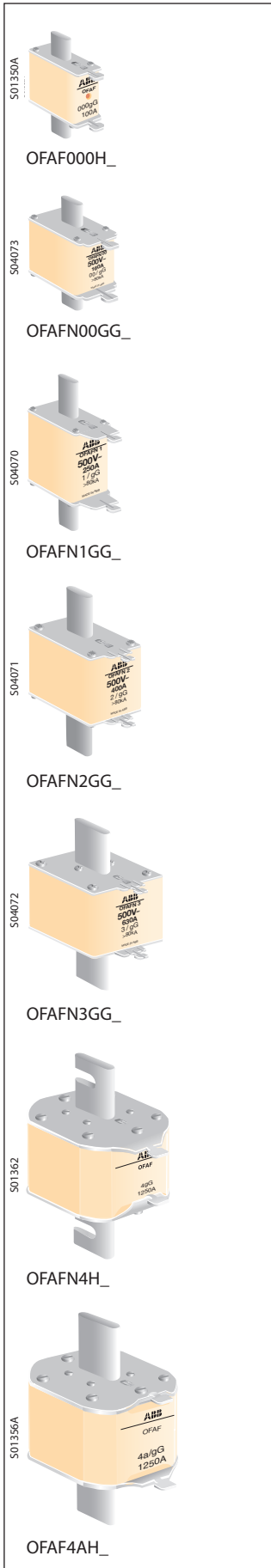

DIN -type fuse links, gG, 500 V, 80 kA

The type code includes one fuse link, the delivery batch is according to the column.

| IEC-size | In [A] | P _n [W] | Type | Order number | Delivery batch [pcs] | Weight/unit [kg] |
|----------|--------|--------------------|-----------------|-----------------|----------------------|------------------|
| 000 | 2 | 3.9 | OFAF000H2 | 1SCA022627R0230 | 9 | 0.120 |
| | 6 | 1.6 | OFAF000H6 | 1SCA022627R0400 | 9 | 0.120 |
| | 10 | 1.1 | OFAF000H10 | 1SCA022627R0580 | 9 | 0.120 |
| | 16 | 1.8 | OFAF000H16 | 1SCA022627R0660 | 9 | 0.120 |
| | 20 | 2.4 | OFAF000H20 | 1SCA022627R0740 | 9 | 0.120 |
| | 32 | 2.7 | OFAF000H32 | 1SCA022627R0910 | 9 | 0.120 |
| | 63 | 4.7 | OFAF000H63 | 1SCA022627R1390 | 9 | 0.120 |
| 00 | 6 | 1.0 | OFAFN00GG6 | 1SCA107754R1001 | 6 | 0.195 |
| | 10 | 1.4 | OFAFN00GG10 | 1SCA107755R1001 | 6 | 0.195 |
| | 16 | 2.4 | OFAFN00GG16 | 1SCA107756R1001 | 6 | 0.195 |
| | 20 | 2.5 | OFAFN00GG20 | 1SCA107757R1001 | 6 | 0.195 |
| | 25 | 2.6 | OFAFN00GG25 | 1SCA107758R1001 | 6 | 0.195 |
| | 32 | 4.2 | OFAFN00GG32 | 1SCA107759R1001 | 6 | 0.195 |
| | 50 | 4.8 | OFAFN00GG50 | 1SCA107760R1001 | 6 | 0.195 |
| | 63 | 6.1 | OFAFN00GG63 | 1SCA107761R1001 | 6 | 0.195 |
| | 80 | 6.6 | OFAFN00GG80 | 1SCA107762R1001 | 6 | 0.195 |
| | 100 | 7.3 | OFAFN00GG100 | 1SCA107763R1001 | 6 | 0.195 |
| | 125 | 10.4 | OFAFN00GG125 | 1SCA107764R1001 | 6 | 0.195 |
| 160 | 11.4 | OFAFN00GG160 | 1SCA107765R1001 | 6 | 0.195 | |
| 1 | 32 | 4.4 | OFAFN1GG32 | 1SCA107766R1001 | 5 | 0.235 |
| | 50 | 6.3 | OFAFN1GG50 | 1SCA107767R1001 | 5 | 0.425 |
| | 63 | 6.7 | OFAFN1GG63 | 1SCA107768R1001 | 5 | 0.425 |
| | 80 | 8.0 | OFAFN1GG80 | 1SCA107769R1001 | 5 | 0.425 |
| | 100 | 10.7 | OFAFN1GG100 | 1SCA107770R1001 | 5 | 0.425 |
| | 125 | 13.4 | OFAFN1GG125 | 1SCA107771R1001 | 5 | 0.425 |
| | 160 | 15.5 | OFAFN1GG160 | 1SCA107772R1001 | 5 | 0.425 |
| | 200 | 20.0 | OFAFN1GG200 | 1SCA107773R1001 | 3 | 0.425 |
| 250 | 21.5 | OFAFN1GG250 | 1SCA107774R1001 | 3 | 0.425 | |
| 2 | 100 | 10.0 | OFAFN2GG100 | 1SCA107775R1001 | 3 | 0.444 |
| | 125 | 12.0 | OFAFN2GG125 | 1SCA107776R1001 | 3 | 0.585 |
| | 250 | 22.0 | OFAFN2GG250 | 1SCA107778R1001 | 3 | 0.585 |
| | 315 | 25.0 | OFAFN2GG315 | 1SCA107779R1001 | 3 | 0.585 |
| | 400 | 30.0 | OFAFN2GG400 | 1SCA107780R1001 | 3 | 0.585 |
| 3 | 315 | 22.0 | OFAFN3GG315 | 1SCA107781R1001 | 3 | 0.975 |
| | 500 | 36.0 | OFAFN3GG500 | 1SCA107783R1001 | 3 | 0.975 |
| | 630 | 39.0 | OFAFN3GG630 | 1SCA107784R1001 | 3 | 0.975 |
| | 800 | | OFAFN3GG800 | 1SCA107785R1001 | 3 | 0.975 |
| 4 | 400 | 31.0 | OFAF4H400 | 1SCA022627R7320 | 1 | 2.000 |
| | 500 | 35.0 | OFAF4H500 | 1SCA022627R7410 | 1 | 2.000 |
| | 630 | 44.0 | OFAF4H630 | 1SCA022627R7590 | 1 | 2.000 |
| | 800 | 70.0 | OFAF4H800 | 1SCA022627R7670 | 1 | 2.000 |
| | 1000 | 85.0 | OFAF4H1000 | 1SCA022627R7750 | 1 | 2.000 |
| | 1250 | 93.0 | OFAF4H1250 | 1SCA022627R7830 | 1 | 2.000 |
| 4a | 500 | 33.0 | OFAF4AH500 | 1SCA022637R3980 | 1 | 2.000 |
| | 630 | 43.0 | OFAF4AH630 | 1SCA022637R4010 | 1 | 2.000 |
| | 800 | 58.0 | OFAF4AH800 | 1SCA022637R4100 | 1 | 2.000 |
| | 1000 | 71.0 | OFAF4AH1000 | 1SCA022637R4280 | 1 | 2.000 |
| | 1250 | 85.0 | OFAF4AH1250 | 1SCA022637R4360 | 1 | 2.000 |



HRC Fuse links, BS-type

Ordering information

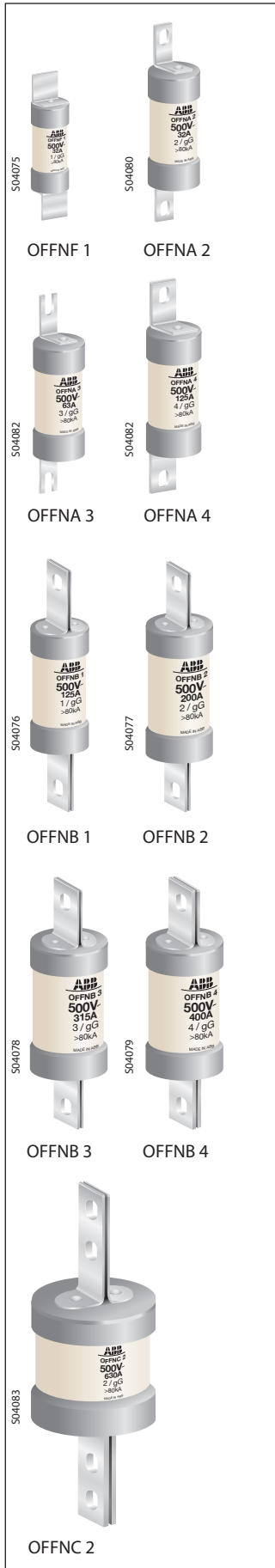

BS -type fuse links, gG, 500 V, 80 kA

The type code includes one fuse link, but the delivery batch is according to the column.

| BS-fuse type | In [A] | Ph [W] | Type | Order number | Delivery batch [pcs] | Weight/unit [kg] |
|-------------------------|--------|--------|------------|-----------------|----------------------|------------------|
| Tag type: Offset | | | | | | |
| F1 | 2 | 0.7 | OFFNF1GG2 | 1SCA107786R1001 | 20 | 0.015 |
| | 4 | 0.7 | OFFNF1GG4 | 1SCA107787R1001 | 20 | 0.015 |
| | 6 | 1.0 | OFFNF1GG6 | 1SCA107788R1001 | 20 | 0.015 |
| | 10 | 1.1 | OFFNF1GG10 | 1SCA107789R1001 | 20 | 0.015 |
| | 16 | 1.6 | OFFNF1GG16 | 1SCA107790R1001 | 20 | 0.015 |
| | 20 | 1.9 | OFFNF1GG20 | 1SCA107791R1001 | 20 | 0.015 |
| | 25 | 2.4 | OFFNF1GG25 | 1SCA107792R1001 | 20 | 0.015 |
| | 32 | 2.7 | OFFNF1GG32 | 1SCA107793R1001 | 20 | 0.015 |

Tag type: Offset, two holes fixing 20

| | | | | | | |
|----|-----|------|-------------|-----------------|----|-------|
| A2 | 6 | 1.4 | OFFNA2GG6 | 1SCA107795R1001 | 10 | 0.050 |
| | 10 | 1.6 | OFFNA2GG10 | 1SCA107796R1001 | 10 | 0.050 |
| | 16 | 2.5 | OFFNA2GG16 | 1SCA107798R1001 | 10 | 0.050 |
| | 20 | 2.8 | OFFNA2GG20 | 1SCA107827R1001 | 10 | 0.050 |
| | 25 | 2.8 | OFFNA2GG25 | 1SCA107800R1001 | 10 | 0.050 |
| A3 | 32 | 4.0 | OFFNA2GG32 | 1SCA107801R1001 | 10 | 0.050 |
| | 35 | 5.0 | OFFNA3GG35 | 1SCA107802R1001 | 10 | 0.055 |
| | 40 | 5.2 | OFFNA3GG40 | 1SCA107803R1001 | 10 | 0.055 |
| A4 | 50 | 5.5 | OFFNA3GG50 | 1SCA107804R1001 | 10 | 0.055 |
| | 63 | 6.8 | OFFNA3GG63 | 1SCA107805R1001 | 10 | 0.055 |
| | 50 | 6.0 | OFFNA4GG50 | 1SCA107806R1001 | 10 | 0.145 |
| | 63 | 6.6 | OFFNA4GG63 | 1SCA107807R1001 | 10 | 0.145 |
| B1 | 80 | 7.9 | OFFNA4GG80 | 1SCA107808R1001 | 10 | 0.145 |
| | 100 | 8.6 | OFFNA4GG100 | 1SCA107809R1001 | 10 | 0.145 |
| | 125 | 12.0 | OFFNA4GG125 | 1SCA107810R1001 | 10 | 0.145 |
| | 50 | 6.0 | OFFNB1GG50 | 1SCA107811R1001 | 10 | 0.145 |
| | 63 | 6.7 | OFFNB1GG63 | 1SCA107812R1001 | 10 | 0.145 |
| B2 | 80 | 8.0 | OFFNB1GG80 | 1SCA107813R1001 | 10 | 0.145 |
| | 100 | 8.6 | OFFNB1GG100 | 1SCA107814R1001 | 10 | 0.145 |
| | 125 | 12.0 | OFFNB1GG125 | 1SCA107815R1001 | 10 | 0.145 |
| | 125 | 13.5 | OFFNB2GG125 | 1SCA107816R1001 | 3 | 0.230 |
| | 160 | 17.2 | OFFNB2GG160 | 1SCA107817R1001 | 3 | 0.230 |
| | 200 | 20.4 | OFFNB2GG200 | 1SCA107818R1001 | 3 | 0.230 |

Tag type: Central, two holes fixing 10

| | | | | | | |
|----|-----|------|-------------|-----------------|---|-------|
| B3 | 250 | 24.5 | OFFNB3GG250 | 1SCA107819R1001 | 3 | 0.390 |
| | 315 | 28.5 | OFFNB3GG315 | 1SCA107820R1001 | 3 | 0.390 |
| B4 | 355 | 35.0 | OFFNB4GG355 | 1SCA107821R1001 | 3 | 0.440 |
| | 400 | 37.0 | OFFNB4GG400 | 1SCA107822R1001 | 3 | 0.440 |

Tag type: Central, four holes fixing

| | | | | | | |
|----|-----|------|-------------|-----------------|---|-------|
| C2 | 400 | 35.0 | OFFNC2GG400 | 1SCA107823R1001 | 1 | 0.865 |
| | 500 | 40.0 | OFFNC2GG500 | 1SCA107824R1001 | 1 | 0.865 |
| | 630 | 50.0 | OFFNC2GG630 | 1SCA107825R1001 | 1 | 0.865 |
| | 800 | | OFFNC2GG800 | 1SCA107826R1001 | 1 | |



HRC Fuse links, DIN-type Time-current characteristics

Time-current characteristics, OFAFN00-3gG_ fuse links, type gG, 500 V

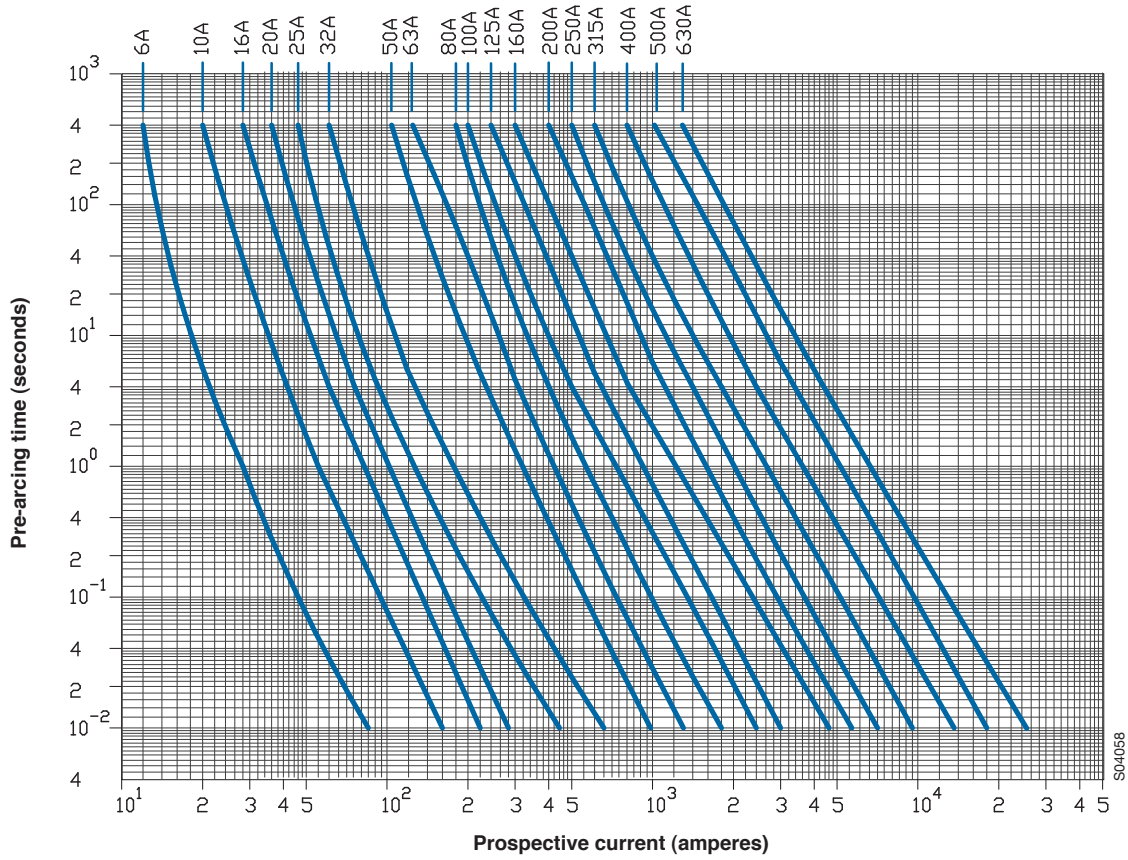

Time-current characteristics, OFAF000H_ and OFAF4-4AH_ fuse links, type gG, 500 V

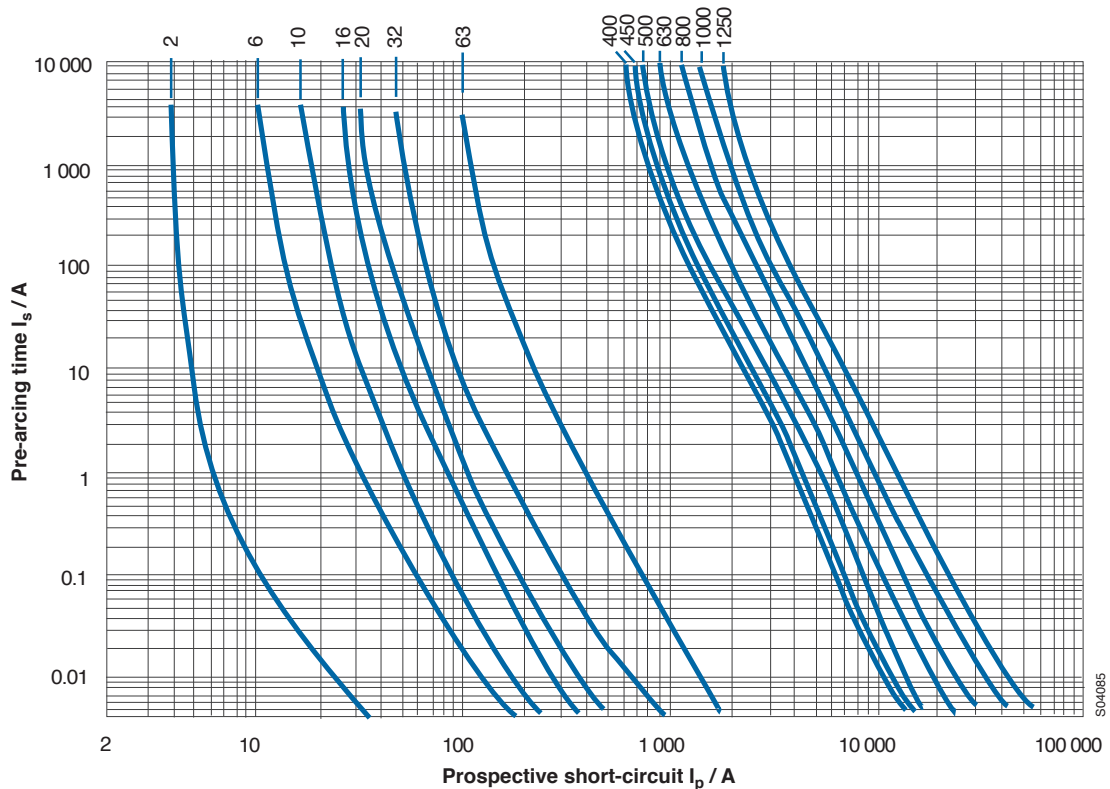



HRC Fuse links, BS-type Time-current characteristics

Time-current characteristics, OFFN_ fuse links, type gG, 500 V

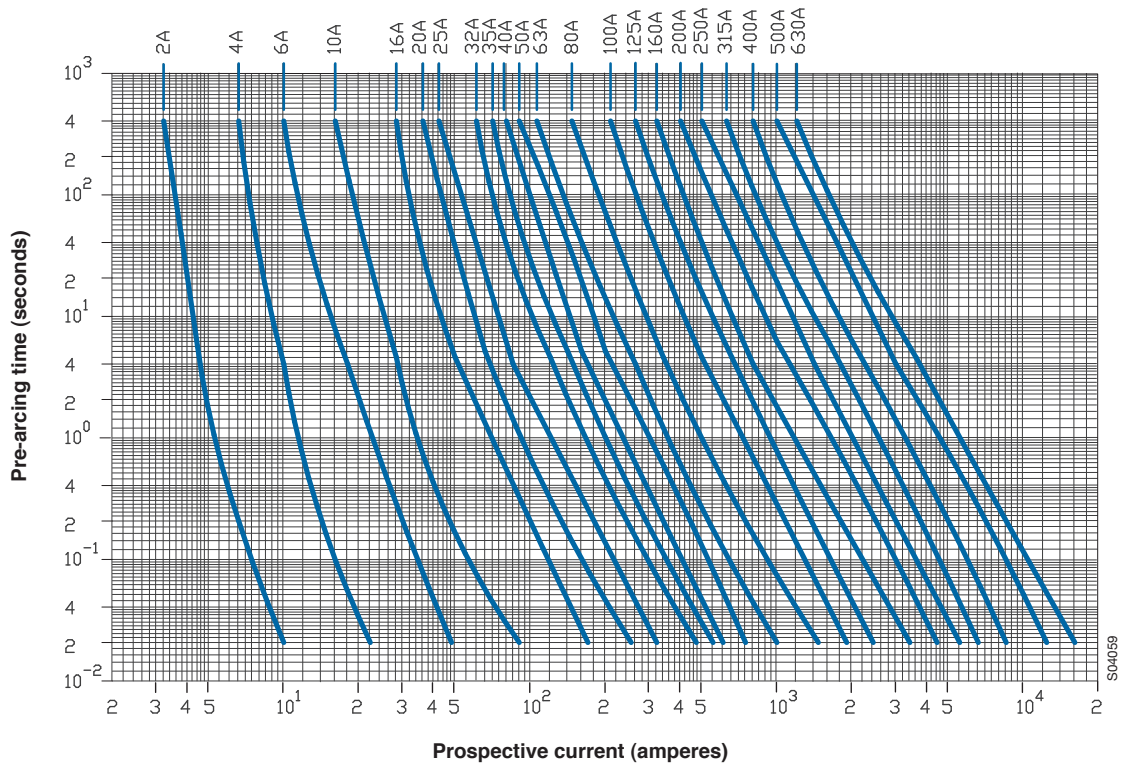



HRC Fuse links

Cut off -current characteristics

Current limitation, type OFAFN_ and OFFN_, type gG, 500 V

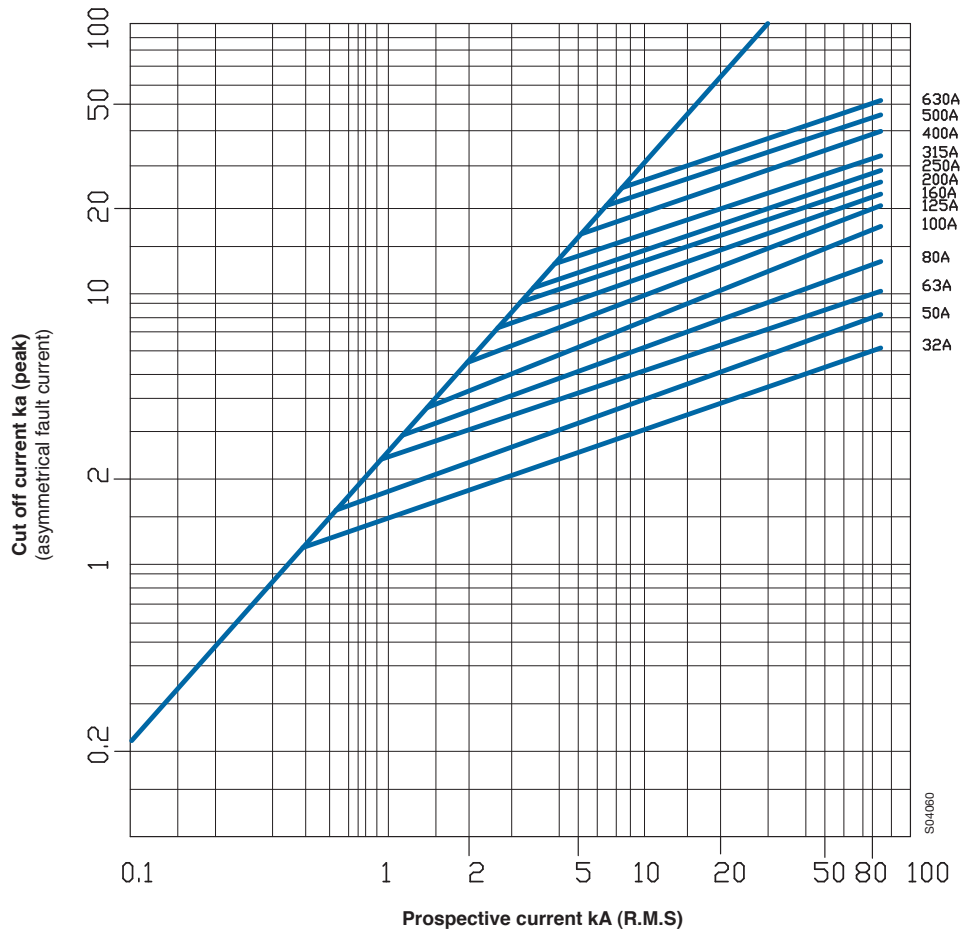

Current limitation, type OFAF000H_ and OFAF4-4AH_ fuse links, type gG, 500 V

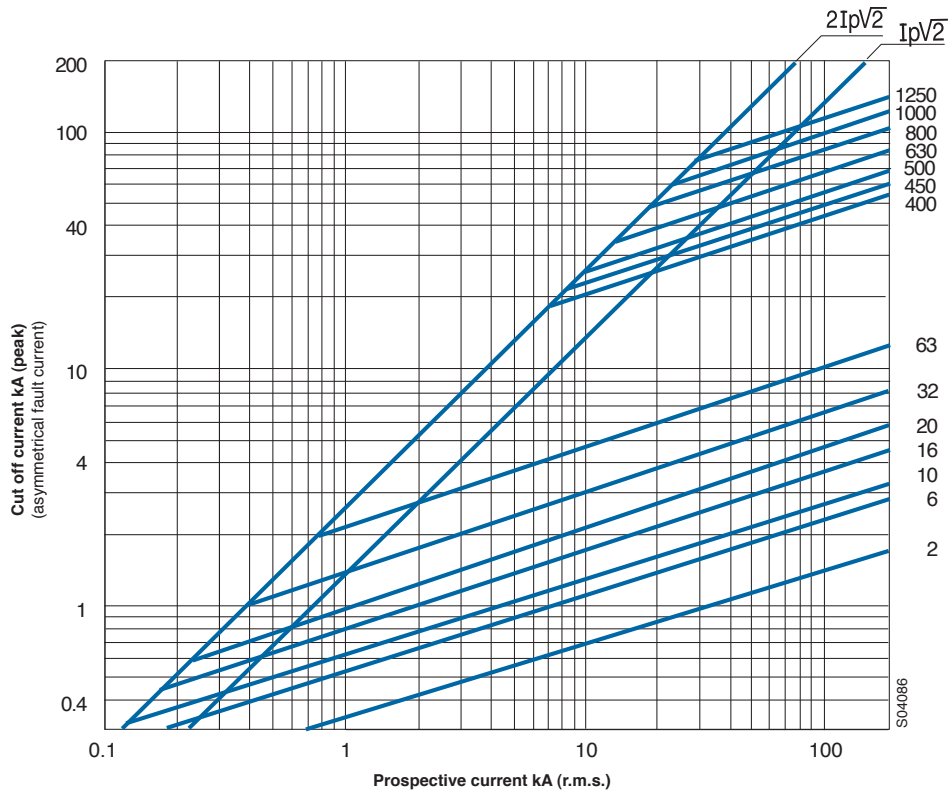



HRC Fuse links I^2t -values

I^2t -values, DIN-type OFAFN_ fuse links, type gG, 500 V

- with prospective current > 80 kA at 500 V

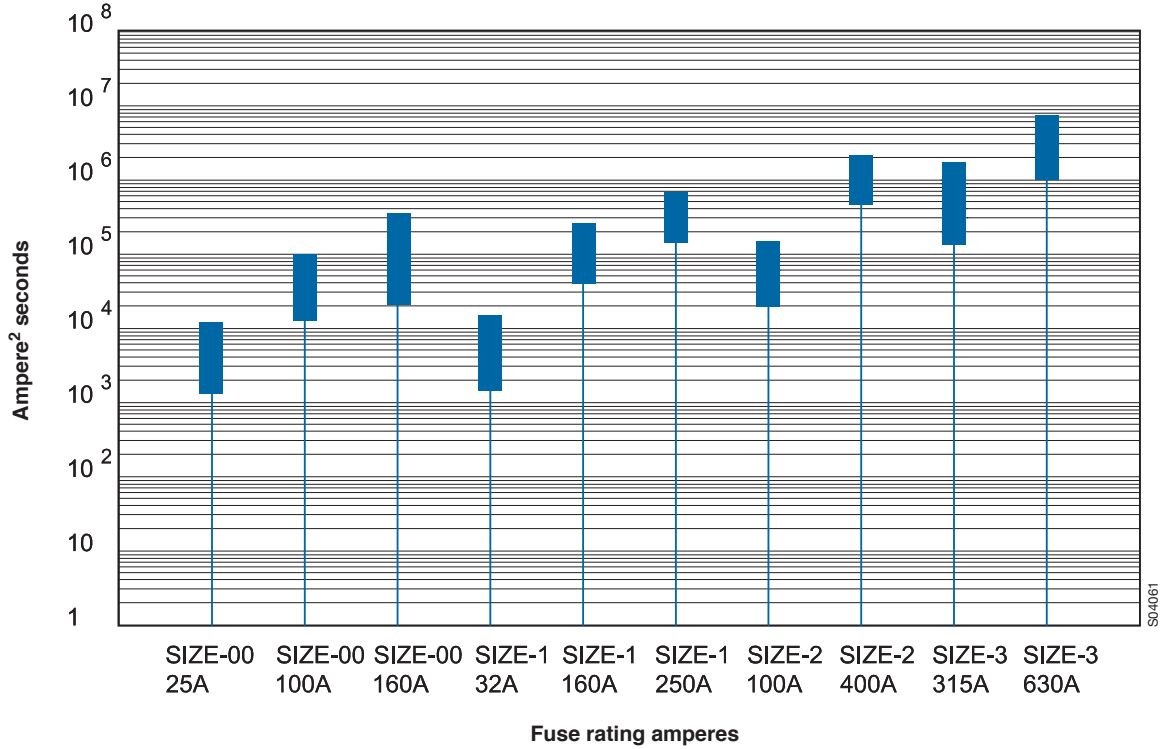

I^2t -values, BS- type OFFN_ fuse links, type gG, 500 V

- with prospective current > 80 kA at 500 V

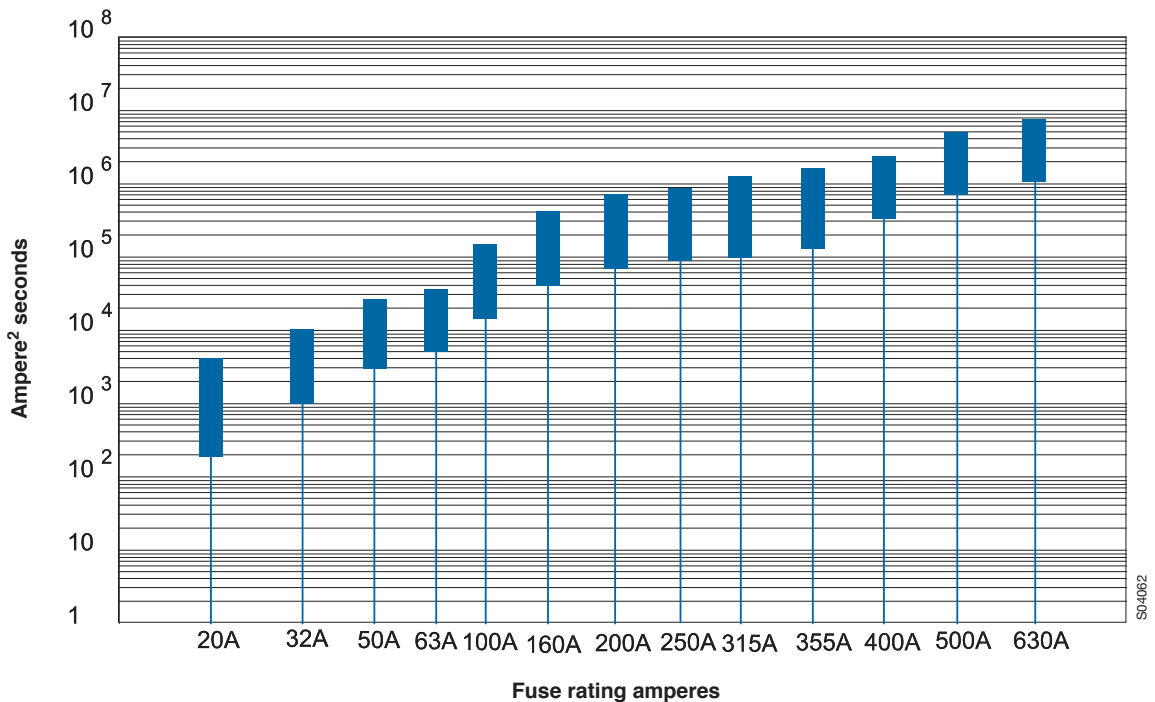



HRC Fuse links Dimension drawings

DIN-type OFAFN_ and OFAF_ fuse links

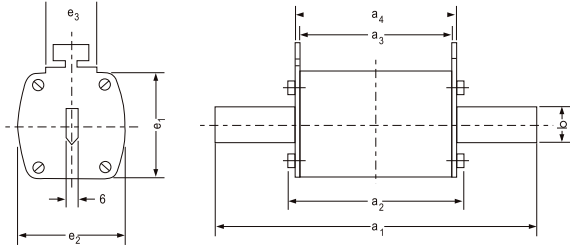

| DIN-fuse size | Rated Current | a1 | a2 | a3 | a4 | b | e1 | e2 | e3 |
|---------------|---------------|------|------|------|------|----|----|----|----|
| 00 | 6-160A | 78.5 | 51.5 | 45.5 | 49 | 15 | 43 | 30 | 20 |
| 1 | 32-160A | 135 | 70 | 63 | 67 | 15 | 43 | 30 | 20 |
| 1 | 200-250A | 135 | 70 | 63 | 67 | 20 | 48 | 46 | 22 |
| 2 | 100-250A | 150 | 70 | 63 | 67 | 20 | 48 | 46 | 22 |
| 2 | 315-400A | 150 | 72 | 60.5 | 67 | 33 | 57 | 56 | 25 |
| 3 | 315-630A | 150 | 73 | 62 | 68.5 | 25 | 68 | 66 | 25 |

SO4063

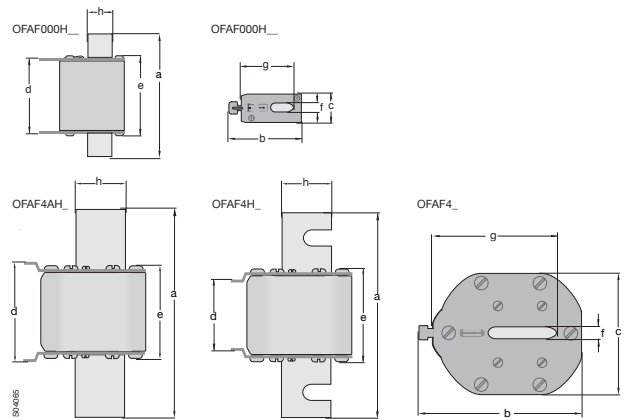

| DIN Fuse size | a | b | c | d | e | f | g | h |
|---------------|-----|------|------|------|----|---|----|----|
| 000 | 79 | 52.5 | 20.8 | 49.5 | 52 | 6 | 35 | 15 |
| 4 | 200 | 119 | 89 | 88 | 85 | 8 | 85 | 49 |
| 4a | 200 | 119 | 89 | 68 | 85 | 8 | 85 | 49 |

BS- type OFFN_ fuse links

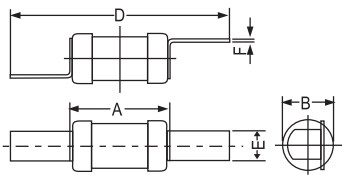

| BS-Fuse size | A | B | C | E | F |
|--------------|----|------|----|----|-----|
| F1 | 34 | 14.2 | 60 | 11 | 0.8 |

SO4064

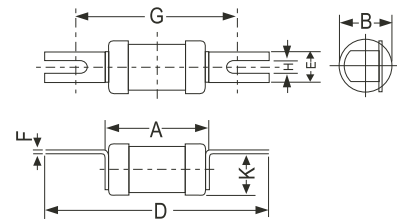

| BS-Fuse size | A | B | D | E | F | G | H | K |
|--------------|----|------|------|------|-----|----|-----|----|
| A3 | 56 | 21.5 | 88.5 | 12.7 | 1.2 | 73 | 5.5 | 23 |

SO4066

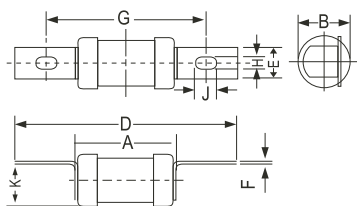

| BS-Fuse size | A | B | D | E | F | G | H | J | K |
|--------------|------|------|------|-----|------|----|-----|----|----|
| A2 | 56 | 21.5 | 84.5 | 8.7 | 1.2 | 73 | 5.5 | 8 | 23 |
| A4 | 64.5 | 31.8 | 110 | 17 | 2.65 | 94 | 8.7 | 10 | 33 |
| - | 73 | 39.5 | 110 | 19 | 2.35 | 94 | 8.7 | 11 | 42 |

SO4067

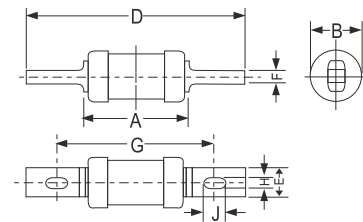

| BS-Fuse size | A | B | D | E | F | G | H | J |
|--------------|------|------|-----|------|-----|-----|-----|----|
| B1 | 63.5 | 31.8 | 136 | 17 | 3.2 | 111 | 8.7 | 11 |
| B2 | 72 | 39.5 | 132 | 19 | 3.2 | 111 | 8.7 | 11 |
| B3 | 70 | 50.5 | 136 | 25.4 | 3.2 | 111 | 8.7 | 11 |
| B4 | 72 | 50.5 | 136 | 25.4 | 5.3 | 111 | 8.7 | 11 |

SO4068

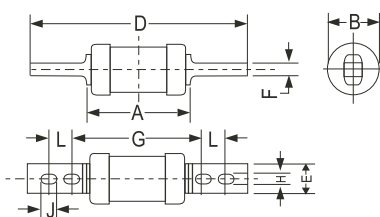

| BS-Fuse size | A | B | D | E | F | G | H | J |
|--------------|----|----|-----|------|-----|-----|------|------|
| C2 | 71 | 70 | 208 | 25.4 | 6.5 | 133 | 10.3 | 12.5 |

SO4069



ABB Limited

Plot Nos 5&6, 2nd Phase,
Peenya Industrial Area,
Bangalore 560058, India.
Telephone +91 80 2294 9340
Telefax +91 80 2294 9547
www.abb.com

The technical data and dimensions are valid at the time of printing.
We reserve the right to subsequent alterations.

Catalogue OF3GB_IN08_08
1SCC317005C0201

Produced by: KATANN Document Factory Oy, Vaasa Finland