

3-PHASE INFEED TERMINAL, SZ.S2 F. 3-PHASE
BUSBAR, CONNECTION FROM TOP

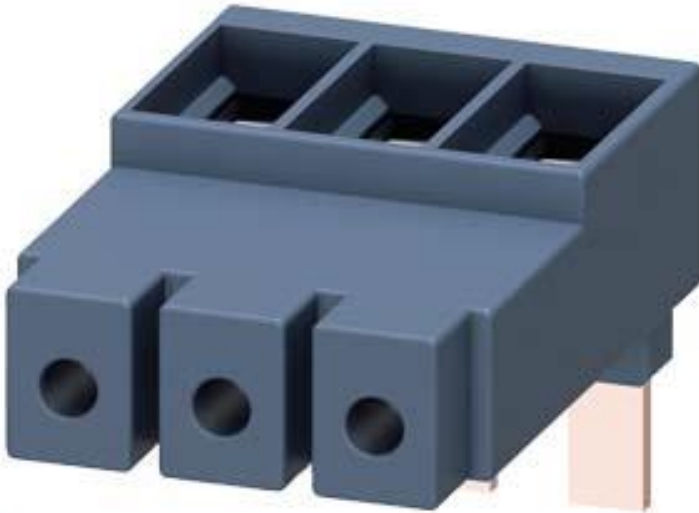









Figure similar

General technical data:		
product brandname		SIRIUS
Product designation		Three-phase feeder terminal
Design of the product		from above, size S2
Size of the circuit-breaker		S2
Protection class IP on the front		IP20
Insulation voltage with degree of pollution 3 rated value	V	690
Ambient temperature		
• during storage	°C	-50 ... +80
• during operation	°C	-20 ... +60
Ampacity maximum	A	105
Installation/ mounting/ dimensions:		
Width	mm	54.5
Height	mm	50.8
Depth	mm	76.5
Connections/ Terminals:		

Type of electrical connection for main current circuit		screw-type terminals
Type of connectable conductor cross-sections		
<ul style="list-style-type: none"> • for main contacts <ul style="list-style-type: none"> — solid — stranded — finely stranded <ul style="list-style-type: none"> — with core end processing • at AWG conductors for main contacts 		2x (2.5 ... 50 mm ²), 1x (2.5 ... 70 mm ²) 2x (2.5 ... 50 mm ²), 1x (2.5 ... 70 mm ²) 2x (2.5 ... 35 mm ²), 1x (2.5 ... 50 mm ²). 2x (10 ... 1/0), 1x (10 ... 2/0)

Certificates/ approvals:

Certificate of suitability		CE / UL / CSA / CCC			
General Product Approval	Declaration of Conformity	Test Certificates		Shipping Approval	
 CSA	 UL	 EG-Konf.	Special Test Certificate	Type Test Certificates/Test Report	 ABS

Shipping Approval				other	
 LRS	 PRS	 RINA	 RMRS	Environmental Confirmations	Confirmation

Railway

[Vibration and Shock](#)

Further information

- Information- and Downloadcenter (Catalogs, Brochures,...)**
<http://www.siemens.com/industrial-controls/catalogs>
- Industry Mall (Online ordering system)**
<http://www.siemens.com/industrymall>
- Cax online generator**
<http://support.automation.siemens.com/WW/CAXorder/default.aspx?lang=en&mlfb=3RV2935-5A>
- Service&Support (Manuals, Certificates, Characteristics, FAQs,...)**
<https://support.industry.siemens.com/cs/ww/en/ps/3RV2935-5A>
- Image database (product images, 2D dimension drawings, 3D models, device circuit diagrams, EPLAN macros, ...)**
http://www.automation.siemens.com/bilddb/cax_de.aspx?mlfb=3RV2935-5A&lang=en

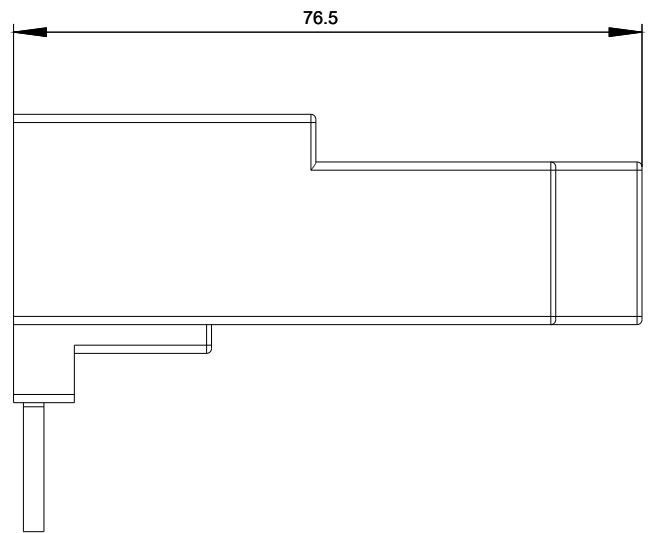
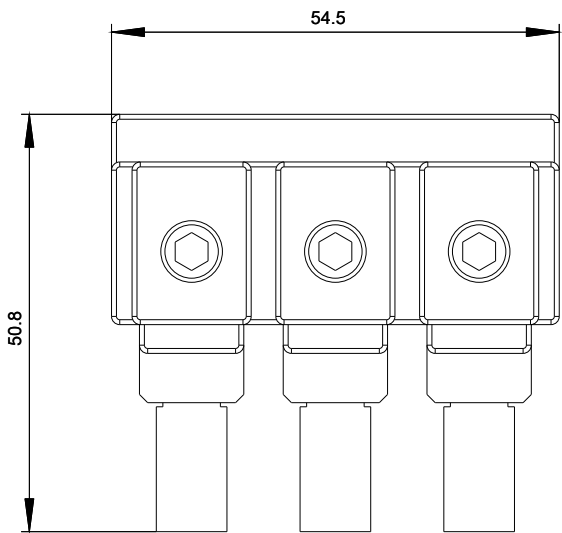

last modified:

06/02/2017