

Panel Mounting Dimension

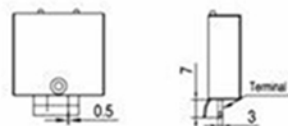
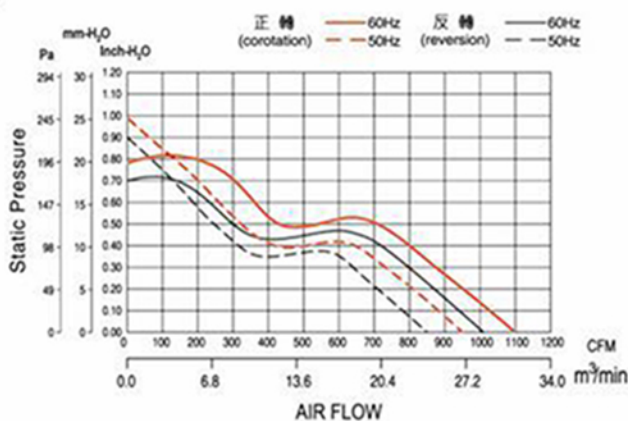
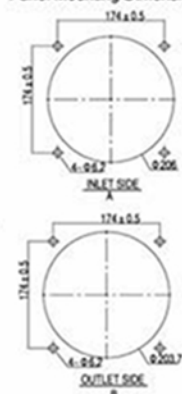

| 型號 Model | Part No. Terminal Leadwire | 軸承類別 Bearing System | 電壓 Rated Voltage(V) | 頻率 Freq (Hz) | 電流 Current (A) | 功率 Input Power(W) | 轉速 Speed (rpm) | 風量 Air Flow (CFM) | 靜壓 Static Pressure (inch-H ₂ O) | 噪音值 Noise Level(dB-A) | 重量 Weight (g) |
|-------------|----------------------------------|---------------------------|---------------------------|--------------------|----------------------|-------------------------|----------------------|---|---|-----------------------------|---------------------|
| A8228E-12L | A8228E-12L-B05 | Ball | 110/120 | 50/60 | 0.70/0.90 | 85/115 | 2900/3400 | 950/1100 | 0.99/0.78 | 71/74 | 2250 |
| | A8228E-12L-B0C | Ball | 110/120 | 50/60 | 0.70/0.90 | 85/115 | 2900/3400 | 950/1100 850/1010 正轉 (corotation) 反轉 (reversion) | 0.99/0.78 0.90/0.70 正轉 (corotation) 反轉 (reversion) | 71/74 | 2250 |
| | A8228E-12L-B0A | Ball | 110/120 | 50/60 | 0.70/0.90 | 85/115 | 2900/3400 | 950/1100 | 0.99/0.78 | 71/74 | 2250 |
| A8228E-22L | A8228E-22L-B05 | Ball | 220/240 | 50/60 | 0.38/0.50 | 85/115 | 2900/3400 | 950/1100 | 0.99/0.78 | 71/74 | 2250 |
| | A8228E-22L-B0C | Ball | 220/240 | 50/60 | 0.38/0.50 | 85/115 | 2900/3400 | 950/1100 850/1010 正轉 (corotation) 反轉 (reversion) | 0.99/0.78 0.90/0.70 正轉 (corotation) 反轉 (reversion) | 71/74 | 2250 |
| | A8228E-22L-B0A | Ball | 220/240 | 50/60 | 0.38/0.50 | 85/115 | 2900/3400 | 950/1100 | 0.99/0.78 | 71/74 | 2250 |
| A8228E-38L | A8228E-38L-B05 | Ball | 380/400 | 50/60 | 0.18/0.18 | 85/115 | 2900/3400 | 950/1100 | 0.99/0.78 | 71/74 | 2250 |
| | A8228E-38L-B0A | Ball | 380/400 | 50/60 | 0.18/0.18 | 85/115 | 2900/3400 | 950/1100 | 0.99/0.78 | 71/74 | 2250 |

說明: 1. 表中 (1) 代表單相, (3) 代表三相

2. 表中 (C) 代表正反轉功能 (此機型為引線式, 線長310mm, 採用符合UL1332#, 24AWG, 200°C之黑色線, 引線為三線式 * (1)(2)(3) 正轉 (1)(2) 反轉)

3. 表中 (A) 代表報警功能 (a. 報警功能採用無源觸點式 b. 此機型為端子式, 報警信號線長310mm, 採用符合UL1332#, 24AWG, 200°C之黃色線)

Note: 1. (1) represent single-phase, (3) represent triphase in the form.

2. (C) represent the function of corotation and rollback (this fan is lead wire style, adopting 3 black wires with each of the length 310mm which meet UL 1332#, 24AWG, 200°C standard * (1)(2)(3) corotation (1)(2) reversion) in the form.

3. (A) represent the function of fan with warning signal output (a. This warning function adopt passive adherent point type; b. This fan is terminal type, warning signal output adopting yellow wire with the length 310mm which meet UL 1332#, 24AWG, 200°C standard) in the form.