

# Dia.84x37mm / 3.3inch

## 33~14 CFM

Plastic Impeller



	额定电压	电压范围	频率	输入功率	参考转速	最大风量		最大风压	噪音	PQ
Model No	VAC	VAC	Hz	Watt	RPM	CFM	m3/min	Inch/H2O	mm	db(A)
SBK800AN-11-1	115	100~120	50/60	20/18	2550/2800	29/33	0.8/0.9	0.42/0.50	10.67/12.7	48
SBK800AN-11-2	115	100~120	50/60	14/12	2300/2150	25/23	0.7/0.7	0.35/0.33	8.89/8.38	39
SBK800AN-11-3	115	100~120	50/60	11/9	1500/1650	11/13	0.3/0.4	0.18/0.19	4.57/4.83	28
SBK800AN-22-1	230	200~240	50/60	20/18	2550/2800	29/33	0.8/0.9	0.42/0.50	10.67/12.7	47
SBK800AN-22-2	230	200~240	50/60	14/12	2300/2150	25/23	0.7/0.7	0.35/0.33	8.89/8.38	39
SBK800AN-22-3	230	200~240	50/60	11/9	1500/1650	11/13	0.3/0.4	0.18/0.19	4.57/4.83	28
SBK800AN-11/22-1	115	100~120	50/60	20/18	2550/2800	29/33	0.8/0.9	0.42/0.50	10.67/12.7	48
dual voltage	230	200~240								

- The stated airflow, air pressure, noise levels are measured with housing orifice dia.: impeller  $\Phi +1\sim 1.5\text{mm}$ , at distance: approx. height of impeller + motor frame. The optimal operating data can only be depended on the installation conditions.
- \*\* = "WB" for wire lead type Ball bearing, or "TB" for terminal type Ball bearing
- 100, 200, 240V 或特殊电压 12, 24, 28, 38, 42, 48, 380, 440, 480V... 50/60Hz, 任何电压都可订做。
- 双速 高/中 1速/2速, 中/低 2速/3速 可依需求制造。
- 信湾保留修改资料与改良电子&机械设计的权利, 无须告知。资料公差  $\pm 10\%$

### Motor

马达类别: Shaded pole induction

马达防护:

IP 防护: IP44

### Mechanical

外框: Natural aluminum color sanded &amp; milled cosmetics

叶轮: Glass fiber reinforced PBT thermoplastic impeller, UL94V-0

轴承: Two ball bearings

旋转方向: CW seen on rotor

接头: Wire lead

重量: 320Gm (0.71 Lb)

### Electronical

绝缘强度: Over 1 min.at 1,500 VAC, 0.5mA, 50/60 Hz

绝缘电阻: Over 100 M $\Omega$  at DC 500V

讯号输出: -

### Environment

使用温度: Ambient non-condensing -20~+80C

保存温度: -40C~+100C (at 65%RH)

平均预期寿命: 55K hours at 45°C, 25K hours at 65°C based on life test Formula L10

### ► Performance P-Q Curves



Nomenclature



Dual Voltage



Multiple Speed

### ► Outline Dimensions

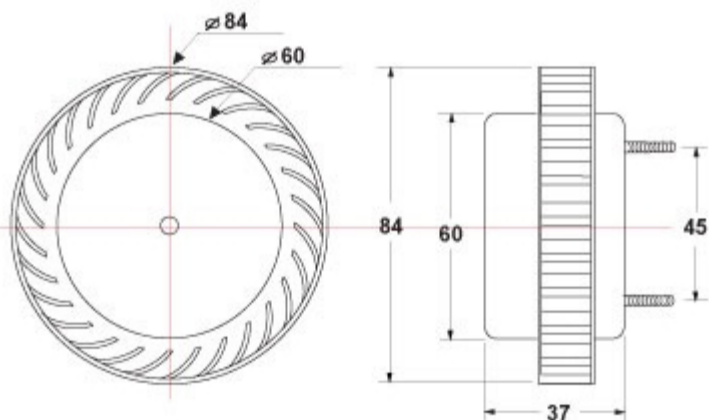

Mounting Screw x 2  
M3.5 x 0.6P  
L= 10+/-2mm

\* Screw Length can be  
to meet customer requirement.

相關產品

