

# RLE 20-0538-EC

## Technical Data in Class 2 according to DIN 24166

RLE 20-	Voltage V	Phases	Frequency Hz	Speed 1/min	Max. power consumption kW	Nominal current A	$L_{WA6}$ at $q_{Vopt}$ dB	Motor protec- tion class	Motor thermal class	Media Temperature max. °C	Impeller weight kg
0538-EC-01-26	230	1~	50/60	1140	0,9	4	77	IP44	F	40	32

Stepless speed controllable via electronic Commutation Unit.  
The fans must be used with the Electronic Commutation Unit EKE 05.

Performance curves and sound data are valid only for the motor impeller in connection with our inlet cone!

Sound level for inlet side  $L_{WA5} = L_{WA6} - 3$  dB.

## Curves in Class 2 according to DIN 24166

$\rho_1 = 1.15 \text{ kg/m}^3$

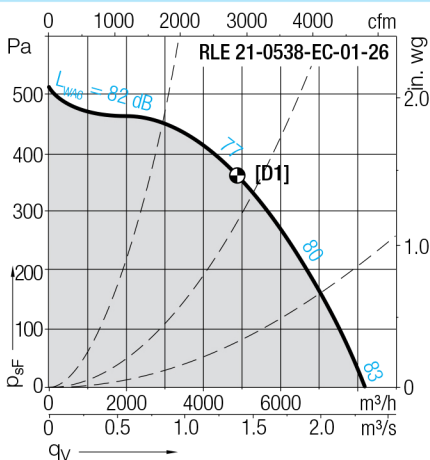

## Dimensions in mm, Subject to change.

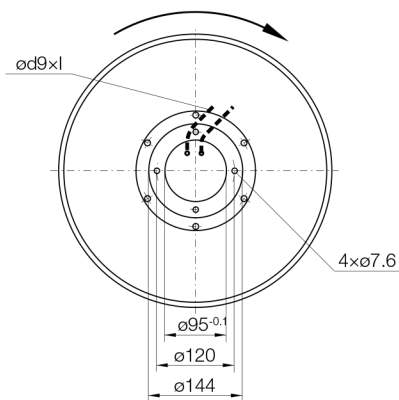
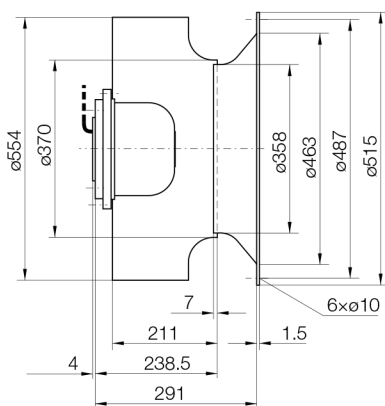

### Connection cable:

RLE 20-  $\varnothing 9 \times 1$

0538-EC-01-26  $\varnothing 7.2 \times 800$

### Clockwise rotation RD

### Reverb sensor cable:

RLE 20-  $\varnothing 9 \times 1$

0538-EC-01-26  $\varnothing 6.8 \times 800$

Duty Point		Relative sound power level for discharge side $L_{Wrel6}$								Relative sound power level for inlet side $L_{Wrel5}$									
1/min	$q_{Vmax}$	63	125	250	500	1000	2000	4000	8000	Hz	63	125	250	500	1000	2000	4000	8000	Hz
450...900	0.3 $q_{Vmax}$	+7	+2	-3	-4	-5	-7	-12	-19	dB	+10	+5	0	-2	-6	-10	-13	-21	dB
450...900	0.6 $q_{Vmax}$	+1	-3	-3	-4	-5	-7	-13	-19	dB	+6	+2	0	-2	-6	-10	-13	-22	dB
450...900	1.0 $q_{Vmax}$	-1	-3	-4	-4	-5	-7	-12	-20	dB	+3	+2	0	-1	-6	-11	-14	-22	dB
901...1140	0.3 $q_{Vmax}$	+6	+2	-1	-5	-6	-7	-11	-17	dB	+8	+6	+1	-2	-7	-11	-13	-18	dB
901...1140	0.6 $q_{Vmax}$	-2	-3	-4	-4	-5	-7	-11	-16	dB	+3	+3	+1	-2	-7	-10	-12	-17	dB
901...1140	1.0 $q_{Vmax}$	-6	-4	-4	-4	-5	-7	-11	-17	dB	-4	+1	+1	-2	-7	-9	-12	-17	dB

## Components

RLE 20-	Inlet Cone ZKD	Electronic Commutation Unit EKE
0538-EC-01-26		05-0040-5E-IA