

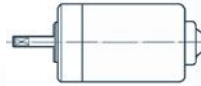

## PLANETARY GEAR

- REDUCTORES PLANETARIOS: combinables con la serie 162. Ver sección especial en catálogo.
- PLANETARY GEARS: combinable with 162 series. See special section in catalogue.
- REDUCTEURS PLANETAIRES: combinables avec la série 162. Consultez section spécial du catalogue.
- PLANETENGETRIEBE: Mit der Reihe 162 kombinierbar. Sehen Sie Sonderabschnitt im Katalog.

A



B

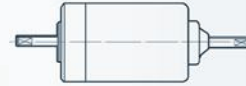

| REFERENCIA<br>REFERENCE NUMBER<br>REFERENZNUMMERN | TENSION NOMINAL<br>NOMINAL VOLTAGE<br>TENSION NOMINALE<br>NENNSPANNUNG | PAR NOMINAL<br>NOMINAL COUPLE<br>COUPLE NOMINAL<br>DREHMOMENT NOMINAL | VELOCIDAD NOMINAL<br>NOMINAL SPEED<br>VITESSE NOMINALE<br>GESCHWINDIGKEIT NOMINAL | CORRIENTE NOMINAL<br>NOMINAL CURRENT<br>COURANT NOMINAL<br>NOMINALSTROM | PAR DE ARRANQUE<br>STARTING TORQUE<br>COUPLE DE DEMARRAGE<br>ANZUGSDREHMOMENT | CORRIENTE DE ARRANQUE<br>STARTING CURRENT<br>COURANT DE DEMARRAGE<br>ANZUGSTROM | EF<br>SHAFT<br>ARBRE<br>WELLE | CONEXIONES<br>CONNECTIONS<br>CONNEXIONS<br>ANSCHLUSSART | ESQUEMA ELÉCTRICO<br>WIRING DIAGRAM<br>SCHEMA ELECTRIQUE<br>SCHALTBILD | PESO APROXIMADO<br>APPROXIMATE WEIGHT<br>POIDS APPROXIMATIF<br>GEWICHT (GR.) | GRADO DE ESTANQUEIDAD<br>WATER TIGHTNESS<br>ÉTANCHÉITÉ<br>FEUCHTIGKEITSSCHUTZKLASSE | DISEÑO A B<br>DESIGN A B<br>DESSIN A B<br>ABBILDUNG A B | CURVA<br>CURVE<br>COURBE<br>KURVE |
|---|--|---|---|---|---|---|-------------------------------|---|--|--|---|---|-----------------------------------|
|   | Un<br>(V)  | Mn<br>(N.m./lbf.in)   | fn<br>(r.p.m.)  | In<br>(A)   | Ma<br>(N.m./lbf.in)   | Ia<br>(A)   |                               |   |  | P<br>(kg/lb.t)   | IP  |   |                                   |
| 162.4101.20.00                                    | 12   | 0.18 / 1.59   | 2800  | 7.5   | 1.0 / 8.85  | 33  | E2                            | C2  | EE2  | 1.1 / 2.95   | IP53  | a   | 32                                |
| 162.4101.30.00                                    | 24   | 0.20 / 1.77   | 3000  | 4   | 1.0 / 8.85  | 18  | E2                            | C2  | EE2  | 1.1 / 2.95   | IP53  | a   | 33                                |
| 162.4102.20.00                                    | 12   | 0.20 / 1.77   | 2000  | 6   | 1.0 / 8.85  | 24  | E2                            | C3  | EE2  | 1.1 / 2.95   | IP53  | a   | 34                                |
| 162.4102.30.00                                    | 24   | 0.20 / 1.77   | 2000  | 3   | 1.0 / 8.85  | 12  | E2                            | C3  | EE2  | 1.1 / 2.95   | IP53  | a   | 34                                |
| 162.4106.20.00                                    | 12   | 0.18 / 1.59   | 2800  | 7.5   | 1.0 / 8.85  | 33  | E4                            | C2  | EE2  | 1.1 / 2.95   | IP53  | a   | 32                                |
| 162.4106.30.00                                    | 24   | 0.20 / 1.77   | 3000  | 4   | 1.0 / 8.85  | 18  | E4                            | C2  | EE2  | 1.1 / 2.95   | IP53  | a   | 33                                |
| 162.4107.30.00E                                   | 24   | 0.20 / 1.77   | 2000  | 3   | 1.0 / 8.85  | 12  | E5                            | C5  | F3   | 1.1 / 2.95   | IP53  | a   | 34                                |
| 162.4108.20.00                                    | 12   | 0.18 / 1.59   | 1500  | 5   | 0.8 / 7.08  | 17  | E2                            | C3  | EE2  | 1.1 / 2.95   | IP53  | a   | 35                                |
| 162.4108.30.00                                    | 24   | 0.18 / 1.59   | 1500  | 2.5   | 0.8 / 7.08  | 8.5   | E2                            | C3  | EE2  | 1.1 / 2.95   | IP53  | a   | 35                                |
| 162.4109.30.00                                    | 24   | 0.18 / 1.59   | 1500  | 2.5   | 0.8 / 7.08  | 8.5   | E38                           | C35   | EE3  | 1.1 / 2.95   | IP53  | a   | 35                                |
| 162.4109.50.00                                    | 48   | 0.18 / 1.59   | 1500  | 1,3   | 0.8 / 7.08  | 4,5   | E38                           | C35   | EE3  | 1.1 / 2.95   | IP53  | a   | 35                                |
| 162.4113.30.00                                    | 24   | 0.12 / 1.06   | 3000  | 2.5   | 1.0 / 8.85  | 15  | E3                            | C4  | F3   | 1.1 / 2.95   | IP40  | a   | 36                                |
| 162.4116.30.00                                    | 24   | 0.20 / 1.77   | 3000  | 4   | 1.0 / 8.85  | 18  | E58/E57                       | C2  | EE2  | 1.1 / 2.95   | IP40  | b   | 33                                |

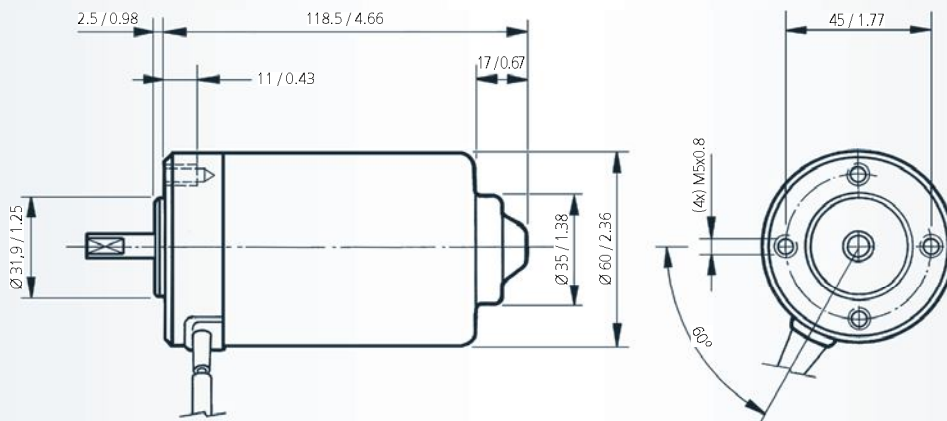

EJE - SHAFT - ARBRE - WELLE

CURVAS - CURVES - COURBES - KURVEN

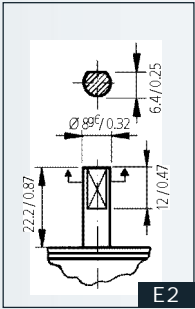

E2

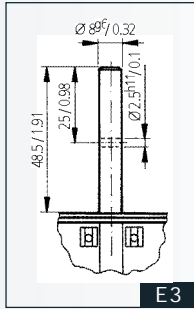

E3

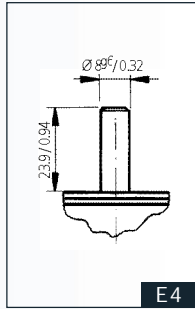

E4

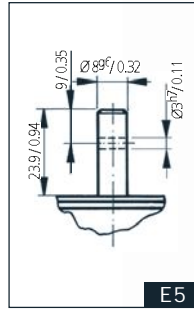

E5

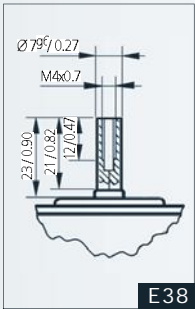

E38

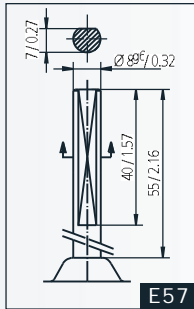

E57

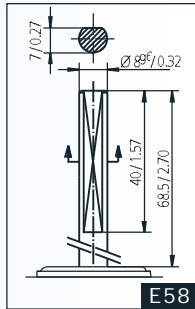

E58

CONEXIONES - CONNECTIONS  
CONNEXIONS - ANSCHLUSSART

ESQUEMA ELÉCTRICO - WIRING DIAGRAM  
SCHEMA ÉLECTRIQUE - SCHALTBILD

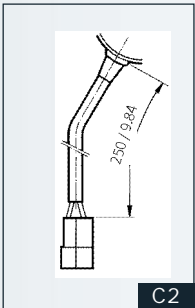

C2

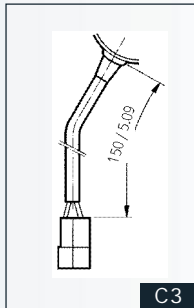

C3

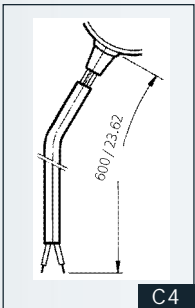

C4

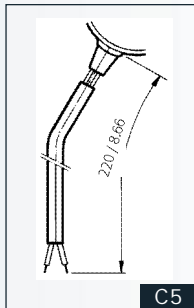

C5

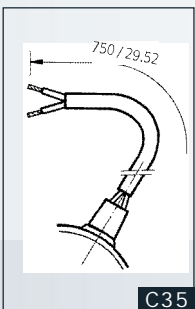

C35

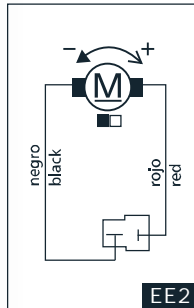

EE2

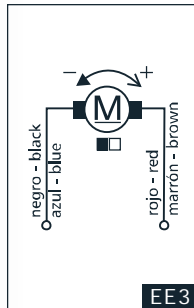

EE3

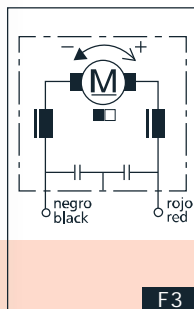

F3

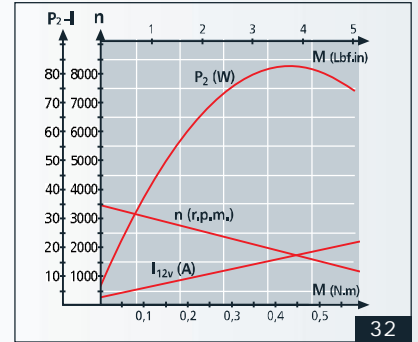

32

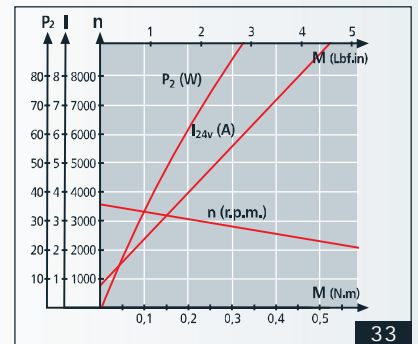

33

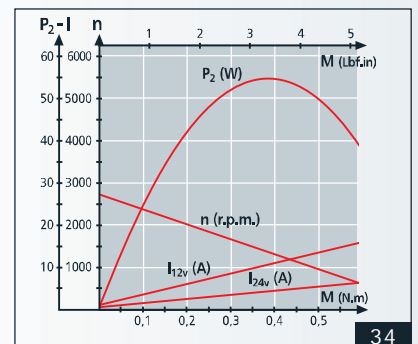

34

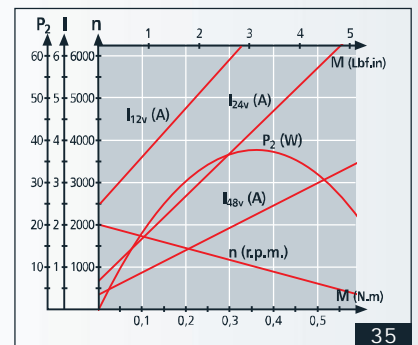

35

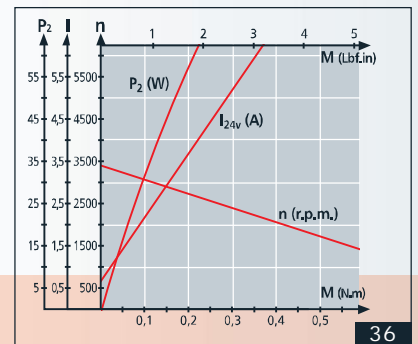

36