



Part Number: ML33G



High power extruded channel heat sink.
For use with TO-220 or TO-218 packages.

Order this part through
an Authorized Distributor
www.aavidthermalloy.com/sales/disty.shtml

Product Information

Part #	Finish	RoHS	PCN
ML33G	Black Anodize	RoHS Compliant	

Mechanical Outline Drawing

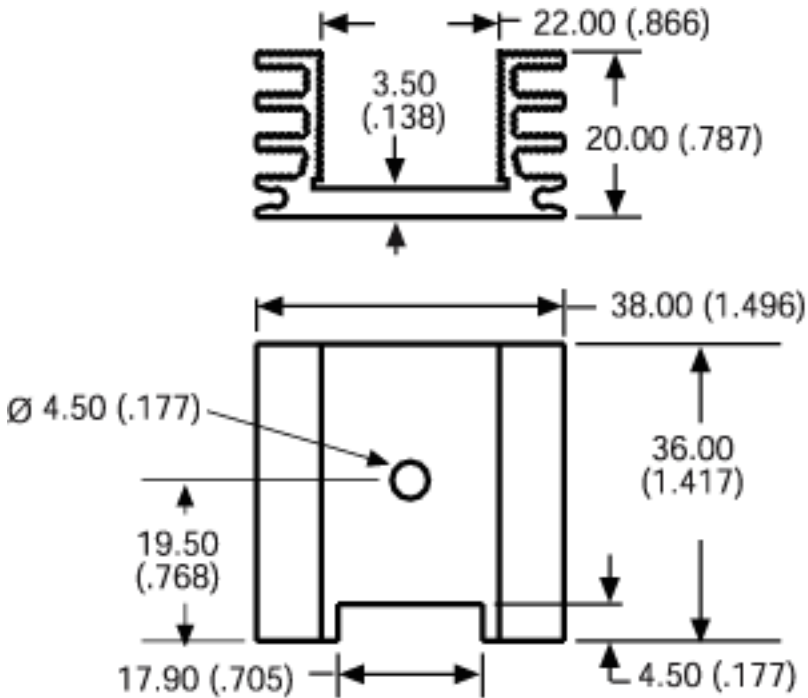

Thermal Curve

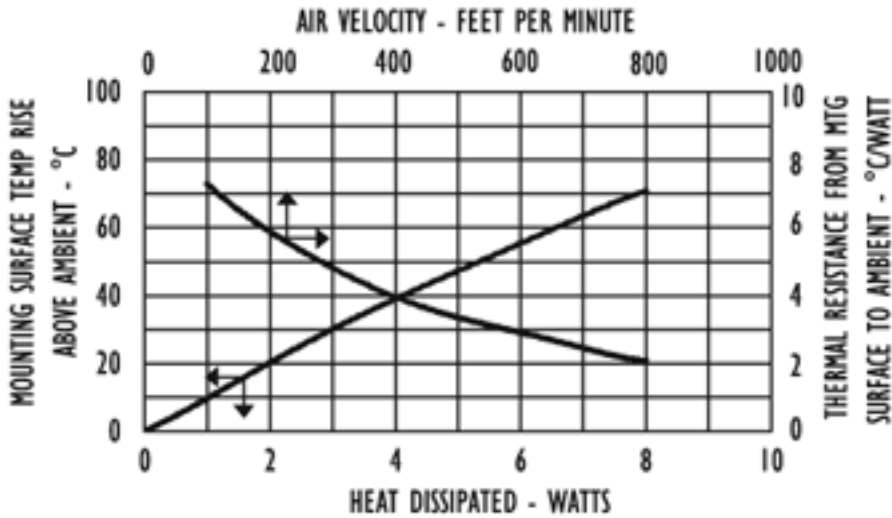

Thermal Resistance	8.50
--------------------	------

Thermal resistance value is based on a 75°C rise in natural convection

Not Exactly what you need?

We offer several options for those applications which require a more unique solution. For slight modifications of this part or other attachment options, finishes, and interface materials, contact your [sales associate](#). Challenge us with your thermal requirements - we can design custom solutions.

For technical help with our Standard Products, please call (603) 224-9988, or contact your Aavid Sales Associate
Email: info@aavid.com

Visit us at www.aavidthermalloy.com • ©2010 Aavid Thermalloy, LLC