

ONE-PIECE CLAMP STYLE THREADED COLLAR ONE-PIECE CLAMP STYLE BEARING LOCKNUTS

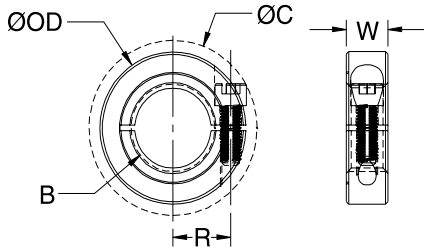

- Does not mar the shaft.
- Single point faced.
- Acme and Left-hand threads available.
- Additional sizes available.
- Width tolerance: $+.003''$
 $-.010''$

PART NUMBER		SPECIFICATIONS					
BLACK OXIDE STEEL	STAINLESS STEEL	BORE B	OUTER DIAM. OD (in)	SCREW LOCATION R (in)	CLEARANCE DIAM. C (in) MAX	WIDTH W (in)	FORGED CLAMP SCREW
TCL-2-32-F	TCL-2-32-SS	#8-32	5/8	0.210	0.773	0.281	#4-40
TCL-3-32-F	TCL-3-32-SS	#10-32	5/8	0.210	0.773	0.281	#4-40
TCL-4-20-F	TCL-4-20-SS	1/4-20	5/8	0.210	0.773	0.281	#4-40
TCL-4-28-F	TCL-4-28-SS	1/4-28	5/8	0.210	0.773	0.281	#4-40
TCL-5-18-F	TCL-5-18-SS	5/16-18	11/16	0.250	0.838	0.281	#4-40
TCL-5-24-F	TCL-5-24-SS	5/16-24	11/16	0.250	0.838	0.281	#4-40
TCL-6-16-F	TCL-6-16-SS	3/8-16	7/8	0.313	1.027	0.343	#6-32
TCL-6-24-F	TCL-6-24-SS	3/8-24	7/8	0.313	1.027	0.343	#6-32
TCL-7-14-F	TCL-7-14-SS	7/16-14	15/16	0.344	1.080	0.343	#6-32
TCL-7-20-F	TCL-7-20-SS	7/16-20	15/16	0.344	1.080	0.343	#6-32
TCL-8-13-F	TCL-8-13-SS	1/2-13	1-1/8	0.406	1.281	0.406	#8-32
TCL-8-20-F	TCL-8-20-SS	1/2-20	1-1/8	0.406	1.281	0.406	#8-32
TCL-10-11-F	TCL-10-11-SS	5/8-11	1-5/16	0.479	1.500	0.437	#10-32
TCL-10-18-F	TCL-10-18-SS	5/8-18	1-5/16	0.479	1.500	0.437	#10-32
TCL-12-10-F	TCL-12-10-SS	3/4-10	1-1/2	0.545	1.808	0.500	1/4-28
TCL-12-16-F	TCL-12-16-SS	3/4-16	1-1/2	0.545	1.808	0.500	1/4-28
TCL-14-9-F	TCL-14-9-SS	7/8-9	1-5/8	0.610	1.916	0.500	1/4-28
TCL-14-14-F	TCL-14-14-SS	7/8-14	1-5/8	0.610	1.916	0.500	1/4-28
TCL-16-8-F	TCL-16-8-SS	1-8	1-3/4	0.678	2.032	0.500	1/4-28
TCL-16-12-F	TCL-16-12-SS	1-12	1-3/4	0.678	2.032	0.500	1/4-28
TCL-16-14-F	TCL-16-14-SS	1-14	1-3/4	0.678	2.032	0.500	1/4-28
TCL-18-12-F	TCL-18-12-SS	1-1/8-12	1-7/8	0.740	2.140	0.500	1/4-28
TCL-20-7-F	TCL-20-7-SS	1-1/4-7	2-1/16	0.828	2.295	0.500	1/4-28
TCL-20-12-F	TCL-20-12-SS	1-1/4-12	2-1/16	0.828	2.295	0.500	1/4-28
TCL-22-12-F	TCL-22-12-SS	1-3/8-12	2-1/4	0.922	2.465	0.563	1/4-28
TCL-24-12-F	TCL-24-12-SS	1-1/2-12	2-3/8	0.984	2.578	0.563	1/4-28
TCL-28-16-F	TCL-28-16-SS	1-3/4-16	2-3/4	1.125	3.046	0.688	5/16-24
TCL-32-12-F	TCL-32-12-SS	2-12	3	1.250	3.273	0.688	5/16-24
TCL-36-12-F	TCL-36-12-SS	2-1/4-12	3-1/4	1.375	3.504	0.750	5/16-24

BLACK OXIDE STEEL	STAINLESS STEEL	BORE B	OUTER DIAM. OD (mm)	SCREW LOCATION R (mm)	CLEARANCE DIAM. C (mm) MAX	WIDTH W (mm)	FORGED CLAMP SCREW
MTCL-4-0.7-F	MTCL-4-0.7-SS	M4x0.7	16	5.5	20.8	9	M3
MTCL-5-0.8-F	MTCL-5-0.8-SS	M5x0.8	16	5.5	20.8	9	M3
MTCL-6-1-F	MTCL-6-1-SS	M6x1	16	5.5	20.8	9	M3
MTCL-8-1.25-F	MTCL-8-1.25-SS	M8x1.25	18	6.5	22.4	9	M3
MTCL-10-1.5-F	MTCL-10-1.5-SS	M10x1.5	24	8.5	26.3	9	M3
MTCL-12-1.75-F	MTCL-12-1.75-SS	M12x1.75	28	10.0	32.0	11	M4
MTCL-16-2-F	MTCL-16-2-SS	M16x2	34	12.5	39.3	13	M5
MTCL-20-2.5-F	MTCL-20-2.5-SS	M20x2.5	40	14.7	47.4	15	M6
MTCL-24-3-F	MTCL-24-3-SS	M24x3	45	29.5	52.1	15	M6
MTCL-30-3.5-F	MTCL-30-3.5-SS	M30x3.5	54	21.5	59.2	15	M6

Note: Sizes TCL-28 through TCL-36 do not have backslot.

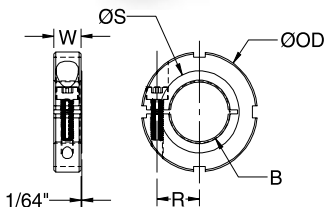

PART NO. STEEL	INDUSTRY STANDARD	LOCKNUT THREADS B	OUTER DIAM. OD (in)	BEARING FACE DIAM. S (in)	SCREW LOC. R (in)	WIDTH W (in)	FORGED CLAMP SCREW
TCN-00-F	-00	0.391-32	15/16	5/8	0.310	0.344	M3
TCN-01-F	-01	0.469-32	1-1/8	23/32	0.380	0.344	M3
TCN-02-F	-02	0.586-32	1-5/16	13/16	0.450	0.375	M4
TCN-03-F	-03	0.664-32	1-1/2	15/16	0.500	0.438	M5
TCN-04-F	-04	0.781-32	1-5/8	1-1/8	0.570	0.438	M5
TCN-05-F	-05	0.969-32	1-7/8	1-9/32	0.680	0.438	M5
TCN-06-F	-06	1.173-18	2	1-1/2	0.770	0.500	M5
TCN-07-F	-07	1.376-18	2-1/4	1-13/16	0.880	0.500	M5
TCN-08-F	-08	1.563-18	2-7/16	2	0.970	0.500	M5

- Does not mar shaft.
- Single point faced.
- Balanced styles available.
- Width tolerance: $+.003''$ / $-.010''$
- Bearing Face Max. TIR: $.0005''$ for 00-06, $.0010''$ for 07-08

FOR ENGINEERING AND WARRANTY INFORMATION SEE WWW.RULAND.COM