

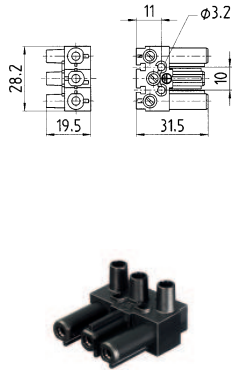

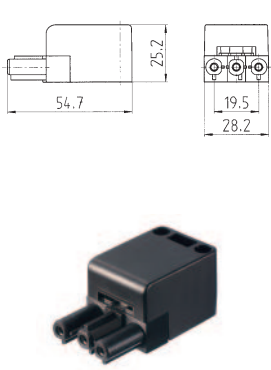

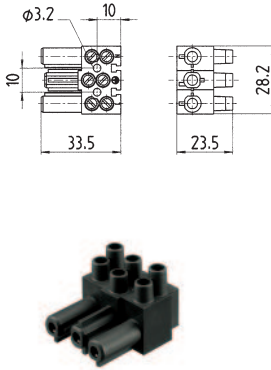



GST 18i 3 pole 250 V, 16 A

| | | | Screw connection | | Screw connection | | Screw connection, double | |
|-------------------------|--------|---|--|--|---|--|---|---------|
| | | | without strain relief for 0.5 – 2.5 mm ² cables single core, finely stranded, lockable** screws into housing*) | | For cross sections of 1.5 – 2.5 mm ² , single core, finely stranded, one connection per pole full assembled with strain relief , for H05VV, NYM ¹⁾ cables (∅ 8.3 – 11.3 mm), lockable** Caution: A connection point is lost when this screw component is inserted into the distribution block. Sheath strip length: 35 mm Insulation strip length: 7 mm | | without strain relief For 0.5 – 2.5 mm ² cables, 2 connections per pole, single core and finely stranded, screws into housing*) | |
| Application | Coding | Colour | Part No. | Box Qty | Part No. | Box Qty | Part No. | Box Qty |
| Female connector | | |  | |  | |  | |
| Mains with earth | Code 1 |  | black white | 92.031.3258.1 200 92.031.3258.0 200 | 99.400.5802.2 100 99.429.5807.6 100 | 92.031.4453.1 200 92.031.4453.0 200 | | |
| | Code 2 |  | pebble grey | 92.031.3458.0 200 | 99.433.5802.2 100 | | | |
| | Code 3 |  | light red | 92.031.3658.0 200 | 99.434.5802.2 100 | | | |
| Switching applications | Code 4 |  | brown | 92.031.3858.0 200 | 99.436.5802.2 100 | | | |
| Male connector | | |  | |  | | | |
| Type | | | GST 18i3 S B1 | | GST 18i3 S B1 Z | | GST 18i3 S B2 | |
| Application | Coding | Colour | Part No. | Box Qty | Part No. | Box Qty | | |
| Mains with earth | Code 1 |  | black white | 92.032.3358.1 200 92.032.3358.0 200 | 99.403.5802.2 100 99.470.5807.6 100 | | | |
| | Code 2 |  | pebble grey | 92.032.3458.0 200 | 99.437.5802.2 100 | | | |
| | Code 3 |  | light red | 92.032.3658.0 200 | 99.438.5802.2 100 | | | |
| Switching applications | Code 4 |  | brown | 92.032.3858.0 200 | 99.440.5802.2 100 | | | |
| Type | | | GST 18i3 S S1 | | GST 18i3 S S1 Z | | | |

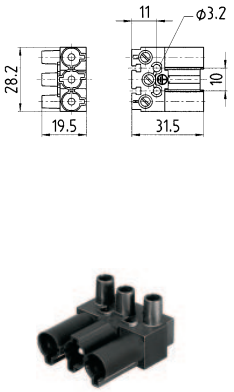
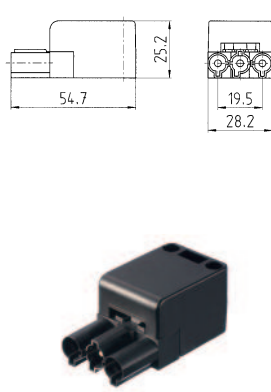
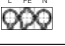
¹⁾ other cable and cable cross-sections available on request



Screw connection

Spring loaded connection

with strain relief

Female connector: suitable for the connection of 2 cables for looping through the main power supply, Complete with locking hoop.
Male connector: suitable for connection of 1 cable as a plug-in complete with locking hook.

For rigid 1.5 – 2.5 mm² cables, finely stranded 1.5 mm² cables with ferrules²⁾, 2 connectors per pole, unassembled **with strain relief**, for H05VV, NYM¹⁾ cables (Ø 7.8 – 10.3 mm), lockable**

Sheath strip length: 45 mm
 Insulation strip length 1.5 mm²: 8 mm
 Insulation strip length 2.5 mm²: 9 mm

Part No. Box Qty

Part No. Box Qty

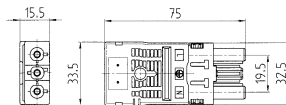
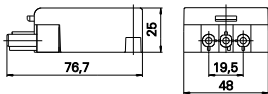

For cross-section of 2.5 mm², single core and finely stranded, **2 connections per pole**, unassembled with strain relief for **2 cables** H05VV, NYM¹⁾ (Ø 9.0 – 11.5 mm).



92.939.1053.1 100

92.933.0053.1 50
 92.933.0053.0 50

92.933.0153.0 50

GST 18i3 S B2 Z

Part No. Box Qty

GST 18i3 F B2 Z

Part No. Box Qty

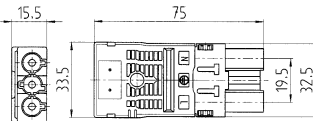
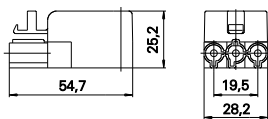

For cross-section of 1.5 mm², single-core and finely stranded, **1 connection per pole**, unassembled with strain relief for H05VV, NYM¹⁾ cables (Ø 6.5 – 8.3 mm).



92.938.0158.1 200

92.934.0053.1 50
 92.934.0053.0 50

92.934.0153.0 50

GST 18i3 S S1 NZR1V

GST 18i3 F S2 Z

¹⁾ other cable and cable cross-sections available on request

¹⁾ other cable and cable cross-sections available on request

²⁾ See "Accessories" for ferrules and clamping tools

- * 1. When striking voltage occurs in a range between 3 and 5 kV, screws made out of insulating material should be used for mounting the connector to prevent flash over.
2. Exposed conductive material that is used for mounting must be earthed.
3. When attaching connector plates, self tapping screws with a maximum diameter of 3 mm may be used.
4. The distance between the fixing holes may not exceed a tolerance of ± 0.1 mm.
5. To avoid damaging the insulating material, self tapping screws may not be screwed into the fixing holes of the connector.

**) VDE 0628 requires the use of a locking device.

GST 18i 3 pole 250 V, 16 A

| | | | Snap-in, Spring-loaded | | Snap-in, Spring-loaded | | Snap-in, screw connection | |
|-------------------------|--------|----------------|--|---------|--|---------|--|---------|
| | | | Material thickness: 0.5 – 1.5 mm Panel mounting ¹⁾ , 2 screwless connections per pole, finely stranded cable 0.5 – 1.5 mm ² with ferrule ²⁾ , rigid cable 0.5 – 2.5 mm ² with locking device Insulation strip length 0.5–1.5 mm ² : 8 mm Insulation strip length 2.5 mm ² : 9 mm | | Material thickness: 1.5 – 2.5 mm Panel mounting ¹⁾ , 2 screwless connections per pole, finely stranded cable 0.5 – 1.5 mm ² with ferrule ²⁾ , rigid cable 0.5 – 2.5 mm ² with locking device Insulation strip length 0.5–1.5 mm ² : 8 mm Insulation strip length 2.5 mm ² : 9 mm | | Material thickness: 0.5 – 1.5 mm Panel mounting ¹⁾ , 1 screw connection per pole, single core and finely stranded cable 0.5 – 2.5 mm ² , with locking device Insulation strip length 0.5–1.5 mm ² : 8 mm Insulation strip length 2.5 mm ² : 9 mm | |
| Application | Coding | Colour | Part No. | Box Qty | Part No. | Box Qty | Part No. | Box Qty |
| Female connector | | | | | | | | |
| Mains with earth | Code 1 | black white | 92.031.9658.1 | 100 | 92.031.7658.1 | 100 | 92.031.8758.1 | 100 |
| | Code 2 | pebble grey | 92.031.9758.0 | 100 | | | 92.031.8758.0 | 100 |
| | Code 3 | light red | 92.031.8558.0 | 100 | | | | |
| Switching applications | Code 4 | brown | 92.031.8458.0 | 100 | | | | |
| Male connector | | | Type GST 18i3 F B2 R | | Type GST 18i3 F B2 REV | | Type GST 18i3S B1 R | |
| | | | Section of housing | | Section of housing | | Section of housing | |
| Mains with earth | Code 1 | black white | 92.032.9658.1 | 100 | 92.032.7658.1 | 100 | 92.032.8758.1 | 100 |
| | Code 2 | pebble grey | 92.032.9758.0 | 100 | 92.032.7658.0 | 100 | 92.032.8758.0 | 100 |
| | Code 3 | light red | 92.032.8558.0 | 100 | | | | |
| Switching applications | Code 4 | brown | 92.032.8458.0 | 100 | | | | |
| Type | | | GST 18i3 F S2 R ¹⁾ Panel material deburring and coating thickness may influence the cut-out dimension. Detailed installation instructions available on request. ²⁾ See "Accessories" for ferrules and crimping tools | | GST 18i3 F S2 REV ¹⁾ Panel material deburring and coating thickness may influence the cut-out dimension. Detailed installation instructions available on request. ²⁾ See "Accessories" for ferrules and crimping tools | | GST 18i3 S S1 R ¹⁾ Panel material deburring and coating thickness may influence the cut-out dimension. Detailed installation instructions available on request. | |

GST 18i3

3 pole mains



Soldered connection, vertical

Can be soldered onto printed circuit board
 – **vertical**
 – with locating cams
 – optional locking device**, fitted

See "Technical Data" for hole template for GST 18 soldered connector

Soldered connection, horizontal

Can be soldered onto a printed circuit board
 – **horizontal**
 – with locating cams
 – optional locking device**, fitted

See "Technical Data" for hole template for GST 18 soldered connector

| Part No. | Box Qty | Part No. | Box Qty |
|----------|---------|----------|---------|
|----------|---------|----------|---------|

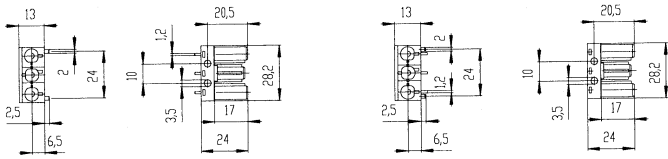

| | | | |
|---------------|-----|---------------|-----|
| 92.031.0058.1 | 100 | 92.033.0058.1 | 100 |
| 92.031.0058.0 | 100 | 92.033.0058.0 | 100 |

| | | | |
|---------------|-----|---------------|-----|
| 92.031.0158.0 | 100 | 92.033.0158.0 | 100 |
|---------------|-----|---------------|-----|

GST 18i3 L B1 V

| Part No. | Box Qty |
|----------|---------|
|----------|---------|

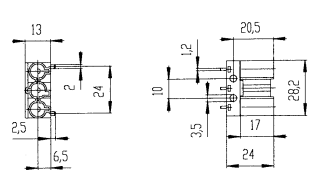

| | |
|---------------|-----|
| 92.032.0058.1 | 100 |
| 92.032.0058.0 | 100 |

| | |
|---------------|-----|
| 92.032.0158.0 | 100 |
|---------------|-----|

GST 18i3 L B1 H

| Part No. | Box Qty |
|----------|---------|
|----------|---------|

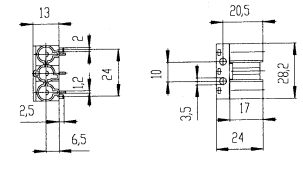

| | |
|---------------|-----|
| 92.034.0058.1 | 100 |
| 92.034.0058.0 | 100 |

| | |
|---------------|-----|
| 92.034.0158.0 | 100 |
|---------------|-----|

GST 18i3 L S1 V

GST 18i3 L S1 H

**) VDE 0628 requires the use of a locking device