

# Separate units: Blocks

IP 20  
To be combined with a 1, 3 or 5 position clip (p. 65)

 Characteristics (p. 94)  
Cross reference list (p. 311)

## ▶ CONTACT BLOCKS

### SCREW TERMINALS

Cat. No.



33E10

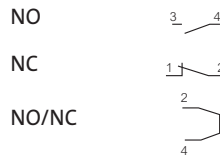
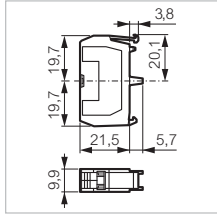

**33E10**

**33E01**

**33E11**

**Golden contacts  
for low current**



33E11

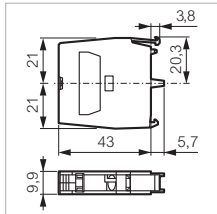

**33E10Y7**

**33E01Y7**

**Contact with delayed opening**



**33E01C**

### FASTON TERMINALS



33D01

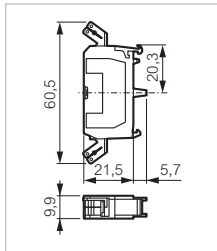

**33D10**

**33D01**

### PLUG-IN TERMINALS



33R01

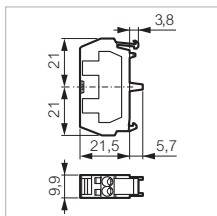

**33R10**

**33R01**