



- Break proof polyamide enclosure for individual fitting of 22.5 mm control switches (lid mounting or base mounting) and pilote lamps
- Execution with 22.5 mm lid holes or without lid holes
- Gland holes M20 / M25 on two sides

#### **Including in delivery:**

Enclosure consisting of lid and base with screws base with M20 and M25 hole for cable entry; mounting possibility of TS 35/7,5 mm DIN rails and adaption plates of several manufacturer

#### **Technical data**

##### **Material:**

Polyamide 6

##### **Ingress protection:**

IP 65, EN 60529

##### **Impact resistance:**

7 Joule, EN 60079-0

##### **Surface resistance:**

$10^{12}$  Ohm, IEC 60093

##### **Flammability:**

V2, UL 94

##### **Farbton:**

Base: RAL 9005, jet black

Top: RAL 7035, light grey

##### **Temperature range:**

-20°C to +60°C

# CS-Box

## Programme range

Order No.	Type	Dimensions (mm)	quantity holes 22.5 in lid
31.10 01 00	CS Box 110-0	110 x 110 x 85	0
31.10 01 01	CS Box 110-1	110 x 110 x 85	1
31.10 02 00	CS Box 160-0	110 x 160 x 85	0
31.10 02 02	CS Box 160-2	110 x 160 x 85	2
31.10 02 03	CS Box 160-3	110 x 160 x 85	3
31.10 03 00	CS Box 230-0	110 x 230 x 85	0
31.10 03 04	CS Box 230-4	110 x 230 x 85	4
31.10 03 05	CS Box 230-5	110 x 230 x 85	5

## Accessories

31.10 99 01	CS Box 110 adapter plate Telemecanique
31.10 99 02	CS Box 160 adapter plate Telemecanique
31.10 99 03	CS Box 230 adapter plate Telemecanique
31.10 99 04	CS Box lid safety strip (set = 2 pcs.)
31.10 99 05	CS Box blind plug set (1 x M25; 1 x M20)
10.06 14 91	DIN rail TS35/7,5 CS Box 110
10.06 14 92	DIN rail TS35/7,5 CS Box 160
10.06 14 93	DIN rail TS35/7,5 CS Box 230

## Terminal mounting

DIN rail TS 15	Phoenix													Earth conductor connections															
	X	X	X																										
DIN rail TS 35				X	X	X	X	X	X	X	X	X	X	X	X														
Voltage (V)	250	400	500	500	800	800	800	800	800	800	1000	1000	1000	1000	1000														
Current (A)	24	32	41	17	24	32	41	57	76	101	150	150	232	309	415														
Nom. cross section (mm <sup>2</sup> )	2.5	2.5	4	1.5	2.5	2.5	4	6	10	16	35	50	95	150	240														
Terminal width (mm)	5.2	5.2	6.2	4.2	5.2	5.2	6.2	8.2	10.2	12.2	15.2	20	25	31	36														
Terminal type																													
Type	MBK 2.5 E	MBK 3 / E-Z	MBK 5 / E-Z	UK 1.5 N	UK 2.5 N	UK 3 N	UK 5 N	UK 6 N	UK 10 N	UK 16 N	UK 35	UKH 50	UKH 95	UKH 150	UKH 240	MSLKG 5 insulated, green/yellow	USLKG 1.5 N insulated green/yellow	USLKG 2.5 N insulated green/yellow	USLKG 6 N insulated green/yellow	USLKG 10 N insulated green/yellow	USLKG 16 N insulated green/yellow	USLKG 3 insulated green/yellow	USLKG 5 insulated green/yellow	USLKG 50 insulated green/yellow	USLKG 95 insulated green/yellow	Earthing bar 2.5 mm <sup>2</sup> with cable lug max. 10 mm <sup>2</sup>	Earthing screw M4 with cable lug max. 6 mm <sup>2</sup>	M6 with cable lug max. 35 mm <sup>2</sup>	
31.10 01 00	14	14	11	17	14	14	11	9	7																				
31.10 01 01	14	14	11	17	14	14	11	9	7																				
31.10 02 00	23	23	20	29	23	23	20	15	12																				
31.10 02 02	23	23	20	29	23	23	20	15	12																				
31.10 02 03	23	23	20	29	23	23	20	15	12																				
31.10 03 00	37	37	31	46	37	37	31	23	19																				
31.10 03 04	37	37	31	46	37	37	31	23	19																				
31.10 03 05	37	37	31	46	37	37	31	23	19																				

Terminal mounting

Weidmüller															Earth conductor connections				
DIN rail TS 15				X	X	X	X												
DIN rail TS 35								X	X	X	X	X	X	X	X	X	X	X	X
Voltage (V)	400	400	400	250	400	250	400	500	800	800	800	1000	1000	1000	1000	1000	1000	1000	
Current (A)	32	32	32	17	17	17	24	32	24	24	32	41	57	76	125	192	232	269	
Nom. cross section (mm <sup>2</sup> )	4	4	4	1.5	1.5	2.5	4	2.5	2.5	2.5	4	6	10	16	35	70	95	120	
Terminal width (mm)	38	52	92	5.1	3.5	5.1	6.1	5.1	5.1	6.1	8.1	10	12	16	20.5	27	27	32	
Terminal type																			
Type	BK 4 (4-pole)	BK 6 (6-pole)	BK 12 (12-pole)	AKZ 1.5	WDU 1.5 / R 3.5	AKZ 2.5	AKZ 4	WDU 2.5 N	WDU 2.5	WDU 4	WDU 6	WDU 10	WDU 16	WDU 35	WDU 70 N	WDU 70 / 95	WDU 95 / 120 N	WDU 120 / 150	WDU 240
31.10 01 00				14	17	14	11	14	14	11	9	7							
31.10 01 01				14	17	14	11	14	14	11	9	7							as required
31.10 02 00				23	29	23	20	23	23	20	15	12							
31.10 02 02				23	29	23	20	23	23	20	15	12							
31.10 02 03				23	29	23	20	23	23	20	15	12							
31.10 03 00				37	46	37	31	37	37	31	23	19							
31.10 03 04				37	46	37	31	37	37	31	23	19							
31.10 03 05				37	46	37	31	37	37	31	23	19							

Type: **31.10 01 00**

External dimensions: **110 x 110 x 85 mm**

Weight: **250 g**

DIN rail length in mm	max. fitting length in mm	Mounting plate (thickness in mm)	External mounting brackets	Lid safety strip	EMC version	Allen lid screws	Silicone lid seal	Sealable lid screws
TS 35								
100	72			•	•		•	

Maximum number of cable glands to <i>DIN 50262*</i>									
M	Corner dim.	Side			PG	Corner dim.	Side		
		A	B	C			A	B	C
12	17,25	20	1	7	17,25	20	1		
16	25,30	8	1	9	21,85	15	1		
20	27,60	7	1	11	25,30	8	1		
25	37,95	4	1	13,5	27,60	7	1		
32	48,30				31,05	6	1		
40	60,95				37,95	4			
50	69,00				48,30				
63	74,75				60,95				
					69,00				
					74,75				

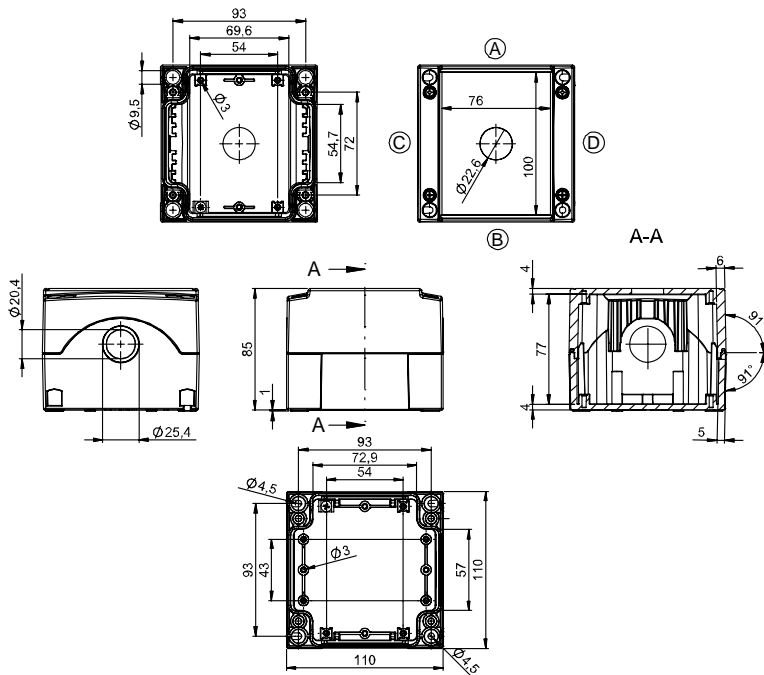

Type: **31.10 02 00**

External dimensions: **110 x 160 x 85 mm**

Weight: **350 g**

DIN rail length in mm	max fitting length in mm	Mounting plate (thickness in mm)	External mounting brackets	Lid safety strip	EMC version	Allen lid screws	Silicone lid seal	Sealable lid screws
TS 35								
150	122			•	•		•	

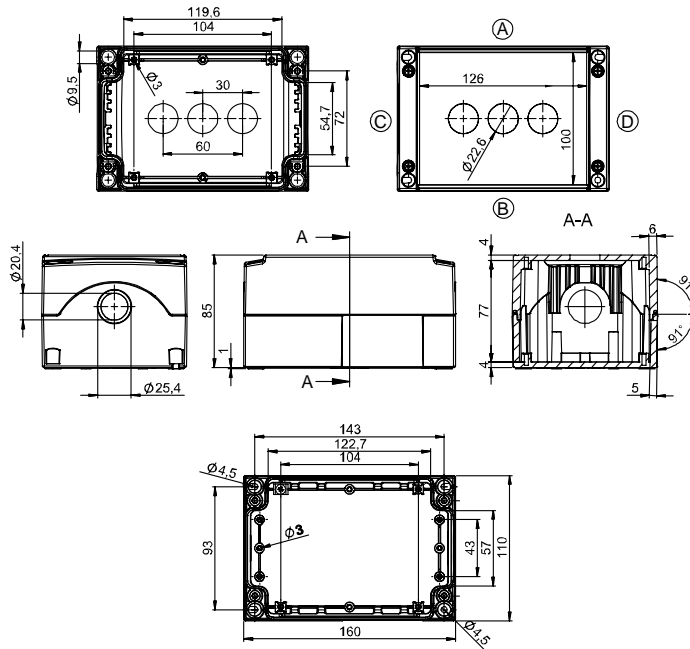

Maximum number of cable glands to **DIN 50262\***

M	Corner dim.	Side		PG	Corner dim.	Side	
		A/B	C/D			A/B	C/D
12	17,25	28	1	7	17,25	27	1
16	25,30	12	1	9	21,85	18	1
20	27,60	12	1	11	25,30	12	1
25	37,95	5	1	13,5	27,60	12	1
32	48,30	3	1	16	31,05	10	1
40	60,95			21	37,95	5	1
50	69,00			29	48,30	3	
63	74,75			36	60,95		
				42	69,00		
				48	74,75		

Type: **31.10 03 00**

External dimensions: **110 x 230 x 85 mm**

Weight: **440 g**

DIN rail length in mm	max fitting length in mm	Mounting plate (thickness in mm)	External mounting brackets	Lid safety strip	EMC version	Allen lid screws	Silicone lid seal	Sealable lid screws
TS 35								
220	192			•	•		•	

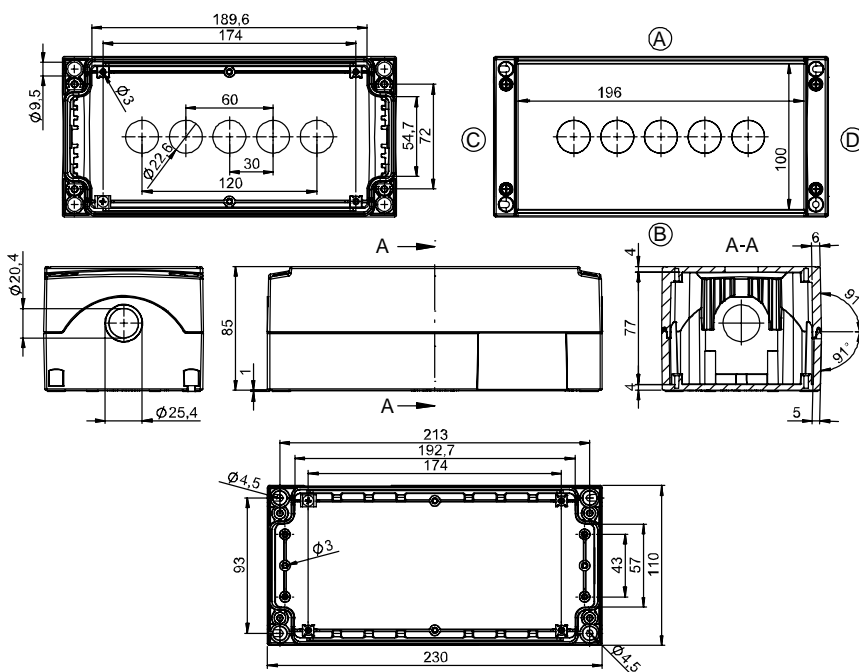

Maximum number of cable glands to **DIN 50262\***

M	Corner dim.	Side		PG	Corner dim.	Side	
		A/B	C/D			A/B	C/D
12	17,25	20	1	7	17,25	20	1
16	25,30	8	1	9	21,85	15	1
20	27,60	7	1	11	25,30	8	1
25	37,95	4	1	13,5	27,60	7	1
32	48,30			16	31,05	6	1
40	60,95			21	37,95	4	
50	69,00			29	48,30		
63	74,75			36	60,95		
				42	69,00		
				48	74,75		