

LOC	DIST	REV	DATE	BY	CHK	APPV
ES	00	A3	09MAY2011	RK	HMR	

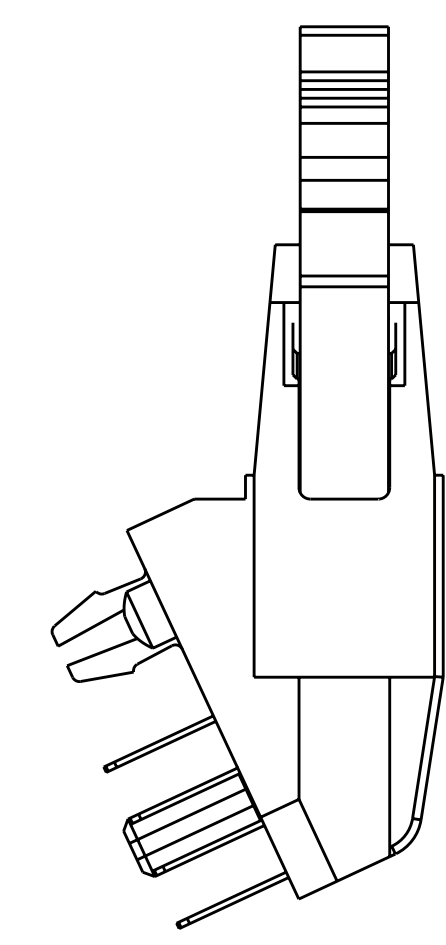

TAIL LENGTHS

- 2.67±0.25 FOR 1.60 (.063") THK PCB
- 3.18±0.25 FOR 2.36 (.093") THK PCB
- 4.00±0.25 FOR 3.18 (.125") THK PCB

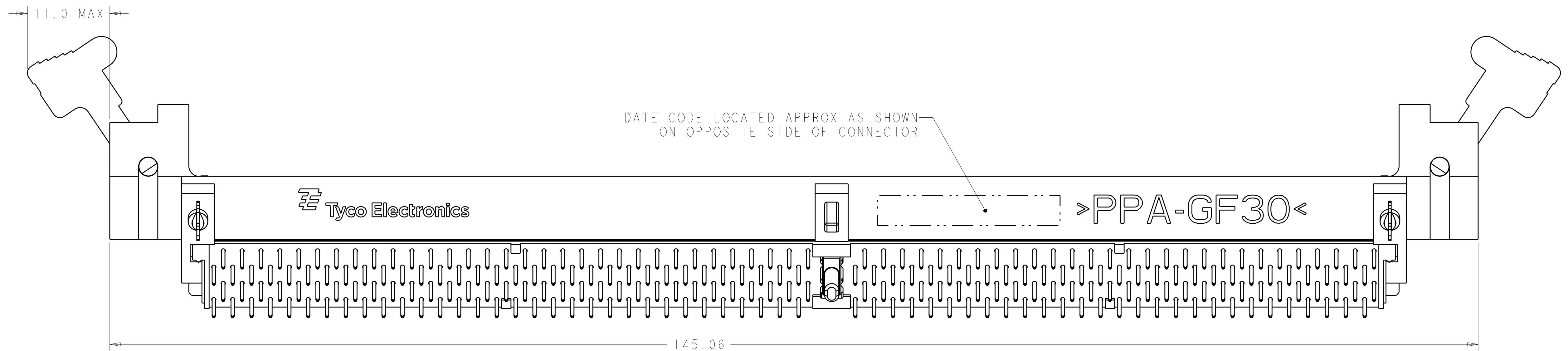
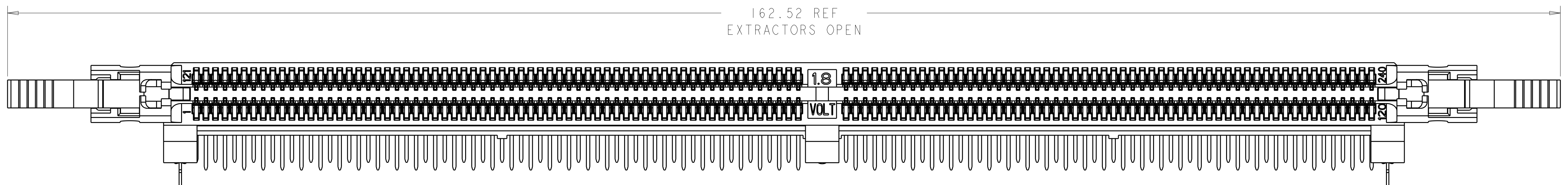
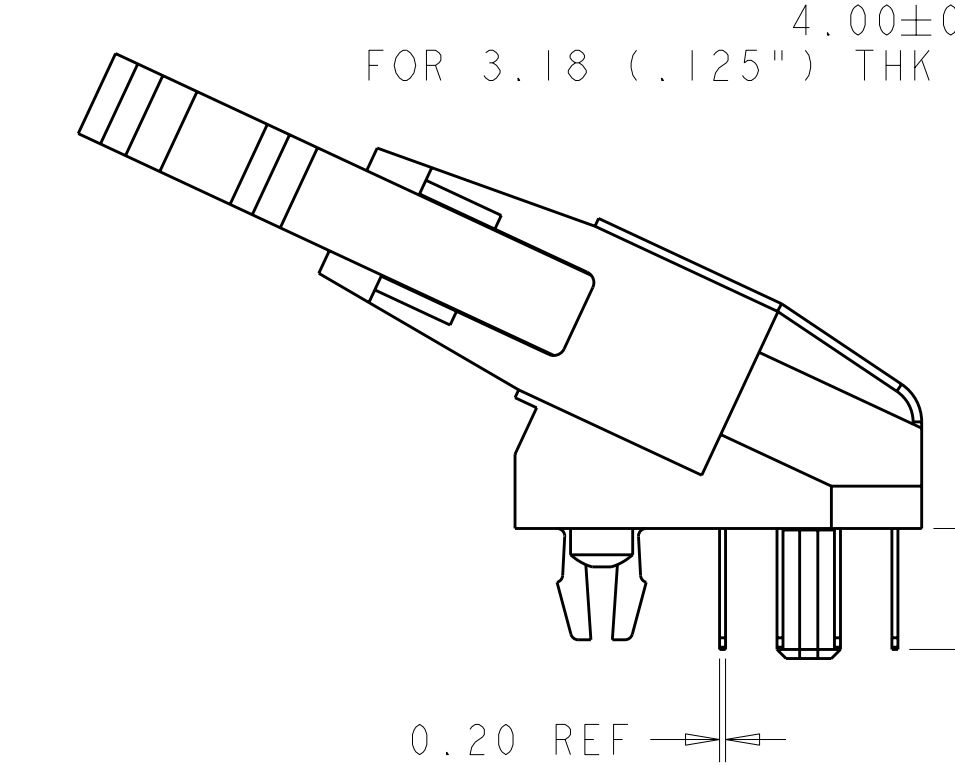
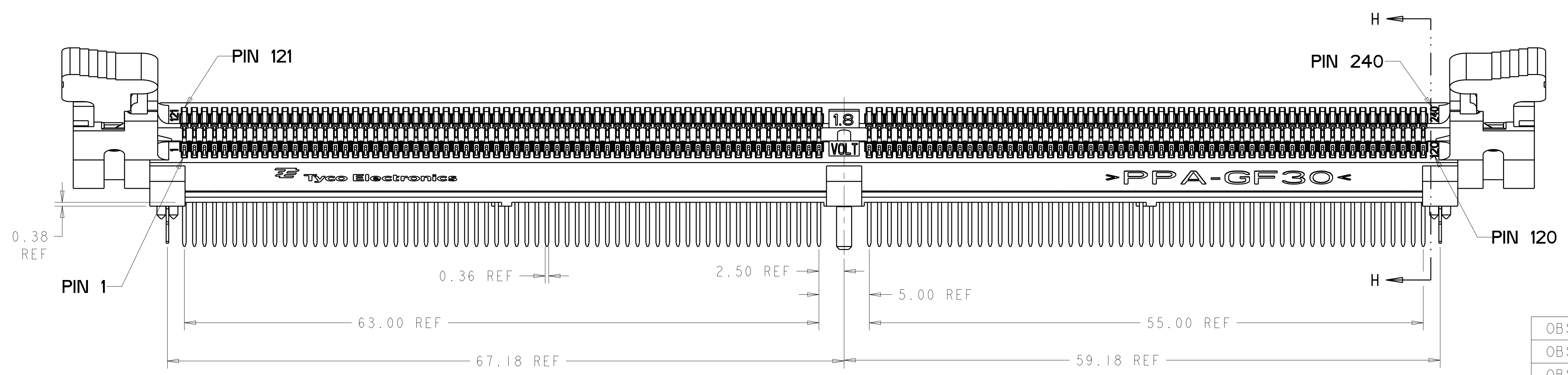

- 1 MATERIALS:
HOUSING: HIGH TEMPERATURE THERMOPLASTIC, BLACK, UL94 V-0
EXTRACTOR: HIGH TEMPERATURE THERMOPLASTIC, NATURAL (OFF WHITE)
CONTACTS: COPPER ALLOY
RETENTION BARB: COPPER ALLOY
- 2 INTERFACE FINISH:
0.00076 MIN THK GOLD OVER 0.00127 MIN THK NICKEL.
0.00038 MIN THK GOLD OVER 0.00127 MIN THK NICKEL.
- 3 SOLDER TAIL FINISH:
0.00300 MIN THK MATTE LEAD FREE PLATING OVER 0.00127 MIN THK NICKEL.
- 4 RIGHT HOLE IS GLOBAL D-E ORIGIN FOR ALL POSITIONAL TOLERANCES.
LEFT AND RIGHT NON-PLATED THRU HOLES ESTABLISH [-E-].
- 5 FINISHED HOLE SIZE. Ø0.15 MAXIMUM ANNULAR RING.

- 6 DATUM [-F-] IS CONNECTOR SIDE SURFACE OF PCB.
- 7 PORE BLOCKER APPLIED TO CONTACT INTERFACE

OBSELETE	MIN	MAX	PART NUMBER
0.00008	MIN	4.00	1658912-9
0.00008	MIN	3.18	1658912-8
0.00008	MIN	2.67	1658912-7
0.00038	MIN	4.00	1658912-6
0.00038	MIN	3.18	1658-12-5
0.00038	MIN	2.67	1658912-4
0.00076	MIN	4.00	1658912-3
0.00076	MIN	3.18	1658912-2
0.00076	MIN	2.67	1658912-1
CONTACT GOLD INTERFACE		TAIL LENGTH	PART NUMBER

THIS DRAWING IS A CONTROLLED DOCUMENT.

DMN: D. RINGLER 28OCT2003
CHK: J. McCLELLAN 29OCT2003
APPV: J. McCLELLAN 29OCT2003

TE Connectivity

SOCKET ASSEMBLY
25 DEGREE DDR 11 DIMM
240 POSITION, STANDARD FOOTPRINT

108-2168
114-13130

A100779C=1658912

SCALE: 1:1 SHEET 1 OF 3 REV: A3

LOC	DIST	REV	DESCRIPTION	DATE	BY	APPD
ES	00		SEE SHEET 1			

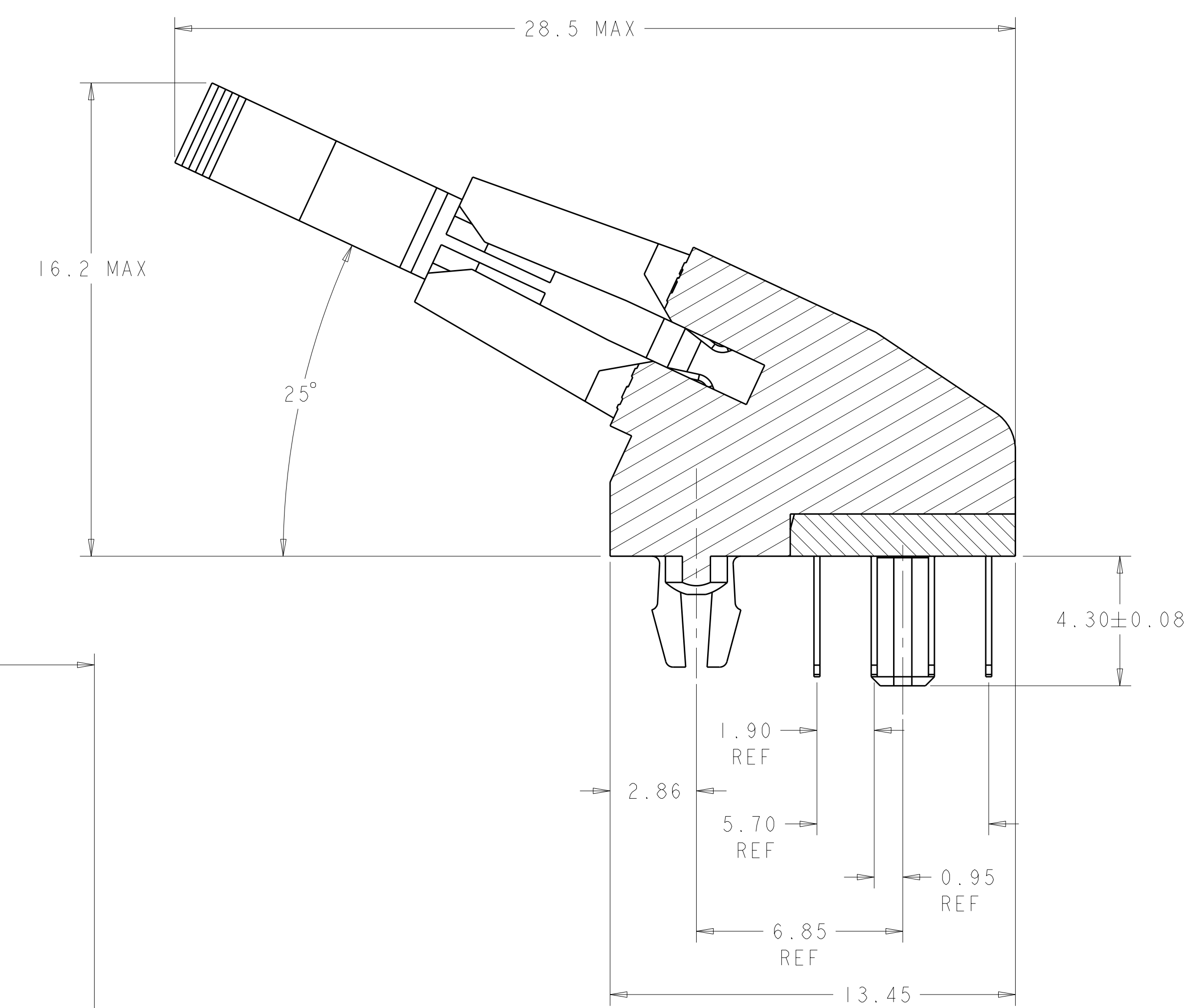
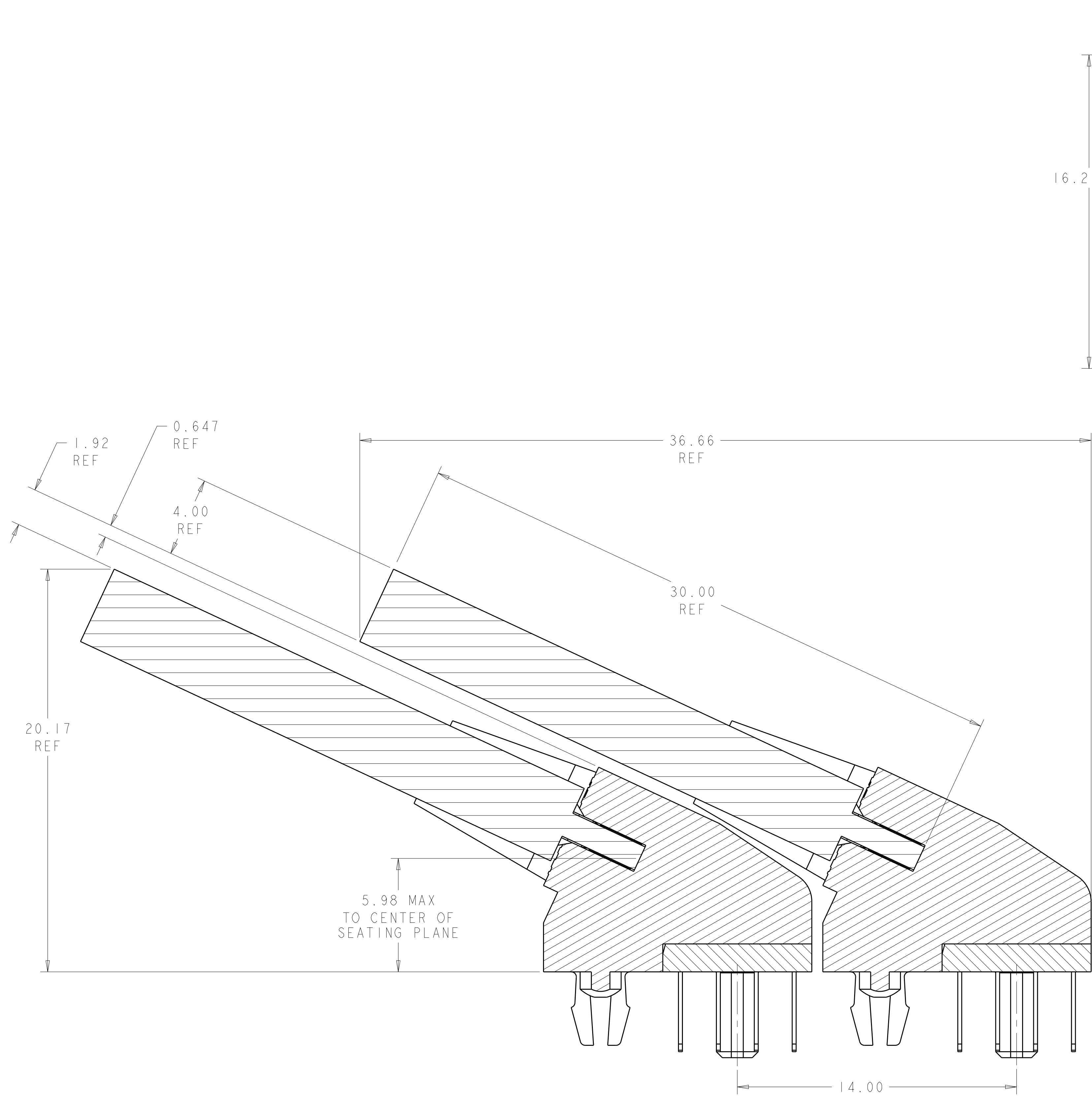

SECTION H-H
SCALE 8:1

MINIMUM RECOMMENDED ROW TO ROW SPACING FOR 4mm THICK MODULE

SCALE 8:1

THIS DRAWING IS A CONTROLLED DOCUMENT.		DWN D. RINGLER 28OCT2003	 TE Connectivity
DIMENSIONS:		CHK J. McCLELLAN 29OCT2003	
mm	TOLERANCES UNLESS OTHERWISE SPECIFIED:	APVD J. McCLELLAN 29OCT2003	NAME SOCKET ASSEMBLY
	0 PLC ± 1 PLC ±0.25 2 PLC ±0.15 3 PLC ±0.013 4 PLC ± ANGLES ±°	PRODUCT SPEC 108-2168	25 DEGREE DDR 11 DIMM
MATERIAL	FINISH	APPLICATION SPEC 114-13130	240 POSITION, STANDARD FOOTPRINT
		WEIGHT	SIZE CAGE CODE DRAWING NO A100779C=1658912
		CUSTOMER DRAWING	RESTRICTED TO SCALE 1:1 SHEET 2 OF 3 REV A3

LOC	DIST	REV	DATE	BY	APPD
ES	00				

REVISIONS		DATE	BY	APPD
-	SEE SHEET 1	-	-	-

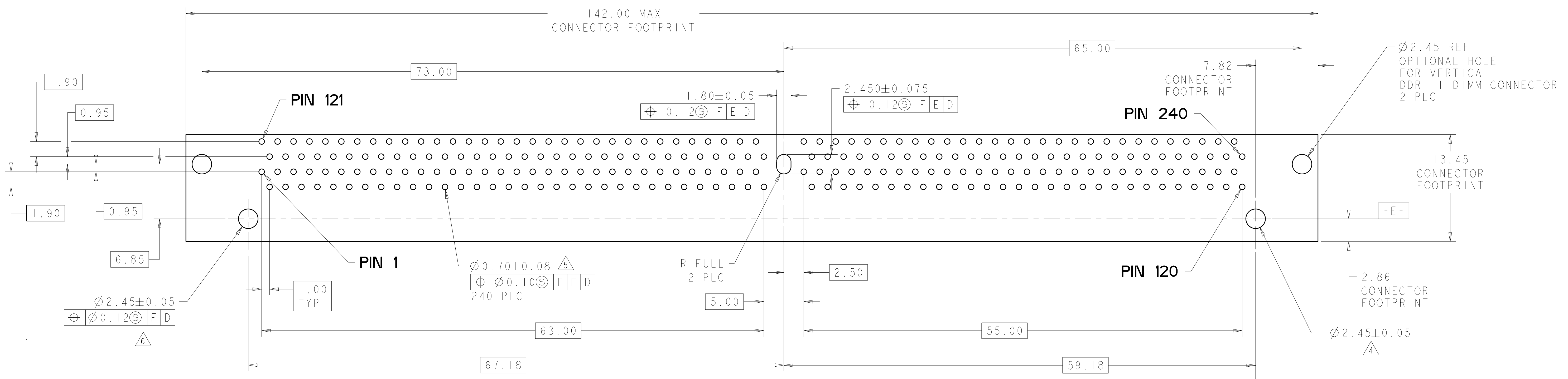

RECOMMENDED PCB HOLE LAYOUT Δ
VIEWED FROM CONNECTOR SIDE
SCALE 4:1

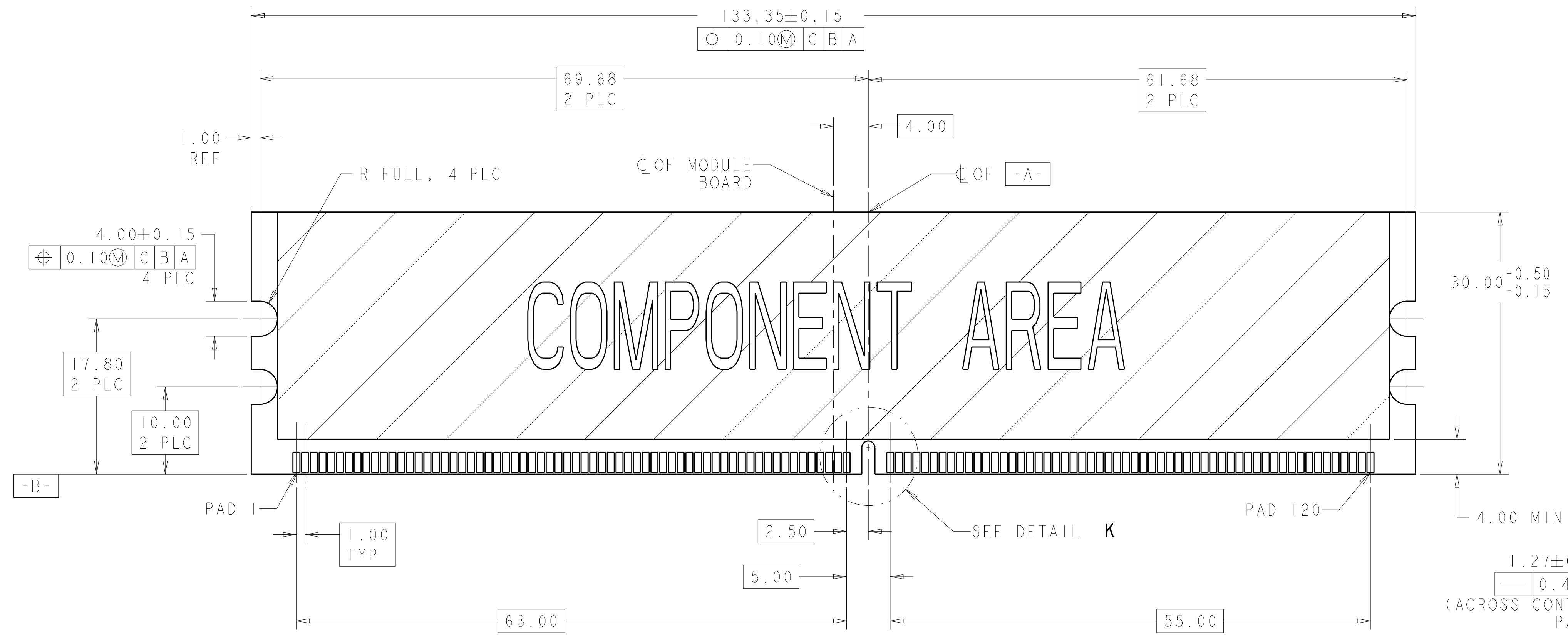

RECOMMENDED MODULE LAYOUT
SCALE 3:1

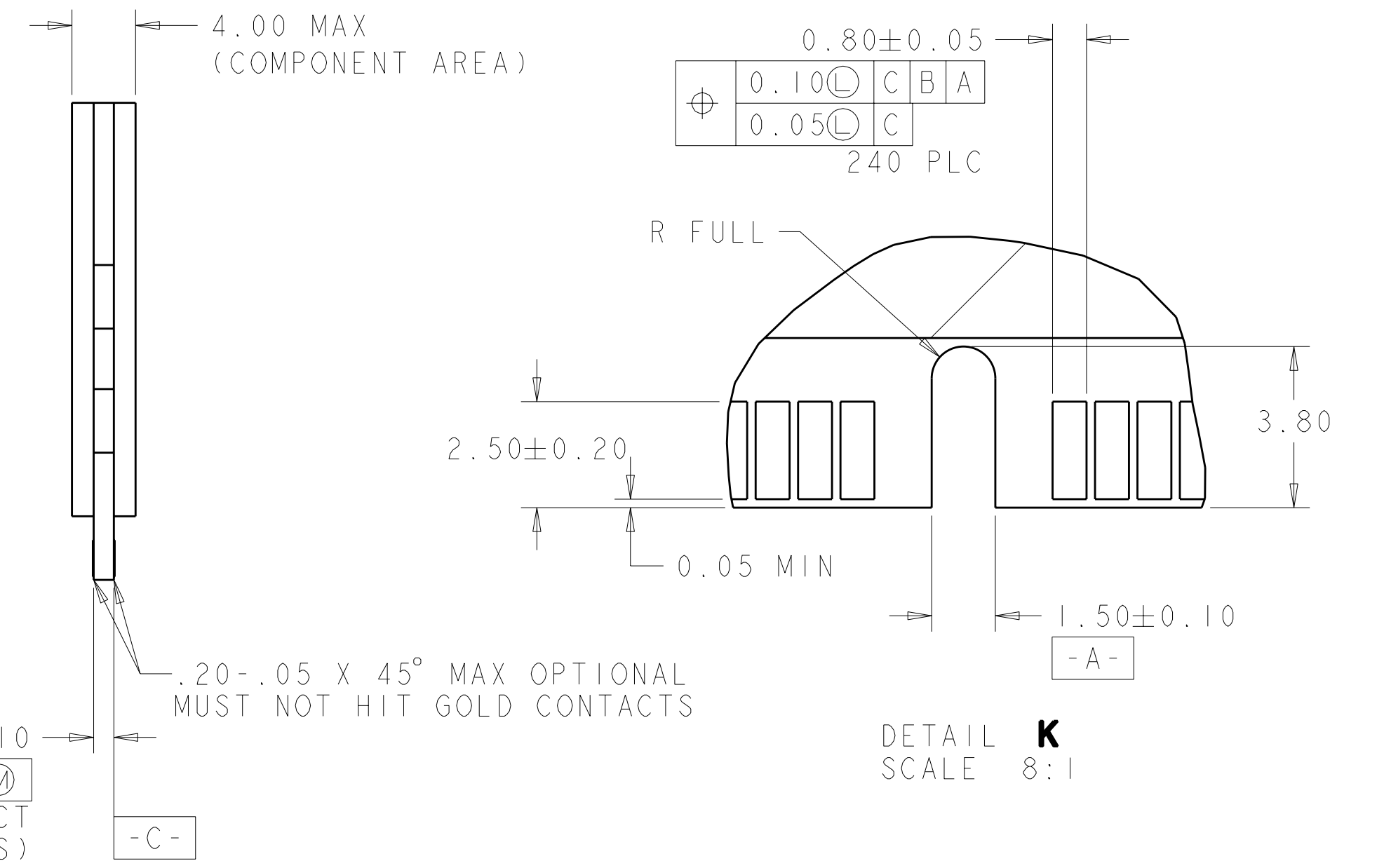

DETAIL K
SCALE 8:1

THIS DRAWING IS A CONTROLLED DOCUMENT.		DWN D. RINGLER 28OCT2003	TE Connectivity
DIMENSIONS:		CHK J. McCLELLAN 29OCT2003	
mm	TOLERANCES UNLESS OTHERWISE SPECIFIED:	APVD J. McCLELLAN 29OCT2003	NAME
	9 PLC ± 1 PLC ±0.25 2 PLC ±0.15 3 PLC ±0.13 4 PLC ± ANGLES ±#1	PRODUCT SPEC	SOCKET ASSEMBLY
MATERIAL	FINISH	APPLICATION SPEC	25 DEGREE DDR II DIMM
		114-13130	240 POSITION, STANDARD FOOTPRINT
		WEIGHT	SIZE CAGE CODE DRAWING NO
		CUSTOMER DRAWING	A100779C=1658912
		SCALE 1:1	SHEET 3 OF 3 REV A3