



Catalog

Solution series MC4-Evo2 photovoltaic connectors

MC4-Evo2 PV connectors

The latest generation of photovoltaic connectors

The MC4-Evo2 range is the latest evolution of MC4 PV connectors. Combining the highest performances on the market and worldwide certifications, this new range benefits from years of expertise making it truly reliable.



Easy to install

Install it everywhere without any operational restriction:

- Installation in unrestricted access locations by any professional (Class A approval)
- Easy and quick preparation thanks to adapted tools
- Efficient locking system saving mounting time.

MC4 and MC4-Evo2 manufactured by Multi-Contact



Safety and protection

Protect personnel and secure installations with:

- Constant contact pressure maintained by a patented contact technology
- Quality track record over the past 20 years
- Integrated lock clip (NEC 2011 compliant).



Reliable in harsh conditions

Trust your installation in all environmental conditions:

- Extensive environmental testing (UV, ammonia, salt-mist spray)
- High IP class (IP65/IP68, 1 m/60 min, mated)
- Impact-resistant polyamide housing
- Worldwide certified.

1SNC160237S0201

Connection devices for solar applications

Connection products in PV installations

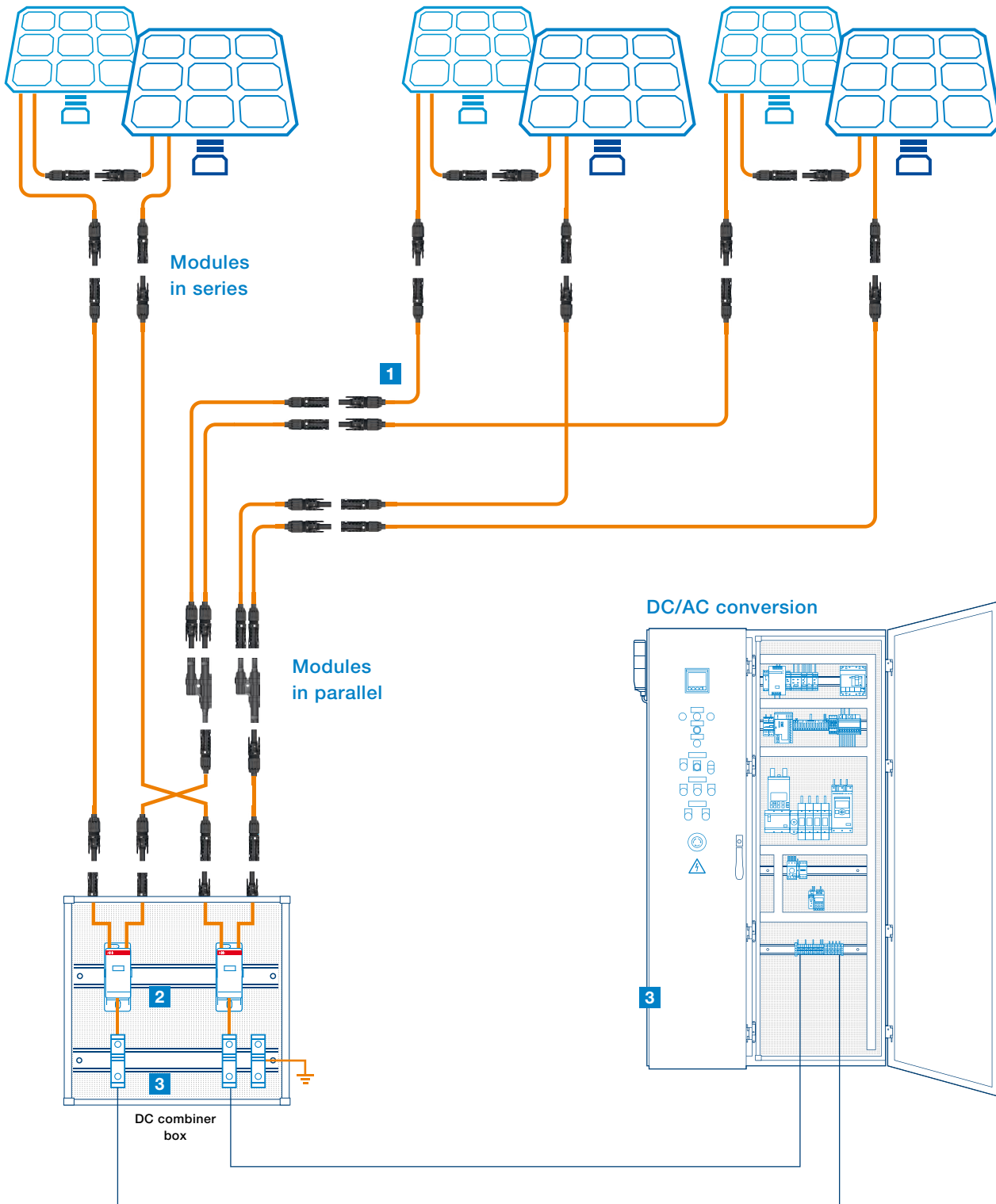
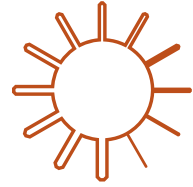

MC4 and MC4-Evo2 manufactured by Multi-Contact

Leading player in the solar power industry since the early 1990s, ABB's portfolio of products, systems and solutions for the solar power industry is extensive. Benefit from one single source for all connection needs thanks to ABB complete connection offering for solar applications.

1 MC4-Evo2 PV connectors

- Ensure connections of the DC circuits on commercial, industrial and residential rooftop PV installations: from the PV modules to the combiner boxes (in series or in parallel) and from the combiner boxes to the string inverter
- Products made by Multi-Contact and therefore fully compatible and equivalent to all MC4 family products
- Rated voltage up to 1500 V DC (IEC) / 1500 V DC (UL).

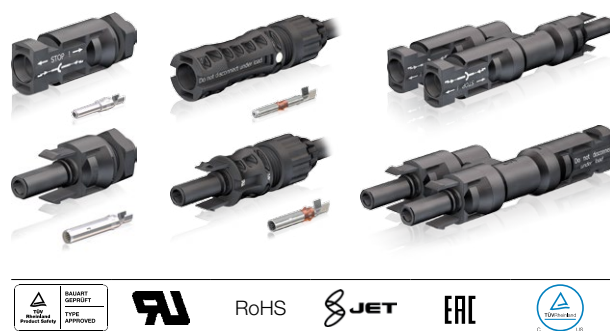

2 DBL range - Distribution blocks

- Grouping of several inputs into one output for DC applications, or single and multipole splitting for AC power applications
- Reversible cover that facilitates identification and wiring tasks
- Modular and touch proof design that eliminates bus bars, isolators, fasteners or protection screens
- Saving up to 50% rail space
- Rated voltage up to 1500 V DC (IEC) / 1000 V DC (UL).

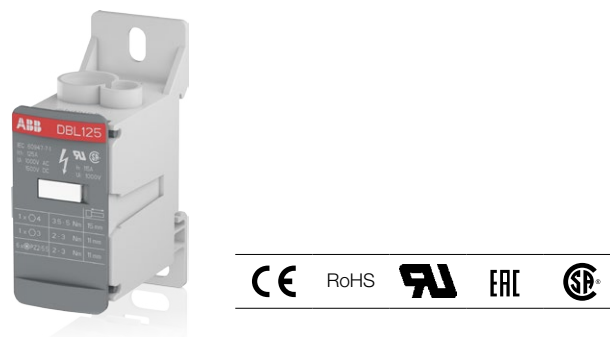

3 SNK series - Terminal blocks

- 2 technologies available with common accessories and suitable for AC power applications and DC photovoltaic systems
- Screwless PI-Spring technology that combines 2 connection modes: direct push-in mode for 50% time saving and screw-driver connection mode for improved comfort
- Screw clamp technology to connect 2 wires in 1 clamp
- Rated voltage up to 1250 V DC (IEC) / 1000 V DC (UL).

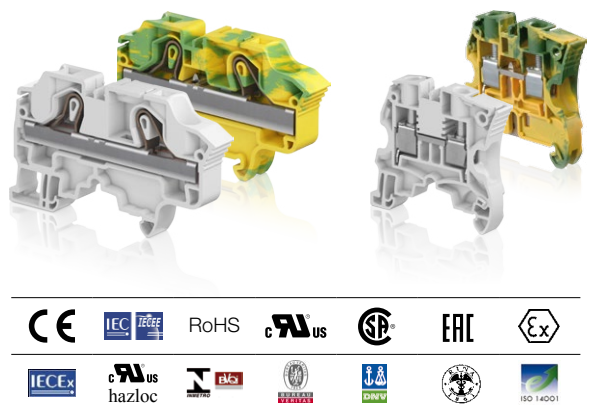

MC4 and MC4-Evo2 manufactured by Multi-Contact

Connection devices for solar applications

Selection guide



MC4-Evo2 PV connectors

Connector type	Cross section		Max rated current		Rated voltage		Type	Order code	Pkg qty
	IEC mm ²	UL in	IEC A	UL A	IEC V DC	UL V DC			
Female									
Plug	4 ... 6	12 ... 10	45/53	35/50	1500	1500	PV-PLUG-F6/6.1	1SNV420862R0000	10
								1SNV420864R0000	100
	4 ... 6	12 ... 10	45/53	35/50	1500	1500	PV-PLUG-F6/7.6	1SNV420882R0000	10
								1SNV420884R0000	100
Panel receptacle (1)	4 ... 6	12 ... 10	45/53	35/50	1500	1500	PV-PLUG-F6/8.5	1SNV420902R0000	10
								1SNV420904R0000	100
	10	8	69	70	1500	1500	PV-PLUG-F10/8.5	1SNV420924R0000	100
	4 ... 6	12 ... 10	39/45	30	1250	1000	PV-RECEP-F6	1SNV420944R0000	100
Branch connector	-	-	30	50	1000	1500	PV-BRANCH-F	1SNV420183R0000	20
Male									
Plug	4 ... 6	12 ... 10	45/53	35/50	1500	1500	PV-PLUG-M6/6.1	1SNV420872R0000	10
								1SNV420874R0000	100
	4 ... 6	12 ... 10	45/53	35/50	1500	1500	PV-PLUG-M6/7.6	1SNV420892R0000	10
								1SNV420894R0000	100
Panel receptacle (1)	4 ... 6	12 ... 10	45/53	35/50	1500	1500	PV-PLUG-M6/8.5	1SNV420912R0000	10
								1SNV420914R0000	100
	10	8	69	70	1500	1500	PV-PLUG-M10/8.5	1SNV420934R0000	100
	4 ... 6	12 ... 10	39/45	30	1250	1000	PV-RECEP-M6	1SNV420954R0000	100
Branch connector	-	-	30	50	1000	1500	PV-BRANCH-M	1SNV420193R0000	20

(1) MC4 original to be replaced by MC4-Evo2 types end of 2016



DBL Distribution blocks

	Max current		Connection type	Max cross section						Type	Order code	Pkg qty		
	IEC	UL/CSA		Diameter of cable Ø		Flexible with ferrule		Stranded					Rigid (solid)	
				nb	mm	in	mm ²	AWG	mm ²				AWG	mm ²
	Cu: 80 A Al: 63 A	Cu: 80 A	3	6.6	0.26	2.5 ... 16	14 ... 6	2.5 ... 16	14 ... 4	2.5 ... 16	14 ... 10	DBL80	1SNL308010R0000	1
			4	4.5	0.177	2.5 ... 6	14 ... 10	2.5 ... 6	14 ... 10	2.5 ... 6	14 ... 10			
	Cu: 125 A Al: 100 A	Cu: 115 A	1	9.8	0.386	10 ... 35	8 ... 2	10 ... 35	8 ... 2	10 ... 35	-	DBL125	1SNL312510R0000	1
			1	6.8	0.268	2.5 ... 16	14 ... 6	6 ... 16	10 ... 6	6 ... 16	10			
			6	6.5	0.256	2.5 ... 16	14 ... 6	2.5 ... 16	14 ... 6	2.5 ... 16	14 ... 10			
	Cu: 160 A Al: 135 A	Cu: 160 A	1	11.8	0.465	10 ... 50	8 ... 1/0	10 ... 70	6 ... 2/0	10 ... 70	-	DBL160	1SNL316010R0000	1
			1	6.8	0.268	2.5 ... 16	14 ... 6	6 ... 16	10 ... 6	6 ... 16	10			
			6	6.5	0.256	2.5 ... 16	14 ... 6	2.5 ... 16	14 ... 6	2.5 ... 16	14 ... 10			
	Cu: 175 A Al: 135 A	Cu: 175 A	2	11.8	0.465	10 ... 50	8 ... 1/0	10 ... 70	6 ... 2/0	10 ... 70	-	DBL175	1SNL317510R0000	1
			10	6.4	0.252	2.5 ... 16	14 ... 6	2.5 ... 16	14 ... 6	2.5 ... 16	14 ... 10			
	Cu: 250 A Al: 200 A	Cu: 255 A	1	15.3	0.602	35 ... 95	2 ... 3/0	35 ... 120	2 ... 250 kcmil	35 ... 120	-	DBL250	1SNL325010R0000	1
			2	8.7	0.343	2.5 ... 25	14 ... 4	2.5 ... 35	14 ... 2	2.5 ... 35	14 ... 10			
			5	6.5	0.256	2.5 ... 16	14 ... 6	2.5 ... 16	14 ... 6	2.5 ... 16	14 ... 10			
			4	5.7	0.224	2.5 ... 10	14 ... 8	2.5 ... 10	14 ... 8	2.5 ... 10	14 ... 10			
			4	5.7	0.224	2.5 ... 10	14 ... 8	2.5 ... 10	14 ... 8	2.5 ... 10	14 ... 10			
	Cu: 400 A Al: 300 A	Cu: 335 A	1	19.8	0.78	95 ... 150	3/0 ... 300 kcmil	95 ... 185	3/0 ... 400 kcmil	95 ... 185	-	DBL400	1SNL340010R0000	1
			2	8.7	0.343	2.5 ... 25	14 ... 4	2.5 ... 35	14 ... 2	2.5 ... 35	14 ... 10			
			5	6.5	0.256	2.5 ... 16	14 ... 6	2.5 ... 16	14 ... 6	2.5 ... 16	14 ... 10			
			4	5.7	0.224	2.5 ... 10	14 ... 8	2.5 ... 10	14 ... 8	2.5 ... 10	14 ... 10			
			4	5.7	0.224	2.5 ... 10	14 ... 8	2.5 ... 10	14 ... 8	2.5 ... 10	14 ... 10			

Rated voltage 1000 V AC, 1500 V DC (IEC) / 1000 V AC/DC (UL/CSA)

MC4 and MC4-Evo2 manufactured by Multi-Contact



SNK series, terminal blocks - PI-Spring

Cross section		Rated current		Number of connections	Rated voltage		Type
IEC mm ²	UL/CSA AWG	IEC A	UL/CSA A		IEC	UL/CSA	
2.5 ... 10	12 ... 6	24 ... 57	20 ... 55	2 3	1000 V AC/DC	600 V AC/DC	ZK2.5, ZK4, ZK6, ZK10 ZK2.5-3P, ZK4-3P, ZK6-3P, ZK10-3P
2.5 and 4	12 and 10	24 and 32	20 and 30	4			ZK2.5-4P ZK4-4P
10 and 16	6 and 4	57 and 76	55 and 75	2			ZK10 ZK16
10 and 16	6 and 4	57 and 76	55 and 75	3	1000 V AC / 1250 V DC	1000 V AC/DC	ZK10-3P ZK16-3P



SNK series, terminal blocks - Screw clamp

Cross section		Rated current		Number of connections	Rated voltage		Type
IEC mm ²	UL/CSA AWG	IEC A	UL/CSA A		IEC	UL/CSA	
2.5 ... 10	14 ... 6	32 ... 57	20 ... 42	2	1000 V AC / 1030 V DC	600 V AC/DC	ZS4, ZS6, ZS10
16	4	76	67		1000 V AC / 1050 V DC		ZS16
25	3	101	100		1000 V AC/DC (1)		ZS25
50 ... 95	1/0 ... 3/0	150 ... 232	140 ... 230		1000 V AC / 1250 V DC	1000 V AC/DC	ZS50, ZS70, ZS95

(1) With dedicated accessories



SNK series, terminal blocks - Pluggable

Cross section		Rated current		Number of connections	Rated voltage		Type
IEC mm ²	UL/CSA AWG	IEC A	UL/CSA A		IEC	UL	
2.5	12	24 A	22 A	4	1000 V AC/DC	600 V AC/DC	ZDK2.5-22
4	10	30 A	30 A				ZDK4-22
		29 A	28 A				ZDS4-22

MC4-Evo2 PV connectors

Features and benefits

20 years of expertise

- ABB has selected the best and most reliable products on the market, manufactured by Multi-Contact
- Proven MULTILAM contact technology resulting in a low and constant contact resistance with long-term stability
- Designed in Switzerland, manufactured in Germany.



Highest performances on the market

- Highest voltage levels: 1500 V DC (IEC) / 1500 V DC (UL)
- High current levels: up to 70 A
- Class A: installation in unrestricted access locations by any professional.



Complete range of connectors and accessories

- Plugs, panel receptacles and branch connectors for all solar connection needs
- Multi-Contact ensures full compatibility and conformity with other connectors from MC4 family
- Certifications received for the combination of plugs and crimping tool.



Worldwide tested and certified products

- Internationally certified: TÜV (IEC), UL, EAC, JET, cTÜVus, RoHS
- Suited for all climatic environments
- NEC 2011 compliant: integrated lock clip.

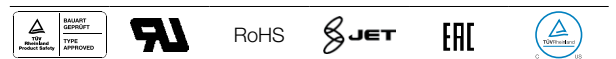

MC4-Evo2 PV connectors

Range overview



Plug connectors

DIA cable insulation		Cross section	
mm	in	mm ²	AWG
4.7 ... 6.1	0.18 ... 0.24	4 ... 6	12 ... 10
6.1 ... 7.6	0.24 ... 0.29	4 ... 6	12 ... 10
7.6 ... 8.5	0.29 ... 0.33	4 ... 6	12 ... 10
7.6 ... 8.5	0.29 ... 0.33	10	8

Female



PV-PLUG-F6/6.1
PV-PLUG-F6/7.6
PV-PLUG-F6/8.5
PV-PLUG-F10/8.5

Male



PV-PLUG-M6/6.1
PV-PLUG-M6/7.6
PV-PLUG-M6/8.5
PV-PLUG-M10/8.5



Panel receptacles MC4 original (1)

DIA cable insulation		Cross section	
mm	in	mm ²	AWG
-	-	4 ... 6	12 ... 10

Female



PV-RECEP-F6

Male



PV-RECEP-M6

(1) MC4 original to be replaced by MC4-Evo2 types end of 2016



Branch connectors

In / out

2 females / 1 male

2 males / 1 female

Female



PV-BRANCH-F

Male



PV-BRANCH-M

MC4 and MC4-Evo2 manufactured by Multi-Contact

PV-PLUG-F6/6.1, PV plug connector

Female – 4 ... 6 mm² - 12 ... 10 AWG cross section

Ø 4.7 ... 6.1 mm - 0.18 ... 0.24 in cable insulation



PV-PLUG-F6/6.1

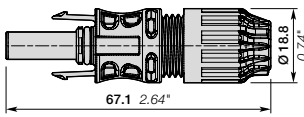

Description

Combines the highest performances on the market with proven long-term efficiency:

- 1500 V DC (IEC), 1500 V DC (UL),
- Full compatibility with all Multi-Contact MC4 family products,
- Use the tools specified by ABB and Multi-Contact to guarantee the connection quality and reliability,
- User manual MA 273.

Ordering details

Description	Color	Type	Order code	Pkg qty	Weight (1 pce) g
Female PV plug connector	Black ■	PV-PLUG-F6/6.1	1SNV420862R0000	10	10.5
		PV-PLUG-F6/6.1	1SNV420864R0000	100	10.5

Main technical data

Connecting capacity	IEC	UL
Cross section	4 ... 6 mm ²	12 ... 10 AWG
Cable insulation diameter	4.7 ... 6.1 mm - 0.18 ... 0.24 in	
Maximum rated current 4 / 6 mm ² - 12 / 10 AWG	45 / 53 A	35 / 50 A
Rated voltage	1500 V DC	1500 V DC
Rated impulse voltage	16000 V	12000 V
Protection (mated)	IP65 / IP68	
Ambient temperature range	-40 ... +85 °C	
Upper limiting temperature	115 °C	

Mounting instructions

Wire stripping length		6 ... 7.5 mm 0.236 ... 0.275 in
Torque		3.4 ... 3.5 Nm 30.1 ... 31 lb.in

All other data are provided as supplementary information only. For more details, please consult our certificates and technical datasheet available on <http://www.ABB.com>

RoHS	RoHS	USR	EAC	EAC	TUV	JET	JET	cTUVus
------	------	-----	-----	-----	-----	-----	-----	--------

Assembly instructions



Tools

Description	Color	Type	Order code	Pkg qty	Weight (1 pce) g
1 Crimping tool For plug connectors 4 ... 6 mm ²	Blue-black ■	PV-CRIMP-PLUG	1SNV420411R0000	1	735
2 Wrench tool To tighten	Grey □	PV-TIGHT-TOOL	1SNV420061R0000	1	123.5
3 Open-end spanners 2 in metal	Black-red ■	PV-SPANNER	1SNV420581R0000	1	307.1

Complete information available in the tools section of the catalog.

Accessories

Description	Color	Type	Order code	Pkg qty	Weight (1 pce) g
1 Sealing cap For unmated female connectors	Black ■	PV-CAP-F	1SNV420164R0000	100	3.7

Complete information available in the accessories section of the catalog.

MC4 and MC4-Evo2 manufactured by Multi-Contact
All the technical data for UL standard and dimensions in inches are in *italics*.

PV-PLUG-M6/6.1, PV plug connector

Male – 4 ... 6 mm² - 12 ... 10 AWG cross section

Ø 4.7 ... 6.1 mm - 0.18 ... 0.24 in cable insulation



PV-PLUG-M6/6.1

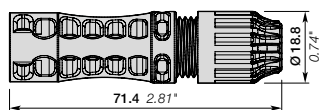

Description

- Combines the highest performances on the market with proven long-term efficiency:
- 1500 V DC (IEC), 1500 V DC (UL),
 - Full compatibility with all Multi-Contact MC4 family products,
 - Use the tools specified by ABB and Multi-Contact to guarantee the connection quality and reliability,
 - User manual MA 273.

Ordering details

Description	Color	Type	Order code	Pkg qty	Weight (1 pce) g
Male PV plug connector	Black ■	PV-PLUG-M6/6.1	1SNV420872R0000	10	14.4
		PV-PLUG-M6/6.1	1SNV420874R0000	100	14.4

Main technical data

Connecting capacity	IEC	UL
Cross section	4 ... 6 mm ²	12 ... 10 AWG
Cable insulation diameter	4.7 ... 6.1 mm - 0.18 ... 0.24 in	
Maximum rated current 4 / 6 mm ² - 12 / 10 AWG	45 / 53 A	35 / 50 A
Rated voltage	1500 V DC	1500 V DC
Rated impulse voltage	16000 V	12000 V
Protection (mated)	IP65 / IP68	
Ambient temperature range	-40 ... +85 °C	
Upper limiting temperature	115 °C	

Mounting instructions

Wire stripping length	Torque
6 ... 7.5 mm 0.236 ... 0.275 in	3.4 ... 3.5 Nm 30.1 ... 31 lb.in

All other data are provided as supplementary information only. For more details, please consult our certificates and technical datasheet available on <http://www.ABB.com>

RoHS	USR	EAC	TUV	JET	cTUVus
------	-----	-----	-----	-----	--------

Assembly instructions

1. Crimping,
2. Crimped contact insertion,
3. Connector's tightening,
4. Plugging.

Tools

Description	Color	Type	Order code	Pkg qty	Weight (1 pce) g
1 Crimping tool For plug connectors 4 ... 6 mm ²	Blue-black ■	PV-CRIMP-PLUG	1SNV420411R0000	1	735
2 Wrench tool To tighten	Grey □	PV-TIGHT-TOOL	1SNV420061R0000	1	123.5
3 Open-end spanners 2 in metal	Black-red ■	PV-SPANNER	1SNV420581R0000	1	307.1

Complete information available in the tools section of the catalog.

Accessories

Description	Color	Type	Order code	Pkg qty	Weight (1 pce) g
1 Sealing cap For unmated male connectors	Black ■	PV-CAP-M	1SNV420174R0000	100	2.8

Complete information available in the accessories section of the catalog.

MC4 and MC4-Evo2 manufactured by Multi-Contact
All the technical data for UL standard and dimensions in inches are in italic.

PV-PLUG-F6/7.6, PV plug connector

Female – 4 ... 6 mm² - 12 ... 10 AWG cross section

Ø 6.1 ... 7.6 mm - 0.24 ... 0.29 in cable insulation



PV-PLUG-F6/7.6

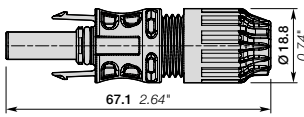

Description

Combines the highest performances on the market with proven long-term efficiency:

- 1500 V DC (IEC), 1500 V DC (UL),
- Full compatibility with all Multi-Contact MC4 family products,
- Use the tools specified by ABB and Multi-Contact to guarantee the connection quality and reliability,
- User manual MA 273.

Ordering details

Description	Color	Type	Order code	Pkg qty	Weight (1 pce) g
Female PV plug connector	Black ■	PV-PLUG-F6/7.6	1SNV420882R0000	10	10.5
		PV-PLUG-F6/7.6	1SNV420884R0000	100	10.5

Main technical data

Connecting capacity	IEC	UL
Cross section	4 ... 6 mm ²	12 ... 10 AWG
Cable insulation diameter	6.1 ... 7.6 mm - 0.24 ... 0.29 in	
Maximum rated current 4 / 6 mm ² - 12 / 10 AWG	45 / 53 A	35 / 50 A
Rated voltage	1500 V DC	1500 V DC
Rated impulse voltage	16000 V	12000 V
Protection (mated)	IP65 / IP68	
Ambient temperature range	-40 ... +85 °C	
Upper limiting temperature	115 °C	

Mounting instructions

Wire stripping length	6 ... 7.5 mm 0.236 ... 0.275 in
Torque	3.4 ... 3.5 Nm 30.1 ... 31 lb.in

All other data are provided as supplementary information only. For more details, please consult our certificates and technical datasheet available on <http://www.ABB.com>

RoHS	RoHS	USR	ERC	EAC	TUV	JET	JET	cTUVus
------	------	-----	-----	-----	-----	-----	-----	--------

Assembly instructions

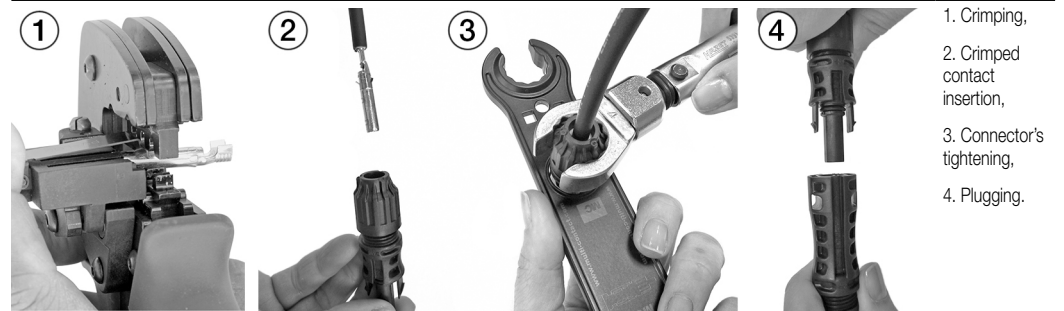

Tools

Description	Color	Type	Order code	Pkg qty	Weight (1 pce) g
1 Crimping tool For plug connectors 4 ... 6 mm ²	Blue-black ■	PV-CRIMP-PLUG	1SNV420411R0000	1	735
2 Wrench tool To tighten	Grey □	PV-TIGHT-TOOL	1SNV420061R0000	1	123.5
3 Open-end spanners 2 in metal	Black-red ■	PV-SPANNER	1SNV420581R0000	1	307.1

Complete information available in the tools section of the catalog.

Accessories

Description	Color	Type	Order code	Pkg qty	Weight (1 pce) g
1 Sealing cap For unmated female connectors	Black ■	PV-CAP-F	1SNV420164R0000	100	3.7

Complete information available in the accessories section of the catalog.

MC4 and MC4-Evo2 manufactured by Multi-Contact
All the technical data for UL standard and dimensions in inches are in *italics*.

PV-PLUG-M6/7.6, PV plug connector

Male – 4 ... 6 mm² - 12 ... 10 AWG cross section

Ø 6.1 ... 7.6 mm - 0.24 ... 0.29 in cable insulation



PV-PLUG-M6/7.6

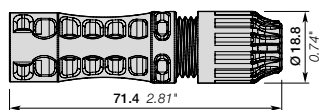

Description

Combines the highest performances on the market with proven long-term efficiency:

- 1500 V DC (IEC), 1500 V DC (UL),
- Full compatibility with all Multi-Contact MC4 family products,
- Use the tools specified by ABB and Multi-Contact to guarantee the connection quality and reliability,
- User manual MA 273.

Ordering details

Description	Color	Type	Order code	Pkg qty	Weight (1 pce) g
Male PV plug connector	Black ■	PV-PLUG-M6/7.6	1SNV420892R0000	10	14.4
		PV-PLUG-M6/7.6	1SNV420894R0000	100	14.4

Main technical data

Connecting capacity	IEC	UL
Cross section	4 ... 6 mm ²	12 ... 10 AWG
Cable insulation diameter	6.1 ... 7.6 mm - 0.24 ... 0.29 in	
Maximum rated current 4 / 6 mm ² - 12 / 10 AWG	45 / 53 A	35 / 50 A
Rated voltage	1500 V DC	1500 V DC
Rated impulse voltage	16000 V	12000 V
Protection (mated)	IP65 / IP68	
Ambient temperature range	-40 ... +85 °C	
Upper limiting temperature	115 °C	

Mounting instructions

Wire stripping length		6 ... 7.5 mm 0.236 ... 0.275 in
Torque		3.4 ... 3.5 Nm 30.1 ... 31 lb.in

All other data are provided as supplementary information only. For more details, please consult our certificates and technical datasheet available on <http://www.ABB.com>

RoHS	RoHS	USR	EAC	EAC	TUV	JET	JET	cTUVus
------	------	-----	-----	-----	-----	-----	-----	--------

Assembly instructions

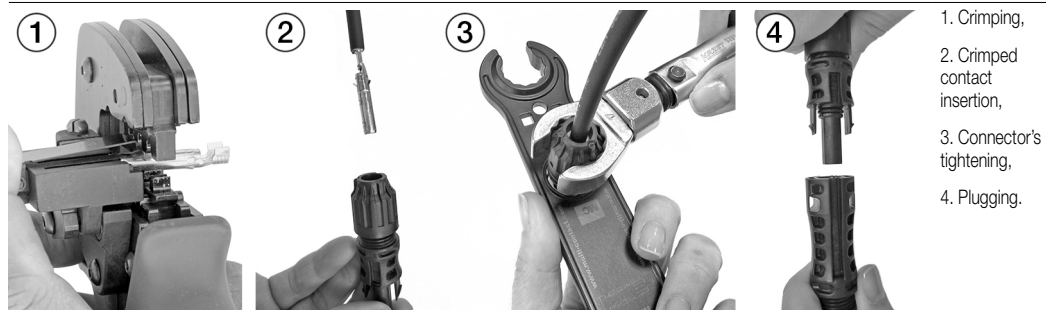

Tools

Description	Color	Type	Order code	Pkg qty	Weight (1 pce) g
1 Crimping tool For plug connectors 4 ... 6 mm ²	Blue-black ■	PV-CRIMP-PLUG	1SNV420411R0000	1	735
2 Wrench tool To tighten	Grey □	PV-TIGHT-TOOL	1SNV420061R0000	1	123.5
3 Open-end spanners 2 in metal	Black-red ■	PV-SPANNER	1SNV420581R0000	1	307.1

Complete information available in the tools section of the catalog.

Accessories



Description	Color	Type	Order code	Pkg qty	Weight (1 pce) g
1 Sealing cap For unmated male connectors	Black ■	PV-CAP-M	1SNV420174R0000	100	2.8

Complete information available in the accessories section of the catalog.

MC4 and MC4-Evo2 manufactured by Multi-Contact
All the technical data for UL standard and dimensions in inches are in italic.

PV-PLUG-F6/8.5, PV plug connector

Female – 4 ... 6 mm² - 12 ... 10 AWG cross section

Ø 7.6 ... 8.5 mm - 0.29 ... 0.33 in cable insulation



PV-PLUG-F6/8.5

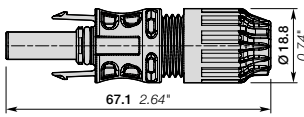

Description

Combines the highest performances on the market with proven long-term efficiency:

- 1500 V DC (IEC), 1500 V DC (UL),
- Full compatibility with all Multi-Contact MC4 family products,
- Use the tools specified by ABB and Multi-Contact to guarantee the connection quality and reliability,
- User manual MA 273.

Ordering details

Description	Color	Type	Order code	Pkg qty	Weight (1 pce) g
Female PV plug connector	Black ■	PV-PLUG-F6/8.5	1SNV420902R0000	10	10.5
		PV-PLUG-F6/8.5	1SNV420904R0000	100	10.5

Main technical data

Connecting capacity	IEC	UL
Cross section	4 ... 6 mm ²	12 ... 10 AWG
Cable insulation diameter	7.6 ... 8.5 mm - 0.29 ... 0.33 in	
Maximum rated current 4 / 6 mm ² - 12 / 10 AWG	45 / 53 A	35 / 50 A
Rated voltage	1500 V DC	1500 V DC
Rated impulse voltage	16000 V	12000 V
Protection (mated)	IP65 / IP68	
Ambient temperature range	-40 ... +85 °C	
Upper limiting temperature	115 °C	

Mounting instructions

Wire stripping length	6 ... 7.5 mm 0.236 ... 0.275 in
Torque	3.4 ... 3.5 Nm 30.1 ... 31 lb.in

All other data are provided as supplementary information only. For more details, please consult our certificates and technical datasheet available on <http://www.ABB.com>

RoHS	RoHS	USR	ERC	EAC	TUV	JET	JET	cTUVus
------	------	-----	-----	-----	-----	-----	-----	--------

Assembly instructions

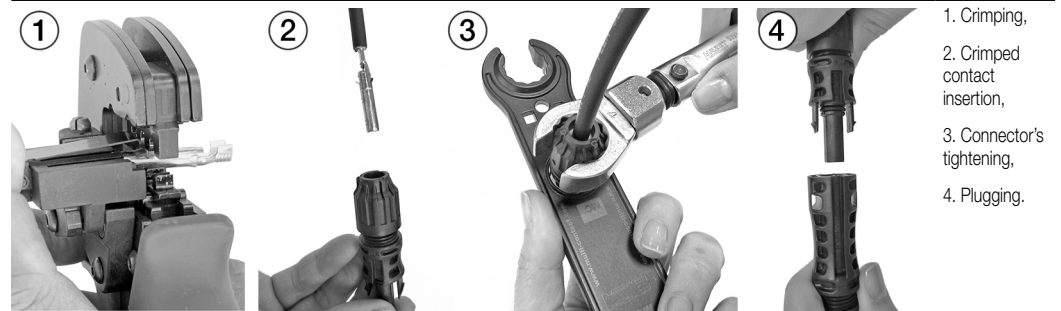

Tools

Description	Color	Type	Order code	Pkg qty	Weight (1 pce) g
1 Crimping tool For plug connectors 4 ... 6 mm ²	Blue-black ■	PV-CRIMP-PLUG	1SNV420411R0000	1	735
2 Wrench tool To tighten	Grey □	PV-TIGHT-TOOL	1SNV420061R0000	1	123.5
3 Open-end spanners 2 in metal	Black-red ■	PV-SPANNER	1SNV420581R0000	1	307.1

Complete information available in the tools section of the catalog.

Accessories



Description	Color	Type	Order code	Pkg qty	Weight (1 pce) g
1 Sealing cap For unmated female connectors	Black ■	PV-CAP-F	1SNV420164R0000	100	3.7

Complete information available in the accessories section of the catalog.

MC4 and MC4-Evo2 manufactured by Multi-Contact
All the technical data for UL standard and dimensions in inches are in *italics*.

PV-PLUG-M6/8.5, PV plug connector

Male – 4 ... 6 mm² - 12 ... 10 AWG cross section

Ø 7.6 ... 8.5 mm - 0.29 ... 0.33 in cable insulation



PV-PLUG-M6/8.5

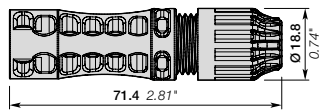

Description

Combines the highest performances on the market with proven long-term efficiency:

- 1500 V DC (IEC), 1500 V DC (UL),
- Full compatibility with all Multi-Contact MC4 family products,
- Use the tools specified by ABB and Multi-Contact to guarantee the connection quality and reliability,
- User manual MA 273.

Ordering details

Description	Color	Type	Order code	Pkg qty	Weight (1 pce) g
Male PV plug connector	Black ■	PV-PLUG-M6/8.5	1SNV420912R0000	10	14.4
		PV-PLUG-M6/8.5	1SNV420914R0000	100	14.4

Main technical data

Connecting capacity	IEC	UL
Cross section	4 ... 6 mm ²	12 ... 10 AWG
Cable insulation diameter	7.6 ... 8.5 mm - 0.29 ... 0.33 in	
Maximum rated current 4 / 6 mm ² - 12 / 10 AWG	45 / 53 A	35 / 50 A
Rated voltage	1500 V DC	1500 V DC
Rated impulse voltage	16000 V	12000 V
Protection (mated)	IP65 / IP68	
Ambient temperature range	-40 ... +85 °C	
Upper limiting temperature	115 °C	

Mounting instructions

Wire stripping length		6 ... 7.5 mm 0.236 ... 0.275 in
Torque		3.4 ... 3.5 Nm 30.1 ... 31 lb.in

All other data are provided as supplementary information only. For more details, please consult our certificates and technical datasheet available on <http://www.ABB.com>

RoHS	RoHS	USR	EAC	EAC	TUV	JET	JET	cTUVus
------	------	-----	-----	-----	-----	-----	-----	--------

Assembly instructions

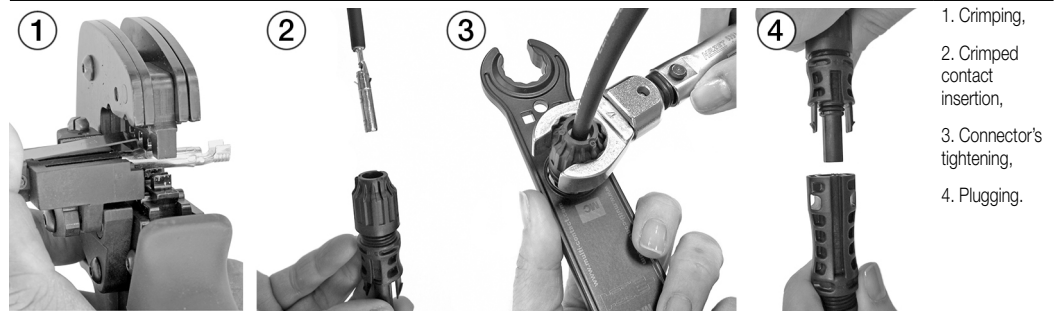

Tools

Description	Color	Type	Order code	Pkg qty	Weight (1 pce) g
1 Crimping tool For plug connectors 4 ... 6 mm ²	Blue-black ■	PV-CRIMP-PLUG	1SNV420411R0000	1	735
2 Wrench tool To tighten	Grey □	PV-TIGHT-TOOL	1SNV420061R0000	1	123.5
3 Open-end spanners 2 in metal	Black-red ■	PV-SPANNER	1SNV420581R0000	1	307.1

Complete information available in the tools section of the catalog.

Accessories



Description	Color	Type	Order code	Pkg qty	Weight (1 pce) g
1 Sealing cap For unmated male connectors	Black ■	PV-CAP-M	1SNV420174R0000	100	2.8

Complete information available in the accessories section of the catalog.

MC4 and MC4-Evo2 manufactured by Multi-Contact
All the technical data for UL standard and dimensions in inches are in italic.

PV-PLUG-F10/8.5, PV plug connector

Female – 10 mm² - 8 AWG cross section

Ø 7.6 ... 8.5 mm - 0.29 ... 0.33 in cable insulation



PV-PLUG-F10/8.5

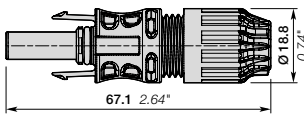

Description

Combines the highest performances on the market with proven long-term efficiency:

- 1500 V DC (IEC), 1500 V DC (UL),
- Full compatibility with all Multi-Contact MC4 family products,
- Use the tools specified by ABB and Multi-Contact to guarantee the connection quality and reliability,
- User manual MA 273.

Ordering details

Description	Color	Type	Order code	Pkg qty	Weight (1 pce) g
Female PV plug connector	Black ■	PV-PLUG-F10/8.5	1SNV420924R0000	100	10.6

Main technical data

Connecting capacity	IEC	UL
Cross section	10 mm ²	8 AWG
Cable insulation diameter	7.6 ... 8.5 mm - 0.29 ... 0.33 in	
Maximum rated current 4 / 6 mm ² - 12 / 10 AWG	69 A	70 A
Rated voltage	1500 V DC	1500 V DC
Rated impulse voltage	16000 V	12000 V
Protection (mated)	IP65 / IP68	
Ambient temperature range	-40 ... +85 °C	
Upper limiting temperature	115 °C	

Mounting instructions

Wire stripping length	6 ... 7.5 mm 0.236 ... 0.275 in
Torque	3.4 ... 3.5 Nm 30.1 ... 31 lb.in

All other data are provided as supplementary information only. For more details, please consult our certificates and technical datasheet available on <http://www.ABB.com>

RoHS RoHS	UL ULR	EAC EAC	TUV	JET JET	gTUVus
--------------	-----------	------------	-----	------------	--------

Assembly instructions

1. Crimping,
2. Crimped contact insertion,
3. Connector's tightening,
4. Plugging.

Tools

Description	Color	Type	Order code	Pkg qty	Weight (1 pce) g
1 Crimping tool For plug connectors 4 ... 6 mm ²	Blue-black ■	PV-CRIMP-PLUG	1SNV420411R0000	1	735
2 Crimping tool Insert for plug connectors 10 mm ²	Black ■	PV-INSERT	1SNV420421R0000	1	44
3 Wrench tool To tighten	Grey □	PV-TIGHT-TOOL	1SNV420061R0000	1	123.5
4 Open-end spanners 2 in metal	Black-red ■	PV-SPANNER	1SNV420581R0000	1	307.1

Complete information available in the tools section of the catalog.

Accessories

Description	Color	Type	Order code	Pkg qty	Weight (1 pce) g
1 Sealing cap For unmated female connectors	Black ■	PV-CAP-F	1SNV420164R0000	100	3.7

Complete information available in the accessories section of the catalog.

MC4 and MC4-Evo2 manufactured by Multi-Contact
All the technical data for UL standard and dimensions in inches are in *italics*.

PV-PLUG-M10/8.5, PV plug connector

Male – 10 mm² - 8 AWG cross section

Ø 7.6 ... 8.5 mm - 0.29 ... 0.33 in cable insulation



PV-PLUG-M10/8.5

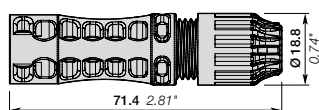

Description



Combines the highest performances on the market with proven long-term efficiency:

- 1500 V DC (IEC), 1500 V DC (UL),
- Full compatibility with all Multi-Contact MC4 family products,
- Use the tools specified by ABB and Multi-Contact to guarantee the connection quality and reliability,
- User manual MA 273.

Ordering details

Description	Color	Type	Order code	Pkg qty	Weight (1 pce) g
Male PV plug connector	Black ■	PV-PLUG-M10/8.5	1SNV420934R0000	100	14.5

Main technical data

Connecting capacity	IEC	UL	Mounting instructions
Cross section	10 mm ²	8 AWG	Wire stripping length  6 ... 7.5 mm 0.236 ... 0.275 in
Cable insulation diameter	7.6 ... 8.5 mm - 0.29 ... 0.33 in		
Maximum rated current 4 / 6 mm ² - 12 / 10 AWG	69 A	70 A	Torque  3.4 ... 3.5 Nm 30.1 ... 31 lb.in
Rated voltage	1500 V DC	1500 V DC	
Rated impulse voltage	16000 V	12000 V	
Protection (mated)	IP65 / IP68		
Ambient temperature range	-40 ... +85 °C		
Upper limiting temperature	115 °C		

All other data are provided as supplementary information only. For more details, please consult our certificates and technical datasheet available on <http://www.ABB.com>

RoHS	UL	ERC	TUV	JET	CTUVUS
------	----	-----	-----	-----	--------

Assembly instructions

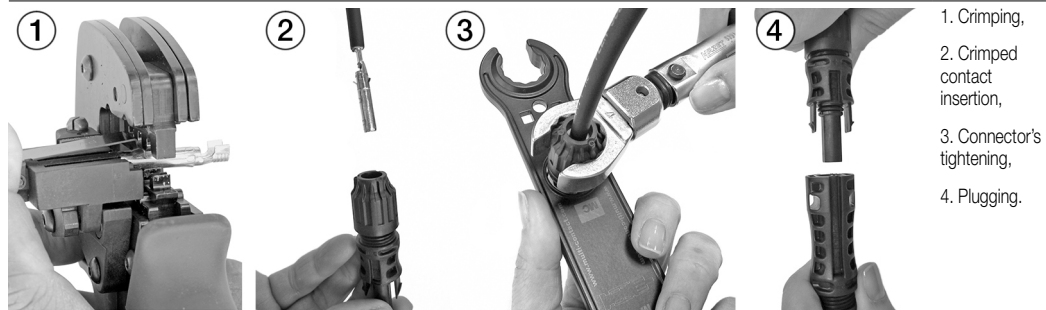

Tools

Description	Color	Type	Order code	Pkg qty	Weight (1 pce) g
1 Crimping tool For plug connectors 4 ... 6 mm ²	Blue-black ■	PV-CRIMP-PLUG	1SNV420411R0000	1	735
2 Crimping tool Insert for plug connectors 10 mm ²	Black ■	PV-INSERT	1SNV420421R0000	1	44
3 Wrench tool To tighten	Grey ■	PV-TIGHT-TOOL	1SNV420061R0000	1	123.5
4 Open-end spanners 2 in metal	Black-red ■	PV-SPANNER	1SNV420581R0000	1	307.1

Complete information available in the tools section of the catalog.

Accessories



Description	Color	Type	Order code	Pkg qty	Weight (1 pce) g
1 Sealing cap For unmated male connectors	Black ■	PV-CAP-M	1SNV420174R0000	100	2.8

Complete information available in the accessories section of the catalog.

MC4 and MC4-Evo2 manufactured by Multi-Contact
All the technical data for UL standard and dimensions in inches are in italic.

PV-RECEP-F6, PV panel receptacle

Female – 4 ... 6 mm² - 12 ... 10 AWG cross section



PV-RECEP-F6

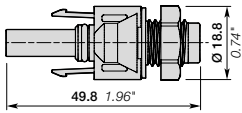

Description

- Installed on combiner boxes and inverters,
- 1250 V DC (IEC), 1000 V DC (UL),
- MC4-Evo2 version (1500 V DC IEC and UL) available at the end of 2016,
- Full compatibility with all Multi-Contact MC4 family products,
- Use the tools specified by ABB and Multi-Contact to guarantee the connection quality and reliability,
- User manual MA 275.

Ordering details

Description	Color	Type	Order code	Pkg qty	Weight (1 pce) g
Female PV panel receptacle	Black ■	PV-RECEP-F6	1SNV420944R0000	100	7.3

Main technical data

Connecting capacity	IEC	UL
Cross section	4 ... 6 mm ²	12 ... 10 AWG
Cable insulation diameter		
Maximum rated current 4 / 6 mm ² - 12 / 10 AWG	39 / 45 A	30 A
Rated voltage	1250 V DC	1000 V DC
Rated impulse voltage	16000 V	12000 V
Protection (mated)	IP65 / IP68	
Ambient temperature range	-40 ... +85 °C	
Upper limiting temperature	105 °C	

Mounting instructions

Wire stripping length	6 ... 7.5 mm 0.236 ... 0.275 in
Torque	2 Nm 17.7 lb.in

All other data are provided as supplementary information only. For more details, please consult our certificates and technical datasheet available on <http://www.ABB.com>

RoHS: RoHS	USR	EAC	TUV
------------	-----	-----	-----

Assembly instructions

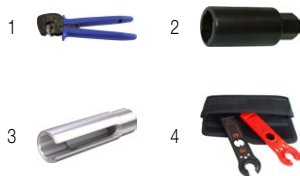
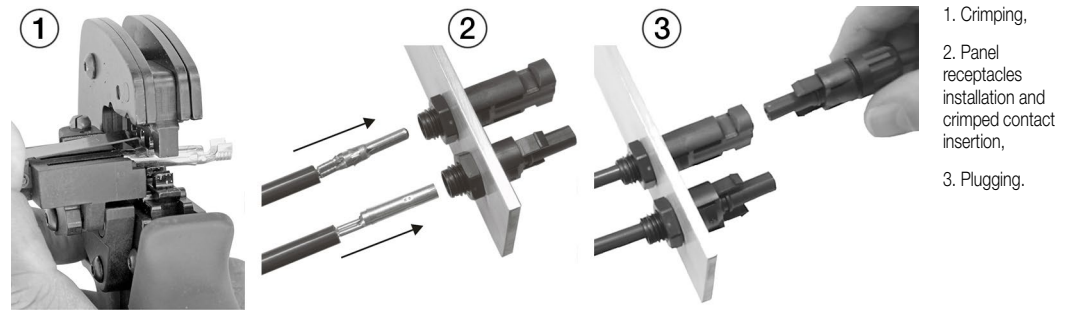

Tools

Description	Color	Type	Order code	Pkg qty	Weight (1 pce) g
1 Crimping tool For panel receptacles 4 ... 6 mm ²	Blue-black ■	PV-CRIMP-RECEP	1SNV420191R0000	1	728
2 Wrench tool To secure	Black ■	PV-SECU-TOOL	1SNV420261R0000	1	12.9
3 Wrench tool To tighten	Grey □	PV-TIGHT-TOOL	1SNV420061R0000	1	123.5
4 Open-end spanners 2 in metal	Black-red ■	PV-SPANNER	1SNV420581R0000	1	307.1

Complete information available in the tools section of the catalog.

Accessories

Description	Color	Type	Order code	Pkg qty	Weight (1 pce) g
1 Sealing cap For unmated female connectors	Black ■	PV-CAP-F	1SNV420164R0000	100	3.7

Complete information available in the accessories section of the catalog.

MC4 and MC4-Evo2 manufactured by Multi-Contact
All the technical data for UL standard and dimensions in inches are in *italics*.

PV-RECEP-M6, PV panel receptacle

Male – 4 ... 6 mm² - 12 ... 10 AWG cross section



PV-RECEP-M6

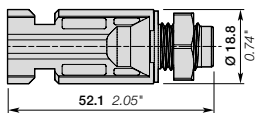

Description

- Installed on combiner boxes and inverters,
- 1250 V DC (IEC), 1000 V DC (UL),
- MC4-Evo2 version (1500 V DC IEC and UL) available at the end of 2016,
- Full compatibility with all Multi-Contact MC4 family products,
- Use the tools specified by ABB and Multi-Contact to guarantee the connection quality and reliability,
- User manual MA 275.

Ordering details

Description	Color	Type	Order code	Pkg qty	Weight (1 pce) g
Male PV panel receptacle	Black ■	PV-RECEP-M6	1SNV420954R0000	100	8.7

Main technical data

Connecting capacity	IEC	UL
Cross section	4 ... 6 mm ²	12 ... 10 AWG
Cable insulation diameter		
Maximum rated current 4 / 6 mm ² - 12 / 10 AWG	39 / 45 A	30 A
Rated voltage	1250 V DC	1000 V DC
Rated impulse voltage	16000 V	12000 V
Protection (mated)	IP65 / IP68	
Ambient temperature range	-40 ... +85 °C	
Upper limiting temperature	105 °C	

Mounting instructions

Wire stripping length	6 ... 7.5 mm 0.236 ... 0.275 in
-----------------------	------------------------------------

Torque	2 Nm 17.7 lb.in
--------	--------------------

All other data are provided as supplementary information only. For more details, please consult our certificates and technical datasheet available on <http://www.ABB.com>



Assembly instructions

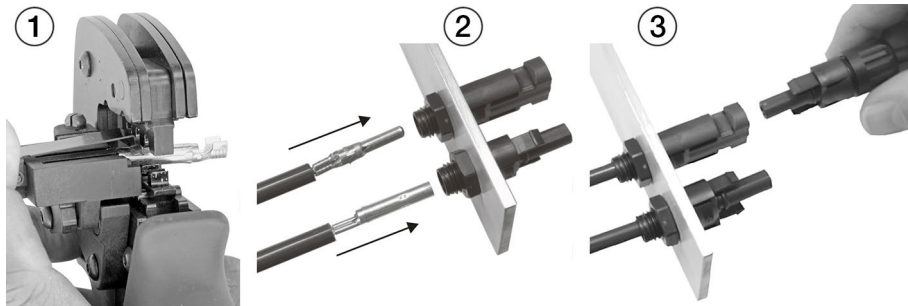

1. Crimping,
2. Panel receptacles installation and crimped contact insertion,
3. Plugging.

Tools

Description	Color	Type	Order code	Pkg qty	Weight (1 pce) g
1 Crimping tool For panel receptacles 4 ... 6 mm ²	Blue-black ■	PV-CRIMP-RECEP	1SNV420191R0000	1	728
2 Wrench tool To secure	Black ■	PV-SECU-TOOL	1SNV420261R0000	1	12.9
3 Wrench tool To tighten	Grey ■	PV-TIGHT-TOOL	1SNV420061R0000	1	123.5
4 Open-end spanners 2 in metal	Black-red ■	PV-SPANNER	1SNV420581R0000	1	307.1

Complete information available in the tools section of the catalog.



Accessories

Description	Color	Type	Order code	Pkg qty	Weight (1 pce) g
1 Sealing cap For unmated male connectors	Black ■	PV-CAP-M	1SNV420174R0000	100	2.8
2 Lock clip Nec 2011 compliant	Black ■	PV-LOCK	1SNV420804R0000	100	2.14

Complete information available in the accessories section of the catalog.



MC4 and MC4-Evo2 manufactured by Multi-Contact
All the technical data for UL standard and dimensions in inches are in *italics*.

PV-BRANCH-F, PV branch connector Female



PV-BRANCH-F

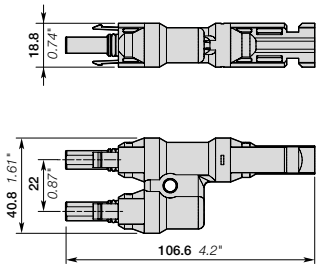

Description

- For a safe and simple parallel or serial-parallel connection of PV modules,
- Highest performances on the market: 1000 V DC (IEC), 1500 V DC (UL),
- Full compatibility with all Multi-Contact MC4 family products,
- Use the tools specified by ABB and Multi-Contact to guarantee the connection quality and reliability,
- User manual MA 250.

Ordering details

Description	Color	Type	Order code	Pkg qty	Weight (1 pce)
Female PV branch connector	Black	PV-BRANCH-F	1SNV420183R0000	20	60.1

Main technical data

Connecting capacity	IEC	UL
Maximum rated current 4 / 6 mm ² - 12 / 10 AWG	30 A	50 A
Rated voltage	1000 V DC	1500 V DC
Rated impulse voltage	12000 V	12000 V
Protection (mated)	IP67	
Ambient temperature range	-40 ... +90 °C	
Upper limiting temperature	105 °C	

All other data are provided as supplementary information only. For more details, please consult our certificates and technical datasheet available on <http://www.ABB.com>

RoHS RoHS	USR	EAC EAC
--------------	-----	------------

Assembly instructions

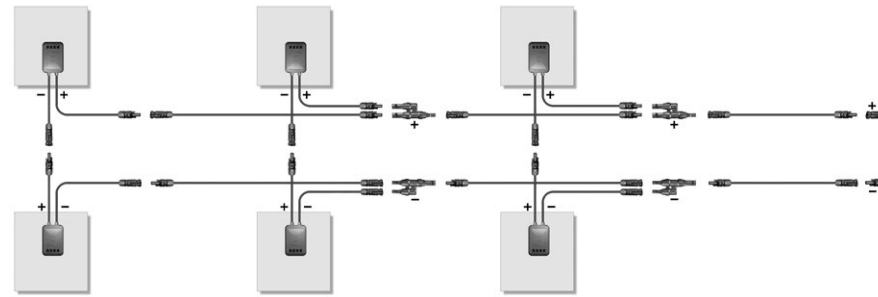

Example of PV modules in parallel thanks to branch connectors



1

Tools

Description	Color	Type	Order code	Pkg qty	Weight (1 pce)
1 Open-end spanners 2 in metal	Black-red	PV-SPANNER	1SNV420581R0000	1	307.1

Complete information available in the tools section of the catalog.

Accessories

Description	Color	Type	Order code	Pkg qty	Weight (1 pce)
1 Sealing cap For unmated female connectors	Black	PV-CAP-F	1SNV420164R0000	100	3.7
2 Sealing cap For unmated male connectors		PV-CAP-M	1SNV420174R0000	100	2.8
3 Lock clip Nec 2011 compliant	Black	PV-LOCK	1SNV420804R0000	100	2.14

Complete information available in the accessories section of the catalog.

MC4 and MC4-Evo2 manufactured by Multi-Contact

All the technical data for UL standard and dimensions in inches are in italic.

PV-BRANCH-M, PV branch connector

Male



PV-BRANCH-M

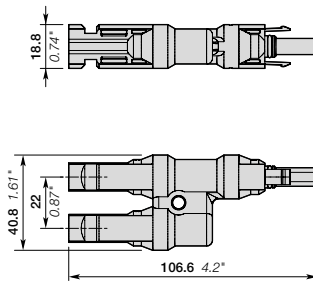

Description

- For a safe and simple parallel or serial-parallel connection of PV modules,
- Highest performances on the market: 1000 V DC (IEC), 1500 V DC (UL),
- Full compatibility with all Multi-Contact MC4 family products,
- Use the tools specified by ABB and Multi-Contact to guarantee the connection quality and reliability,
- User manual MA 250.

Ordering details

Description	Color	Type	Order code	Pkg qty	Weight (1 pce) g
Male PV branch connector	Black ■	PV-BRANCH-M	1SNV420193R0000	20	61.9

Main technical data

Connecting capacity	IEC	UL
Maximum rated current 4 / 6 mm ² - 12 / 10 AWG	30 A	50 A
Rated voltage	1000 V DC	1500 V DC
Rated impulse voltage	12000 V	12000 V
Protection (mated)	IP67	
Ambient temperature range	-40 ... +90 °C	
Upper limiting temperature	105 °C	

All other data are provided as supplementary information only. For more details, please consult our certificates and technical datasheet available on <http://www.ABB.com>

RoHS	ULSR	EAC						
------	------	-----	--	--	--	--	--	--

Assembly instructions

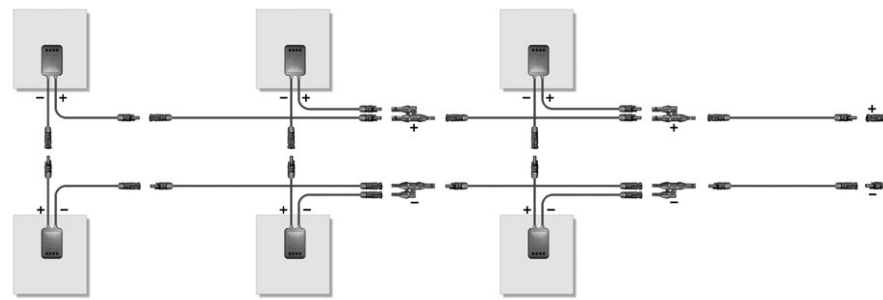

Example of PV modules in parallel thanks to branch connectors



Tools

Description	Color	Type	Order code	Pkg qty	Weight (1 pce) g
1 Open-end spanners 2 in metal	Black-red ■	PV-SPANNER	1SNV420581R0000	1	307.1

Complete information available in the tools section of the catalog.



Accessories

Description	Color	Type	Order code	Pkg qty	Weight (1 pce) g
1 Sealing cap For un-mated male connectors	Black ■	PV-CAP-M	1SNV420174R0000	100	2.8
2 Sealing cap For un-mated female connectors		PV-CAP-F	1SNV420164R0000	100	3.7
3 Lock clip Nec 2011 compliant	Black ■	PV-LOCK	1SNV420804R0000	100	2.14

Complete information available in the accessories section of the catalog.

MC4 and MC4-Evo2 manufactured by Multi-Contact
All the technical data for UL standard and dimensions in inches are in italic.

MC4-Evo2 PV accessories



PV-CAP-F

1SNV420164R0000

PV-CAP Sealing cap

Description

- Unmated connectors must be protected from moisture and dirt with a sealing cap,
- Full compatibility with all Multi-Contact MC4 family products,
- Use the tools specified by ABB and Multi-Contact to guarantee the connection quality and reliability,
- User manual MA 258.

Ordering details

Description		Color	Type	Order code	Pkg qty	Weight (1 pce) g
Sealing cap	For unmated female connectors	Black ■	PV-CAP-F	1SNV420164R0000	100	3.7
	For unmated male connectors		PV-CAP-M	1SNV420174R0000	100	2.8



PV-CAP-M

1SNV420174R0000



PV-LOCK

1SNV420804R0000

PV-LOCK Lock clip

Description

- To secure the connection of MC4 panel receptacles and branch connectors (NEC 2011 compliant),
- The lock clip is already integrated in the plug connectors,
- Can be unlocked with the PV-SPANNER tool,
- Full compatibility with all Multi-Contact MC4 family products,
- Use the tools specified by ABB and Multi-Contact to guarantee the connection quality and reliability,
- User manual MA 252.

Ordering details

Description		Color	Type	Order code	Pkg qty	Weight (1 pce) g
Lock clip	Nec 2011 compliant	Black ■	PV-LOCK	1SNV420804R0000	100	2.14

MC4-Evo2 PV tools



PV-SPANNER

1SNC160578F0014

PV-SPANNER Open-end spanners

Description

- To tighten the nuts of plug connectors and panel receptacles,
- To unlock the lock clip and MC4-Evo2 plug connectors (NEC 2011 compliant),
- Full compatibility with all Multi-Contact MC4 family products,
- Use the tools specified by ABB and Multi-Contact to guarantee the connection quality and reliability,
- User manual MA 270.

Ordering details

Description	Color	Type	Order code	Pkg qty	Weight (1 pce) g
Open-end spanners	2 in metal	Black-red	PV-SPANNER	1SNV420581R0000	1 307.1

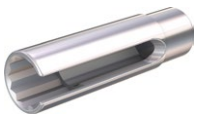

PV-TIGHT-TOOL

1SNC160660V0014

PV-WRENCH wrench tool

Description

- To tighten plug connectors and panel receptacles (PV-TIGHT-TOOL),
- To secure the tightening of panel receptacles (PV-SECU-TOOL),
- Full compatibility with all Multi-Contact MC4 family products,
- Use the tools specified by ABB and Multi-Contact to guarantee the connection quality and reliability,
- User manual MA 275.

Ordering details

Description	Color	Type	Order code	Pkg qty	Weight (1 pce) g
Wrench tool	To tighten	Grey	PV-TIGHT-TOOL	1SNV420061R0000	1 123.5
	To secure	Black	PV-SECU-TOOL	1SNV420261R0000	1 12.9



PV-SECU-TOOL

1SNC160669F0014



PV-CRIMP-PLUG

1SNC160662F0014

PV-CRIMP crimping tool

Description

- For an easy and safe preparation of crimped contacts and cables,
- Crimping tools suitable for 4 ... 6 mm² sections,
- Additional insert to be used for 10 mm² section,
- Crimping is an essential part of connectors' installation: use the crimping tool specified by ABB and Multi-Contact to guarantee the crimping quality and safety,
- User manual MA 251.

Ordering details

Description	Color	Type	Order code	Pkg qty	Weight (1 pce) g
Crimping tool	For plug connectors 4 ... 6 mm ²	Blue-black	PV-CRIMP-PLUG	1SNV420411R0000	1 735
	For panel receptacles 4 ... 6 mm ²	Blue-black	PV-CRIMP-RECEP	1SNV420191R0000	1 728
	Insert for plug connectors 10 mm ²	Black	PV-INSERT	1SNV420421R0000	1 44



PV-CRIMP-RECEP

1SNC160662F0014



PV-INSERT







1SNC160650V0014

MC4 and MC4-Evo2 manufactured by Multi-Contact
All the technical data for UL standard and dimensions in inches are in *italics*.





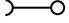
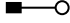
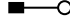

MC4-Evo2 PV connectors

Ranges' compatibility

As ABB MC4-Evo2 connectors, accessories and tools are manufactured by Multi-Contact, they are fully compatible with Multi-Contact MC4 PV connectors.

				ABB range	Compatible with MC4 range (1)		
							
				Female Plug connectors	Male Plug connectors	Male Panel receptacles	Male and Female Branch connectors
							
Dia. cable insulation		Cross section		PV-PLUG-F6/6.1	PV-KST4/6I-UR	PV-ADSP4-S2/6-UR	PV-AZB4 + PV-AZS4
mm	in	mm ²	AWG	PV-PLUG-F6/7.6	PV-KST4/6II-UR	PV-ADSP4-S2/6-UR	PV-AZB4 + PV-AZS4
4.7 ... 6.1	0.18 ... 0.24	4 ... 6	12 ... 10	PV-PLUG-F6/8.5	PV-KST4/6II-UR	PV-ADSP4-S2/6-UR	PV-AZB4 + PV-AZS4
6.1 ... 7.6	0.24 ... 0.29	4 ... 6	12 ... 10	PV-PLUG-F10/8.5	PV-KST4/8II-UR	PV-ADSP4-S2/6-UR	PV-AZB4 + PV-AZS4
7.6 ... 8.5	0.29 ... 0.33	4 ... 6	12 ... 10		+ PV-KST4/10II		
7.6 ... 8.5	0.29 ... 0.33	10	8				

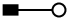
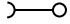
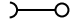
(1) Check the compatibility between cable insulation diameters of both ranges

				ABB range	Compatible with MC4 range		
							
				Male Plug connectors	Female Plug connectors	Female Panel receptacles	Female and Male Branch connectors
							
Dia. cable insulation		Cross section		PV-PLUG-M6/6.1	PV-KBT4/6I-UR	PV-ADBP4-S2/6-UR	PV-AZB4 + PV-AZS4
mm	in	mm ²	AWG	PV-PLUG-M6/7.6	PV-KBT4/6II-UR	PV-ADBP4-S2/6-UR	PV-AZB4 + PV-AZS4
4.7 ... 6.1	0.18 ... 0.24	4 ... 6	12 ... 10	PV-PLUG-M6/8.5	PV-KBT4/6II-UR	PV-ADBP4-S2/6-UR	PV-AZB4 + PV-AZS4
6.1 ... 7.6	0.24 ... 0.29	4 ... 6	12 ... 10	PV-PLUG-M10/8.5	PV-KBT4/8II-UR	PV-ADBP4-S2/6-UR	PV-AZB4 + PV-AZS4
7.6 ... 8.5	0.29 ... 0.33	4 ... 6	12 ... 10		+ PV-KBT4/10II		
7.6 ... 8.5	0.29 ... 0.33	10	8				

Female panel receptacles compatibility

Cross section
mm²

4 ... 6

AWG

12 ... 10

ABB range (1)



Female
Panel receptacles



PV-RECEP-F6

Compatible with MC4 range



Male
Panel receptacles



PV-ADSP4-S2/6-UR



Male
Plug connectors



PV-KST4/6I-UR + PV-KST4/6II-UR

(1) MC4 original to be replaced by MC4-Evo2 types end of 2016

Male panel receptacles compatibility

Cross section
mm²

4 ... 6

AWG

12 ... 10

ABB range (1)



Male
Panel receptacles



PV-RECEP-M6

Compatible with MC4 range



Female
Panel receptacles



PV-ADBP4-S2/6-UR



Female
Plug connectors



PV-KBT4/6I-UR + PV-KBT4/6II-UR

(1) MC4 original to be replaced by MC4-Evo2 types end of 2016

Branch connectors compatibility

In / out

2 females / 1 male
2 males / 1 female

ABB range



Female and Male
Branch connectors



PV-BRANCH-F
PV-BRANCH-M

Compatible with MC4 range



Female and Male
Plug connectors

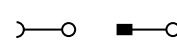

All plug references
All plug references

MC4 and MC4-Evo2 manufactured by Multi-Contact

Marketing material

<http://new.abb.com/low-voltage/connection>

HOME > PRODUCTS > LOW VOLTAGE PRODUCTS > CONNECTION DEVICES

GLOBAL SITE | Power and productivity for a better world | **ABB**

Connection devices

One of the largest connection offering on the market

ABB proposes one of the largest connection offering on the market with various technologies: screw, Pi-Spring, (Push-in and spring), spring, IDC, pluggable, stud... technologies found in over 8000 products and solutions.

Main benefits

- High quality products: benefit from the best connection.
- Simplification and acceleration of flows: reliable expertise in delivery times.
- Innovating for tomorrow's solutions.
- Perfect connection reliability in response to all connection challenges.

Main features

- Connecting capacity: from 0.22 to 300 mm² (22AWG to 1000kcmil).
- Large offering covering all applications and functions.
- Worldwide availability.
- Exclusive solutions and technologies like ADO System® terminal blocks, ESSAILEC® test blocks, Interfast the pre-wiring system for PLC's.

Are you looking for support or purchase information?
[Contact us](#)

Our offering

<p>Connection devices SNK Series The innovative range available in Pi-Spring (Push-in and spring), screw clamp and pluggable technologies with common accessories. Link</p>	<p>Connection devices SNA Series The well known historical range is available in screw clamp and stud technologies with a large choice of sections and colours variants. Link</p>	<p>Connection devices Solution series Polyvalent range featuring: IDC, spring loaded, quick-connect technologies and specific solutions such as Interfast PLC's pre-wiring system, and ESSAILEC® CT & VT test blocks. Link</p>	<p>Markers and marking systems The markers and marking systems offering covers all the needs for electrical panel identification: markers and labels for terminal block, wire & cable, component & equipment... Link</p>
--	--	---	--

Our technologies

<p>Screw clamp technology The ABB screw clamp technology is designed to provide a reliable and safe connection and avoid accidental release due to vibrations, shocks or even abusive cable draw. Link</p>	<p>Pi-Spring (Push-in and spring) technology The patented design of ABB's Pi-Spring features the benefits of two technologies (Push-in and spring) in one connection. Link</p>	<p>Spring technology The ABB spring clamp technology offers connection flexibility with front entry connection Link</p>	<p>Spring loaded screw clamp technology The spring loaded technology is designed to guaranty electrical continuity even when screw are loosened unintentionally. Link</p>
--	--	---	---



Web site totally responsive

Tools

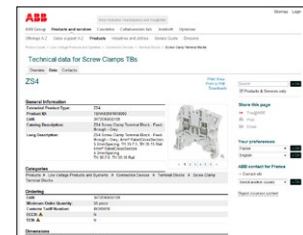

For product detailed information, use product type or order code, ex: www.abb.com/productdetails/ZS4 or www.abb.com/productdetails/1SNK505010R0000



Cadenas portal: Download 2D or 3D files according to your needs (STEP, IGES...)

Catalogs



Contact us

ABB France

Electrification Products Division

Low Voltage Products and Systems

3, rue Jean Perrin

F-69687 Chassieu cedex / France

You can find the address of your local sales organisation
on the ABB home page



<http://new.abb.com/low-voltage/connection>



<http://new.abb.com/low-voltage/products/connection-devices/solar>

Note

We reserve the right to make technical changes or modify the contents of this document without prior notice.

ABB does not accept any responsibility whatsoever for potential errors or possible lack of information in this document.

All MC4-Evo2 and MC4 images are exclusive property of Multi-Contact AG, and used with kind permission.

We reserve all rights in this document and in the subject matter and illustrations contained therein. Any reproduction, disclosure to third parties or utilization of its contents – in whole or in parts – is forbidden without prior written consent of ABB.

Copyright© 2016 ABB - All rights reserved