

POSITRONIC INDUSTRIES BELIEVES THE DATA ON THIS DRAWING TO BE RELIABLE. SINCE THE TECHNICAL INFORMATION IS GIVEN FREE OF CHARGE, THE USER EMPLOYS SUCH INFORMATION AT HIS OWN DISCRETION AND RISK. POSITRONIC INDUSTRIES ASSUMES NO RESPONSIBILITY FOR RESULTS OBTAINED OR DAMAGES INCURRED FROM USE OF SUCH INFORMATION IN WHOLE OR IN PART.

DATE	REV	REVISION RECORD	APP	DR	CK
2-12-04	NC	ECO 22003		ME	

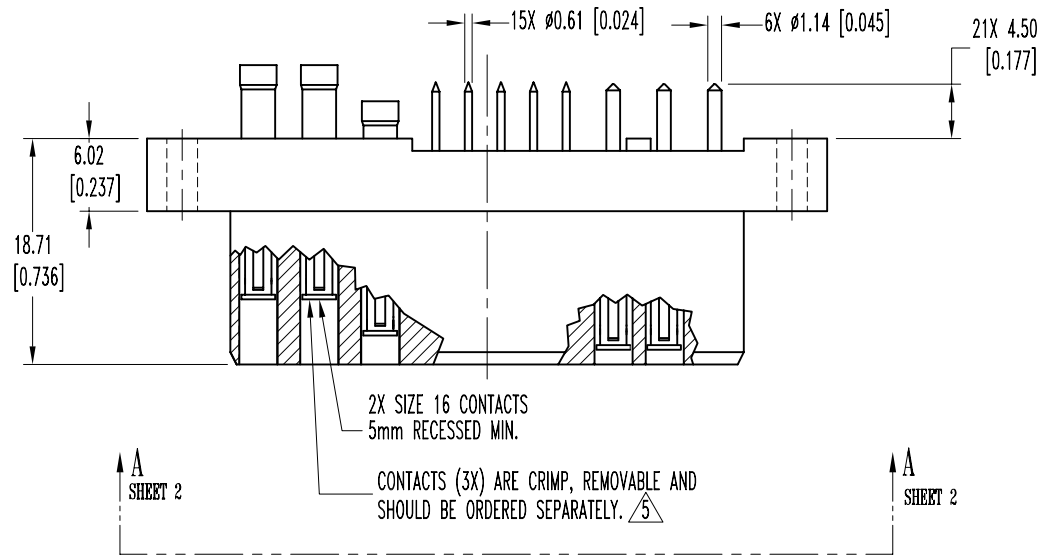
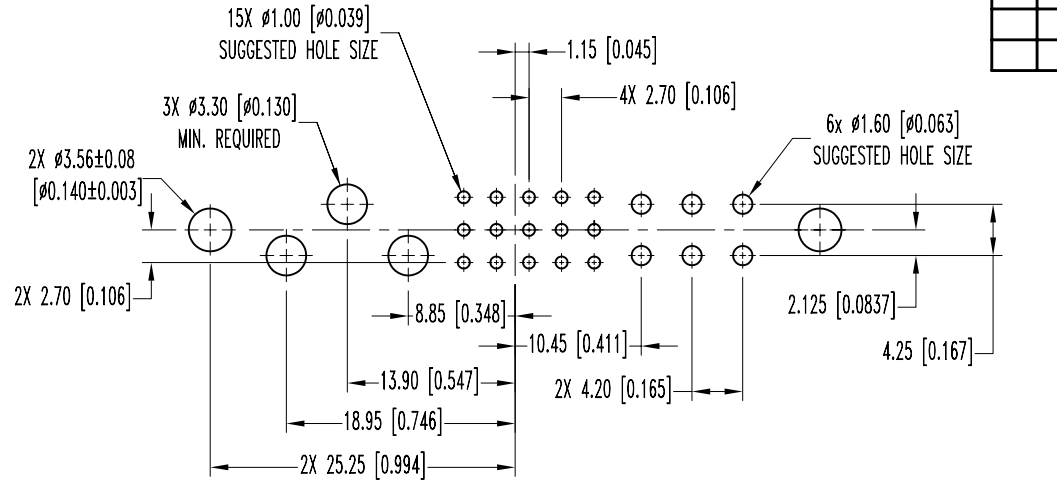

NOTES:

- MATERIALS AND FINISHES:**
 INSULATOR: GLASS FILLED POLYESTER, UL 94V-0. COLOR: BLUE.
 CONTACTS: HIGH CONDUCTIVITY PRECISION MACHINED COPPER ALLOY WITH GOLD FLASH OVER NICKEL.
- ELECTRICAL CHARACTERISTICS:**
 CONTACT CURRENT RATING:
 SIZE 16 POWER CONTACTS:
 POSITIONS 1-6: 35 AMPERES CONTINUOUS, ALL CONTACTS UNDER LOAD.
 SIZE 22 SIGNAL CONTACTS: 3 AMPERES NOMINAL.
 INITIAL CONTACT RESISTANCE; PER IEC 512-2, TEST 2b.
 SIZE 16 CONTACT: 0.0007 OHMS MAXIMUM.
 SIZE 22 CONTACT: 0.004 OHMS MAXIMUM.
 INSULATOR RESISTANCE: 5 G OHMS PER IEC 512-2, TEST 3a.
 VOLTAGE PROOF:
 CONTACTS: 1 THROUGH 6: 1,500 V r.m.s.
 CONTACTS: 7 THROUGH 21: 1,000 V r.m.s.
- THIS MOS ALLOWS FOR CONNECTOR TO HAVE SPECIAL LOW PROFILE AC PASS THROUGH MOLDING.
- WORKING TEMPERATURE: -55°C TO +125°C.
- USE FC*N25-1565.0 CONTACTS ON CRIMP REMOVABLE POSITIONS, SEE CHART.
- DIMENSIONS ARE IN MILLIMETERS [INCHES].

PART NUMBER	WIRE SIZE mm ² / [awg]
FC112N2S-1565.0	4.0/[12]
FC114N2-1565.0	2.5-1.5/[14-16]
FC116N2-1565.0	1.5-1.0/[16-18]

POSITRONIC INDUSTRIES INC.
www.connectpositronic.com

 DECIMAL TOL. ± 0.38 [0.015]	PCI SERIES	SCALE N.T.S.	DRAWN BY M. ENEA
	TITLE PCIB24W9F300A1-246.5		
DATE 2-12-04	DRAWING NUMBER SK5299	SHEET 1 OF 2	REV. NC

POSITRONIC INDUSTRIES BELIEVES THE DATA ON THIS DRAWING TO BE RELIABLE. SINCE THE TECHNICAL INFORMATION IS GIVEN FREE OF CHARGE, THE USER EMPLOYS SUCH INFORMATION AT HIS OWN DISCRETION AND RISK. POSITRONIC INDUSTRIES ASSUMES NO RESPONSIBILITY FOR RESULTS OBTAINED OR DAMAGES INCURRED FROM USE OF SUCH INFORMATION IN WHOLE OR IN PART.

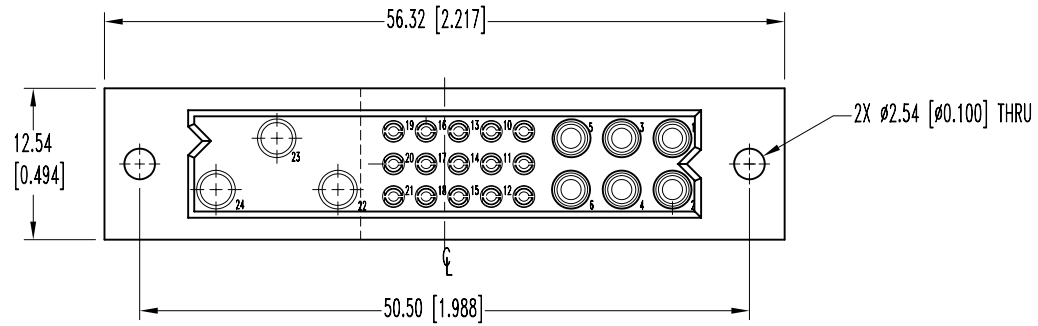

VIEW A-A