

PCMR

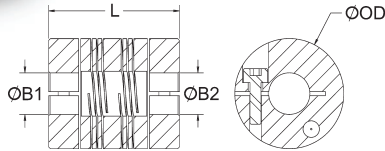

PSMR

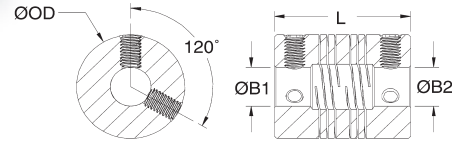

PART NUMBER		SPECIFICATIONS						PERFORMANCE				
CLAMP STYLE	SET SCREW STYLE	BORES B1, B2 (mm)	OUTER DIAM OD (mm)	LENGTH L (mm) (PCMR/PSMR)	CAP SCREW (PCMR)	SET SCREW (PSMR)	SHAFT PENETRATION (in)	STATIC TORQUE (Nm)	TORSIONAL STIFFNESS (Deg/Nm)	MISALIGNMENT		MOMENT OF INERTIA (x10 ⁶ kg-m ²)
										PARALLEL (mm)	AXIAL MOTION (mm)	
PCMR10	PSMR10	3	9.5	14.3	M1.6	M2	6.73	0.62	11.83	0.203	0.127	0.029
PCMR13	PSMR13	3	12.7	19.1	M2	M2	9.05	0.90	6.66	0.203	0.127	0.117
		3						1.70	3.21			
PCMR16	PSMR16	4	15.9	20.3	M2	M3	9.57	1.36	4.78	0.203	0.127	0.322
		5						1.36	4.78			
		3						2.94	1.57			
PCMR19	PSMR19	4	19.1	22.9	M2.5	M4	10.73	1.92	2.27	0.203	0.127	0.731
		5						1.92	2.27			
		6						1.58	2.90			
		5						2.26	1.49			
PCMR22	PSMR22	6	22.2	27.0	M3	M4	12.69	2.03	1.88	0.203	0.127	1.639
		7						1.81	2.43			
		8						1.81	2.43			
		6						4.07	1.41			
PCMR25	PSMR25	7	25.4	31.8	M4	M4	14.69	4.07	1.41	0.381	0.254	3.394
		8						3.73	1.57			
		9						3.39	1.80			
		6						5.31	0.86			
		7						5.31	0.86			
		8						4.97	0.94			
PCMR29	PSMR29	9	28.6	38.1	M4	M5	17.65	4.52	1.25	0.381	0.254	6.349
		10						4.52	1.25			
		11						3.84	1.96			
		12						3.84	1.96			
		6						7.68	0.53			
		7						7.68	0.53			
		8						7.23	0.53			
PCMR32	PSMR32	9	31.8	38.1	M4	M6	17.65	6.78	0.53	0.381	0.254	9.948
		10						6.78	0.62			
		11						5.88	1.10			
		12						5.88	1.10			

- Note 1** Static torque ratings are at maximum misalignment. To obtain dynamic rating, static ratings should be divided by 2 for non-reversing applications and by 4 for reversing applications.
- Note 2** Hardware is alloy steel with black oxide finish. PCMR series parts have socket head cap screws on each end. Parts PSMR10 through PSMR19 have one set screw on each end. PSMR22 through PSMR32 have two set screws 120° apart.
- Note 3** Performance ratings are for guidance only. The user must determine suitability for a particular application.
- Note 4** Coupling torque and torsional stiffness are determined by the largest bore selected.
- Note 5** Angular misalignment on all couplings is 3°.
- Note 6** Shafts may penetrate up to 0.5 x L. Be certain shafts do not touch.
- Note 7** Maximum speed 6,000 RPM.

FOR ENGINEERING AND WARRANTY INFORMATION SEE WWW.RULAND.COM