

619/8-2RS1

Dimensions

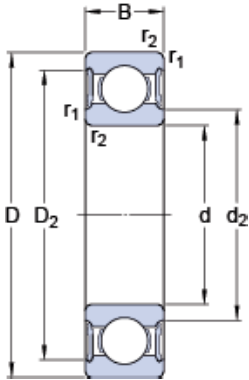

d	8	mm
D	19	mm
B	6	mm
d ₂	≈ 9.8	mm
D ₂	≈ 16.66	mm
r _{1,2}	min. 0.3	mm

Abutment dimensions

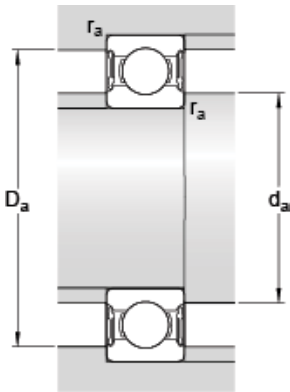

d _a	min. 9.5	mm
d _a	max. 9.8	mm
D _a	max. 17	mm
r _a	max. 0.3	mm

Calculation data

Basic dynamic load rating	C	1.46	kN
Basic static load rating	C ₀	0.465	kN
Fatigue load limit	P _u	0.02	kN
Limiting speed		24000	r/min
Calculation factor	k _r	0.02	
Calculation factor	f ₀	6.6	

Mass

Mass bearing	0.0071	kg
--------------	--------	----