

TIMKEN

The Timken Company
 4500 Mt Pleasant St. NW
 N. Canton, OH 44720
 Phone: (234) 262-3000
 E-Mail: CustomerCAD@timken.com • Web site: www.timken.com

Timken Part Number 37425 - 37625, Tapered Roller Bearings - TS (Tapered Single) Imperial

This is the most basic and most widely used type of tapered roller bearing. It consists of two main separable parts: the cone (inner ring) assembly and the cup (outer ring). It is typically mounted in opposing pairs on a shaft.



[Specifications](#) | [Dimensions](#) | [Abutment and Fillet Dimensions](#) | [Basic Load Ratings](#) | [Factors](#)

Specifications

Series	37000
Cone Part Number	37425
Cup Part Number	37625
Design Units	Imperial
Bearing Weight	1.400 Kg 3.00 lb
Cage Type	Stamped Steel

Dimensions

d - Bore	107.95 mm 4.25 in
D - Cup Outer Diameter	158.750 mm 6.2500 in

B - Cone Width	21.438 mm 0.8440 in
C - Cup Width	15.875 mm 0.6250 in
T - Bearing Width	23.020 mm 0.9063 in

Abutment and Fillet Dimensions

R - Cone Backface "To Clear" Radius¹	3.560 mm 0.14 in
r - Cup Backface "To Clear" Radius²	3.30 mm 0.130 in
da - Cone Frontface Backing Diameter	115.06 mm 5.32 in
db - Cone Backface Backing Diameter	121.92 mm 4.8 in
Da - Cup Frontface Backing Diameter	151.90 mm 6.00 in
Db - Cup Backface Backing Diameter	143.00 mm 5.63 in
Ab - Cage-Cone Frontface Clearance	3.8 mm 0.15 in
Aa - Cage-Cone Backface Clearance	2 mm 0.08 in
a - Effective Center Location³	13.70 mm 0.54 in

Basic Load Ratings

C90 - Dynamic Radial Rating (90 million revolutions)⁴	35400 N 7960 lbf
C1 - Dynamic Radial Rating (1 million revolutions)⁵	137000 N 30700 lbf
C0 - Static Radial Rating	179000 N 40100 lbf
C_{a90} - Dynamic Thrust Rating (90 million revolutions)⁶	36700 N 8250 lbf

Factors

K - Factor⁷	0.96
e - ISO Factor⁸	0.61
Y - ISO Factor⁹	0.99
G1 - Heat Generation Factor (Roller-Raceway)	124
G2 - Heat Generation Factor (Rib-Roller End)	57
Cg - Geometry Factor	0.144

¹ These maximum fillet radii will be cleared by the bearing corners.

² These maximum fillet radii will be cleared by the bearing corners.

³ Negative value indicates effective center inside cone backface.

⁴ Based on 90×10^6 revolutions L_{10} life, for The Timken Company life calculation method. C_{90} and C_{a90} are radial and thrust values.

⁵ Based on 1×10^6 revolutions L_{10} life, for the ISO life calculation method.

⁶ Based on 90×10^6 revolutions L_{10} life, for The Timken Company life calculation method. C_{90} and C_{a90} are radial and thrust values for a single-row, $C_{90(2)}$ is the two-row radial value.

⁷ These factors apply for both inch and metric calculations. Consult your Timken representative for instruction on use.

⁸ These factors apply for both inch and metric calculations. Consult your Timken representative for instruction on use.

⁹ These factors apply for both inch and metric calculations. Consult your Timken representative for instruction on use.

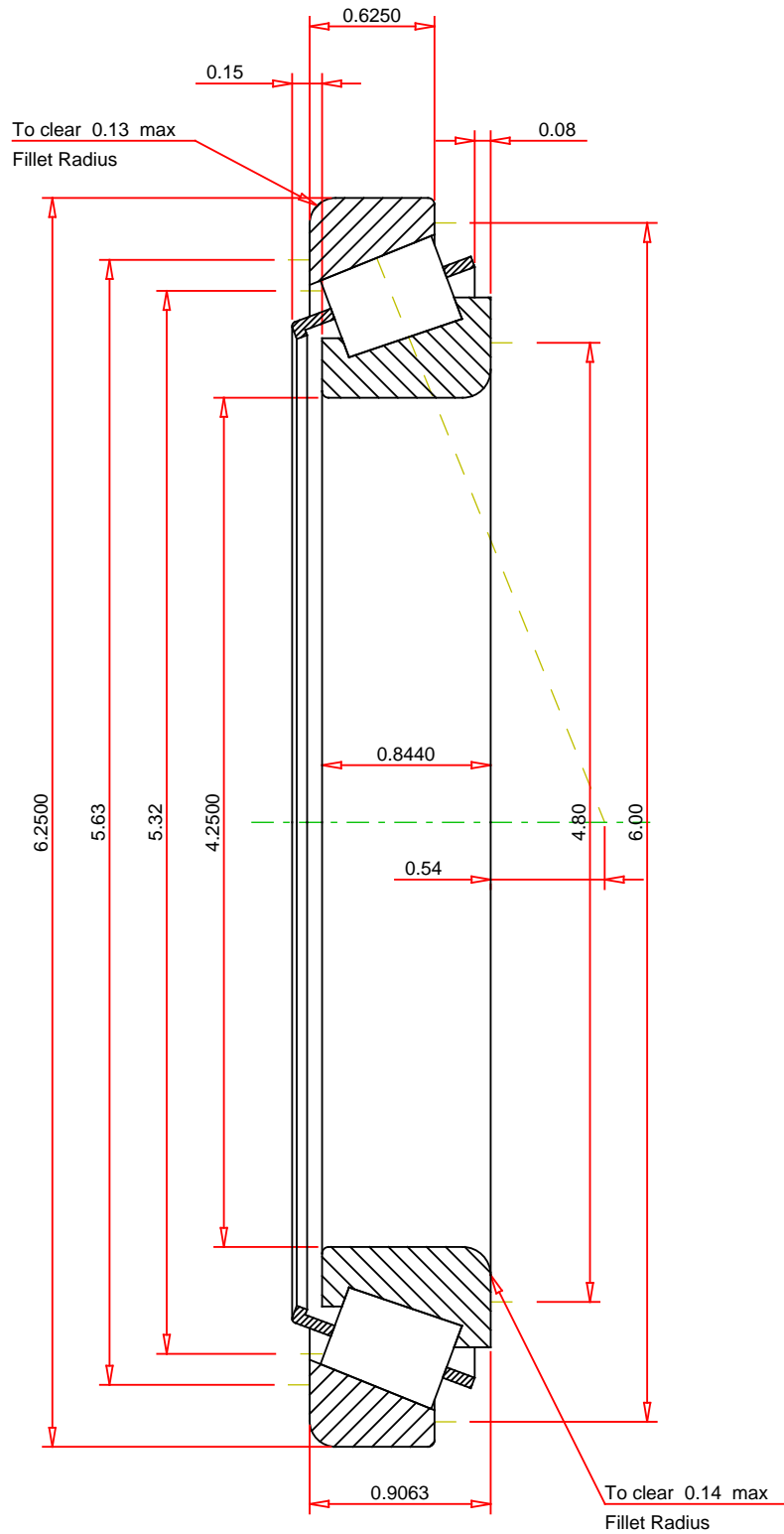

IMPERIAL UNITS

ISO Factor - e	0.61
ISO Factor - Y	0.99
Bearing Weight	3 lb
Number of Rollers Per Row	32
Effective Center Location	0.54 inch

TIMKEN®

37425 - 37625
TS BEARING ASSEMBLY

THE TIMKEN COMPANY
NORTH CANTON, OHIO USA

K Factor	0.96
Dynamic Radial Rating - C90	35400 lbf
Dynamic Thrust Rating - Ca90	36700 lbf
Static Radial Rating - C0	179000 lbf
Dynamic Radial Rating - C1	137000 lbf

Every reasonable effort has been made to ensure the accuracy of the information contained in this writing, but no liability is accepted for errors, omissions or for any other reason.

FOR DISCUSSION ONLY