

# Connectors – mounting plates

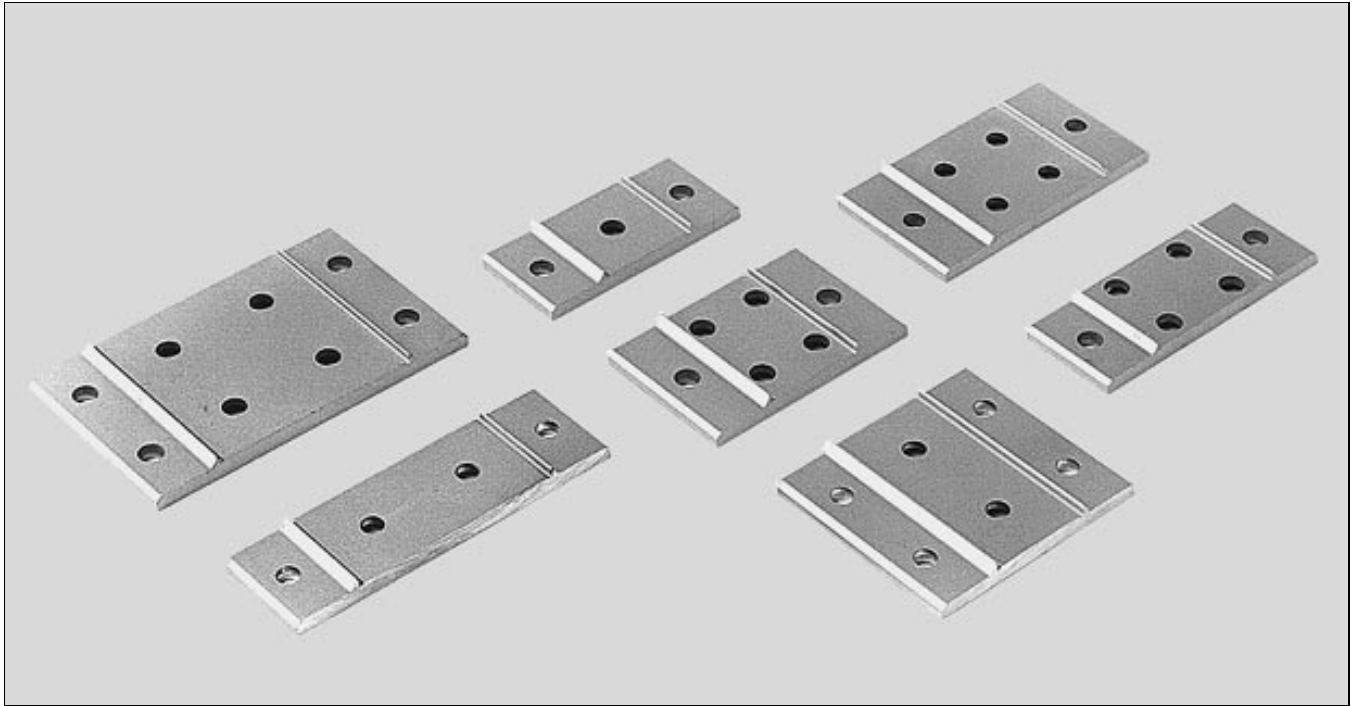

## Description

Mounting plates XCFB .. are used for mounting beam ends against beam sides. The holes in the end of the beam cross-section must be de-burred and threaded, (M8 roller threading). The mounting plate fits over the beam end and is secured with screws. Mounting plates must be used for double-sided assembly only.

\*Note. M8 roller threading. It is also possible to use a selftapping screw (MF6S-TT 8×30, see catalogue section *Fasteners*). In this case, no threading is required.

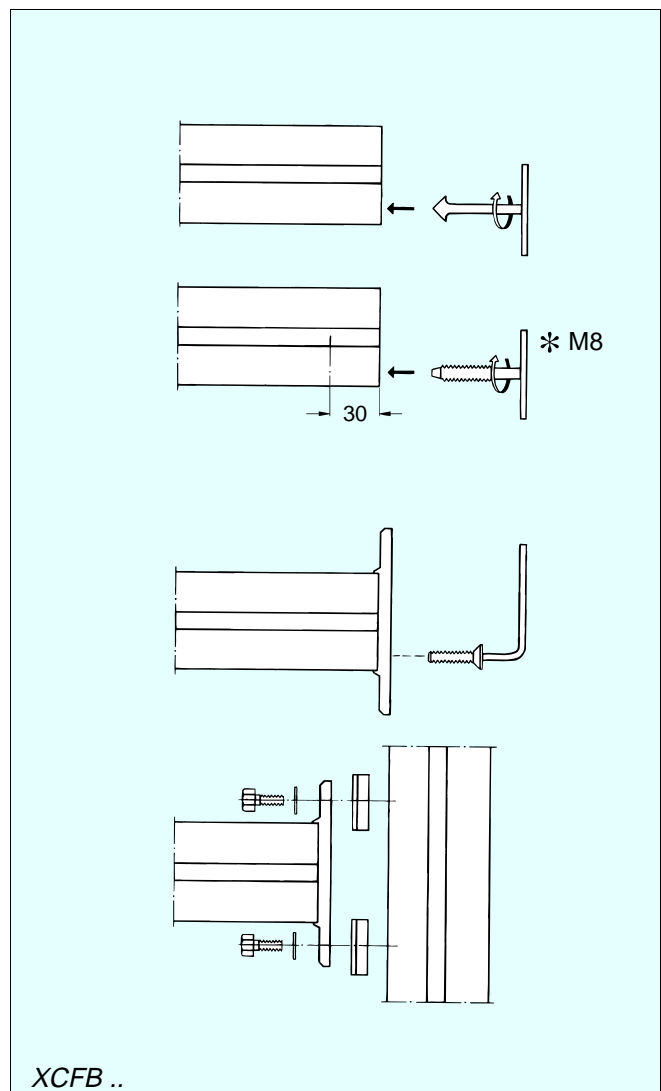

XCFB ..

## Mounting plates

### XCFB 88

Mounting plate  
Aluminium, anodized  
Mounting:  
M6S 8×18 (4)  
BRB 8,4×16 (4)  
XCAN 8 (4)  
MF6S 8×30 (4)

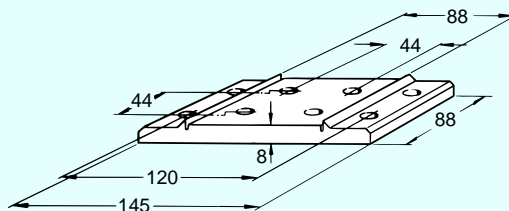

### XCFB 44×88 A

Mounting plate  
Aluminium, anodized  
Mounting:  
M6S 8×18 (2)  
BRB 8,4×16 (2)  
XCAN 8 (2)  
MF6S 8×30 (2)

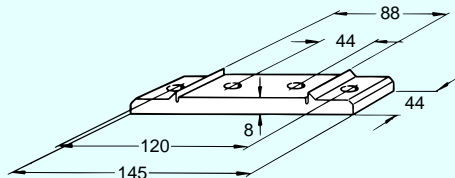

### XCFB 44×88 B

Mounting plate  
Aluminium, anodized  
Mounting:  
M6S 8×18 (4)  
BRB 8,4×16 (4)  
XCAN 8 (4) +  
MF6S 8×30 (2)

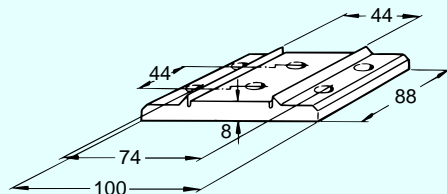

### XCFB 64 A

Mounting plate  
Aluminium, anodized  
Mounting:  
M6S 8×18 (2)  
BRB 8,4×16 (2)  
XCAN 8 (2) +  
MF6S 8×30 (4)

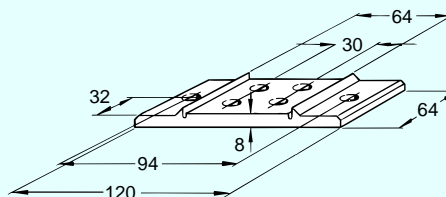

### XCFB 44×64 A

Mounting plate  
Aluminium, anodized  
Mounting:  
M6S 8×18 (2)  
BRB 8,4×16 (2)  
XCAN 8 (2) +  
MF6S 8×30 (4)

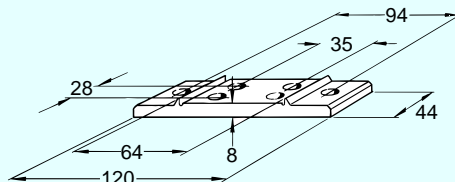

### XCFB 44×64 B

Mounting plate  
Aluminium, anodized  
Mounting:  
M6S 8×18 (2)  
BRB 8,4×16 (2)  
XCAN 8 (2) +  
MF6S 8×30 (4)

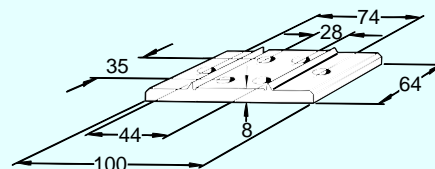

### XCFB 44

Mounting plate  
Aluminium, anodized  
Mounting:  
M6S 8×18 (2)  
BRB 8,4×16 (2)  
XCAN 8 (2) +  
MF6S 8×30 (1)

