

# MXA SERIES

## MXA ALUMINIUM MOBILE ENCLOSURE

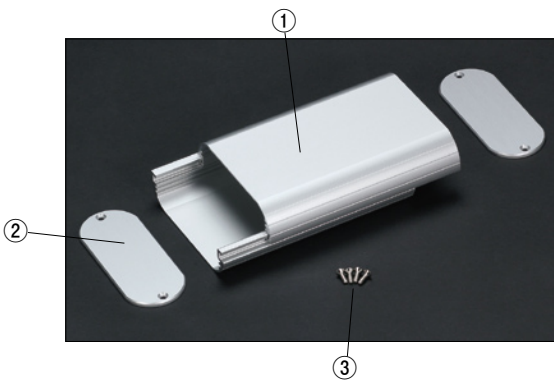

### FEATURE

- Colorful combination of the aluminum extrusion body and end panels are selectable in 14 types. Choose a suitable one according to your individual application in 30 sizes and in 14 color combinations.
- Digital audio amplifiers, communication devices, measurement tools, and so on, it is the best enclosure for any kind of portable devices.
- P.C. boards are able to mount horizontally by sliding into the enclosure.

### Components

| Ref. # | Part name          | Pcs | Material            | Color / Finish                           |
|--------|--------------------|-----|---------------------|--|
| 1      | Frame              | 2   | Aluminium extrusion | Silver - Black / Anodized                |
| 2      | Panel              | 2   | Aluminium t3.0      | Anodized / Hair-line finish              |
| 3      | Self-tapping screw | 4   | Steel               | Nickel plated · Black trivalent chromate |

### Color Code

Selectable in 14 color combinations listed below.

|   |   |   |   |  |   |   |
|---|---|---|---|--|---|---|
|  |  |  |  |  |  |  |
| Black / Black<br><b>B B</b>   | Black / Silver<br><b>B S</b>  | Black / Cobalt blue<br><b>B C</b>   | Black / Green<br><b>B G</b>   | Black / Purple<br><b>B P</b>   | Black / Orange<br><b>B O</b>  | Black / Red<br><b>B R</b>   |
|  |  |  |  |  |  |  |
| Silver / Black<br><b>S B</b>  | Silver / Silver<br><b>S S</b>   | Silver / Cobalt blue<br><b>S C</b>  | Silver / Green<br><b>S G</b>  | Silver / Purple<br><b>S P</b>  | Silver / Orange<br><b>S O</b>   | Silver / Red<br><b>S R</b>  |

**MXA Dimensions**

• CAD data is downloadable from our web.

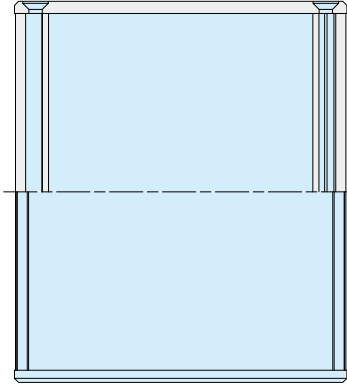

• Refer to the page 103 to 106 for the panel and frame detail.

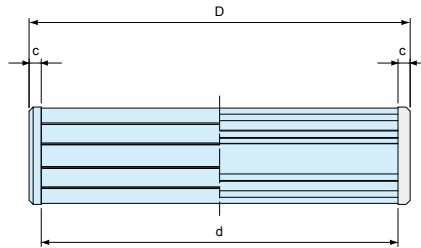
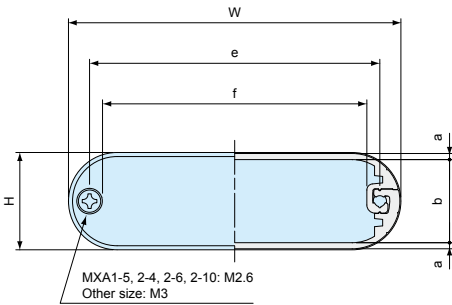

Please request / order by indicating the combination part number as below.

**MXA 1 - 5 - 6** □ □ □  
Color code Screw P or H

**Screw Type**

| P         | H                |
|-----------|------------------|
|           |                  |
| Plus head | Hexalobular head |

**Part no. / Dimensions**

| Part no.      | H  | W   | D   | a    | b    | c | d   | e     | f     | Weight(g) |
|---------------|----|-----|-----|------|------|---|-----|-------|-------|-----------|
| MXA1-5- 5□□□  | 13 | 48  | 49  | 1.2  | 10.2 | 3 | 43  | 38.8  | 33.6  | 25        |
| MXA1-5- 8□□□  | 13 | 48  | 79  | 1.2  | 10.2 | 3 | 73  | 38.8  | 33.6  | 40        |
| MXA1-5- 11□□□ | 13 | 48  | 109 | 1.2  | 10.2 | 3 | 103 | 38.8  | 33.6  | 55        |
| MXA2-4- 4□□□  | 15 | 41  | 44  | 1.2  | 12.2 | 3 | 38  | 31.8  | 26.6  | 25        |
| MXA2-4- 7□□□  | 15 | 41  | 74  | 1.2  | 12.2 | 3 | 68  | 31.8  | 26.6  | 40        |
| MXA2-4- 10□□□ | 15 | 41  | 104 | 1.2  | 12.2 | 3 | 98  | 31.8  | 26.6  | 50        |
| MXA2-6- 5□□□  | 18 | 57  | 46  | 1.2  | 15.1 | 3 | 40  | 47.7  | 42.5  | 35        |
| MXA2-6- 7□□□  | 18 | 57  | 71  | 1.2  | 15.1 | 3 | 65  | 47.7  | 42.5  | 50        |
| MXA2-6- 10□□□ | 18 | 57  | 96  | 1.2  | 15.1 | 3 | 90  | 47.7  | 42.5  | 65        |
| MXA2-7- 5□□□  | 20 | 70  | 54  | 1.5  | 16.5 | 3 | 48  | 59.6  | 53.2  | 55        |
| MXA2-7- 8□□□  | 20 | 70  | 84  | 1.5  | 16.5 | 3 | 78  | 59.6  | 53.2  | 80        |
| MXA2-7- 11□□□ | 20 | 70  | 114 | 1.5  | 16.5 | 3 | 108 | 59.6  | 53.2  | 110       |
| MXA2-8- 6□□□  | 24 | 82  | 64  | 1.5  | 20.5 | 3 | 58  | 71.6  | 65.2  | 75        |
| MXA2-8- 9□□□  | 24 | 82  | 94  | 1.5  | 20.5 | 3 | 88  | 71.6  | 65.2  | 105       |
| MXA2-8- 12□□□ | 24 | 82  | 124 | 1.5  | 20.5 | 3 | 118 | 71.6  | 65.2  | 135       |
| MXA2-10- 7□□□ | 16 | 100 | 74  | 1.2  | 13.2 | 3 | 68  | 90.8  | 85.6  | 70        |
| MXA2-10-10□□□ | 16 | 100 | 104 | 1.2  | 13.2 | 3 | 98  | 90.8  | 85.6  | 100       |
| MXA2-10-14□□□ | 16 | 100 | 144 | 1.2  | 13.2 | 3 | 138 | 90.8  | 85.6  | 135       |
| MXA3-11- 7□□□ | 30 | 110 | 72  | 1.5  | 26.5 | 3 | 66  | 99.6  | 93.2  | 115       |
| MXA3-11-11□□□ | 30 | 110 | 112 | 1.5  | 26.5 | 3 | 106 | 99.6  | 93.2  | 165       |
| MXA3-11-16□□□ | 30 | 110 | 162 | 1.5  | 26.5 | 3 | 156 | 99.6  | 93.2  | 235       |
| MXA4-7- 5□□□  | 35 | 70  | 52  | 1.55 | 31.4 | 3 | 46  | 59.6  | 53.2  | 70        |
| MXA4-7- 8□□□  | 35 | 70  | 82  | 1.55 | 31.4 | 3 | 76  | 59.6  | 53.2  | 100       |
| MXA4-7- 11□□□ | 35 | 70  | 112 | 1.55 | 31.4 | 3 | 106 | 59.6  | 53.2  | 135       |
| MXA4-10- 7□□□ | 40 | 95  | 70  | 1.55 | 36.4 | 3 | 64  | 84.6  | 78.2  | 120       |
| MXA4-10-11□□□ | 40 | 95  | 110 | 1.55 | 36.4 | 3 | 104 | 84.6  | 78.2  | 175       |
| MXA4-10-14□□□ | 40 | 95  | 140 | 1.55 | 36.4 | 3 | 134 | 84.6  | 78.2  | 220       |
| MXA4-13- 9□□□ | 35 | 130 | 90  | 1.75 | 31   | 3 | 84  | 119.6 | 113.2 | 180       |
| MXA4-13-14□□□ | 35 | 130 | 140 | 1.75 | 31   | 3 | 134 | 119.6 | 113.2 | 265       |
| MXA4-13-20□□□ | 35 | 130 | 200 | 1.75 | 31   | 3 | 194 | 119.6 | 113.2 | 370       |

**MX · MXA Component parts drawing**

**MX · MXA Frame**

MX / MXA 1-5-□

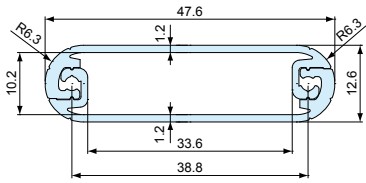

MX / MXA 2-8-□

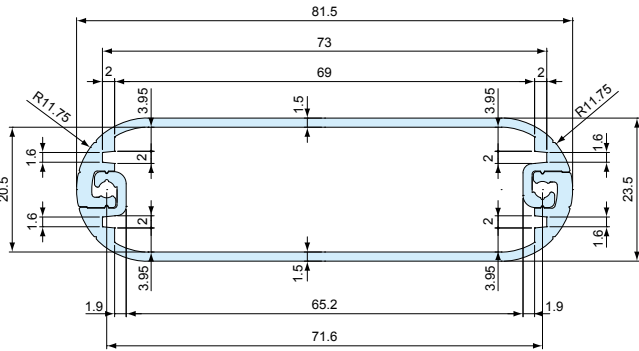

MX / MXA 2-4-□

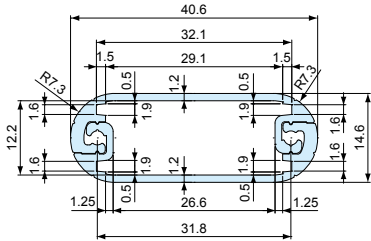

MX / MXA 2-10-□

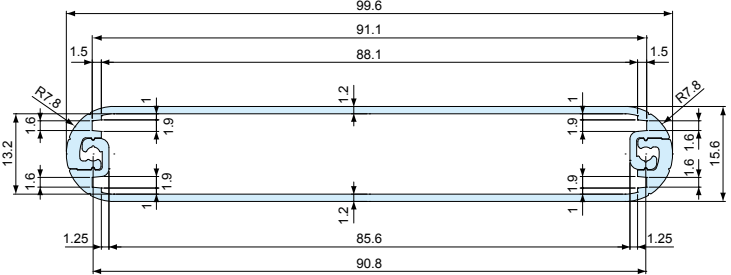

MX / MXA 2-6-□

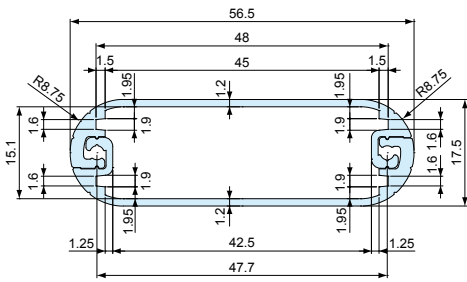

MX / MXA 3-11-□

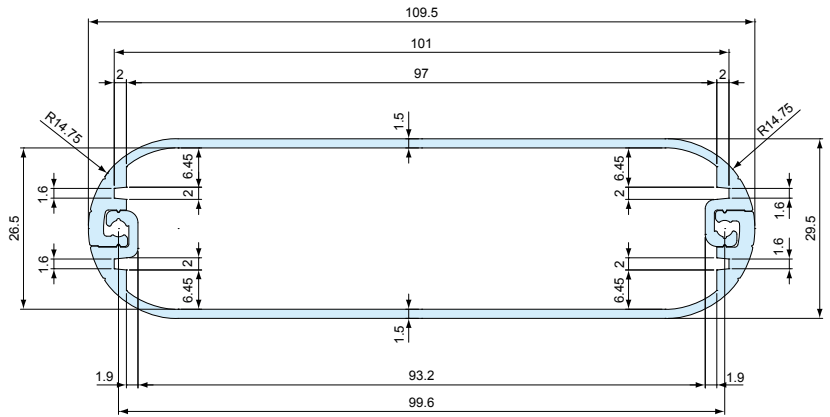

MX / MXA 2-7-□

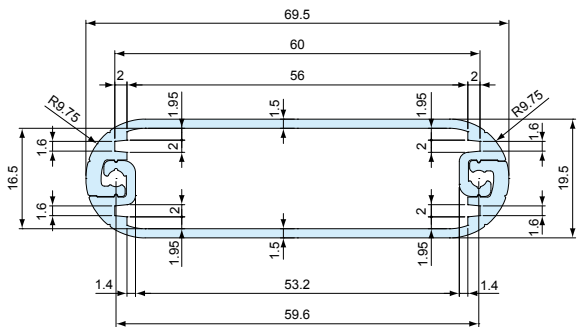

MX / MXA 4-7-□

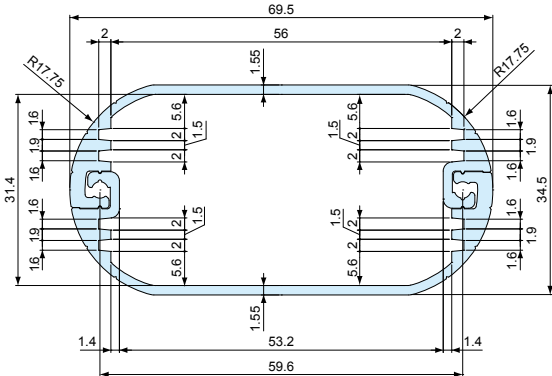



# MXA Component parts drawing

## MXA Panel

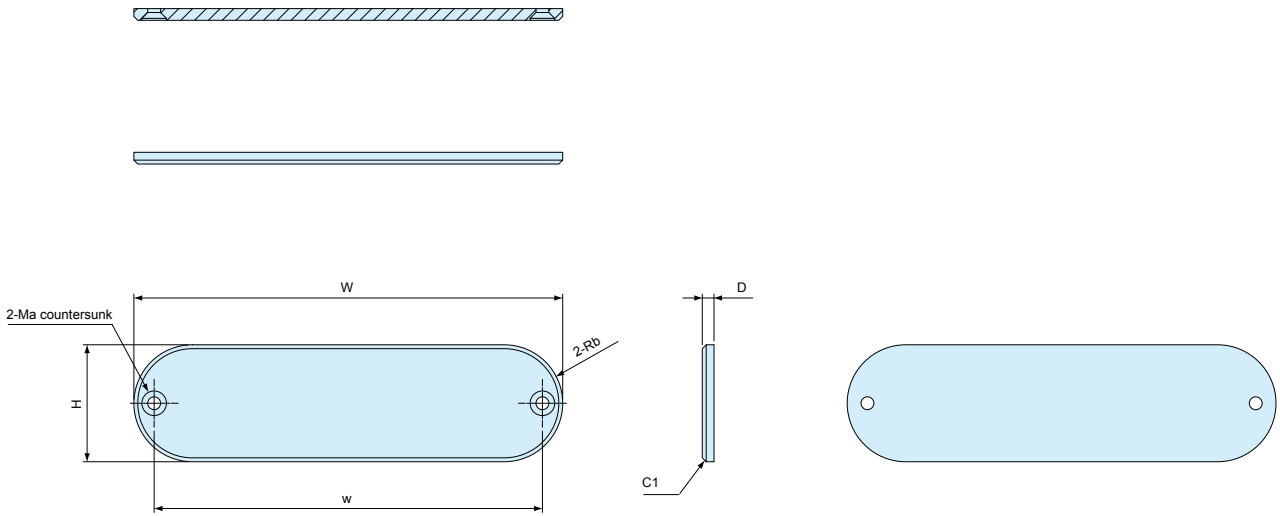

| Part no.  | W   | H  | D | w     | a   | b    |
|-----------|-----|----|---|-------|-----|------|
| MXA1- 5-□ | 48  | 13 | 3 | 38.8  | 2.6 | 6.5  |
| MXA2- 4-□ | 41  | 15 | 3 | 31.8  | 2.6 | 7.5  |
| MXA2- 6-□ | 57  | 18 | 3 | 47.7  | 2.6 | 9    |
| MXA2- 7-□ | 70  | 20 | 3 | 59.6  | 3   | 10   |
| MXA2- 8-□ | 82  | 24 | 3 | 71.6  | 3   | 12   |
| MXA2-10-□ | 100 | 16 | 3 | 90.8  | 2.6 | 8    |
| MXA3-11-□ | 110 | 30 | 3 | 99.6  | 3   | 15   |
| MXA4- 7-□ | 70  | 35 | 3 | 59.6  | 3   | 18   |
| MXA4-10-□ | 95  | 40 | 3 | 84.6  | 3   | 20.5 |
| MXA4-13-□ | 130 | 35 | 3 | 119.6 | 3   | 17.5 |

# MX·MXA SERIES

## APPLICATION EXAMPLE

### Desk-top audio preamplifier with USB port



MXA Mobile enclosure has a beautiful and elegant looking finish. It is dressed up with the hair-line anodized on the body surface, and a taper grinding finish on the end-panel edges. It is best for the stylish and high class audio device or amplifier.

#### Application

Compact desk-top audio amplifier makes a super powerful audio system if connecting to your PC. USB power supply is ready, and take your music anywhere. Moreover, you can connect iPod/iPad or portable players to this amplifier, and output to a variety of audio equipment. It build up your original audio system flexibly, and make your music life free.

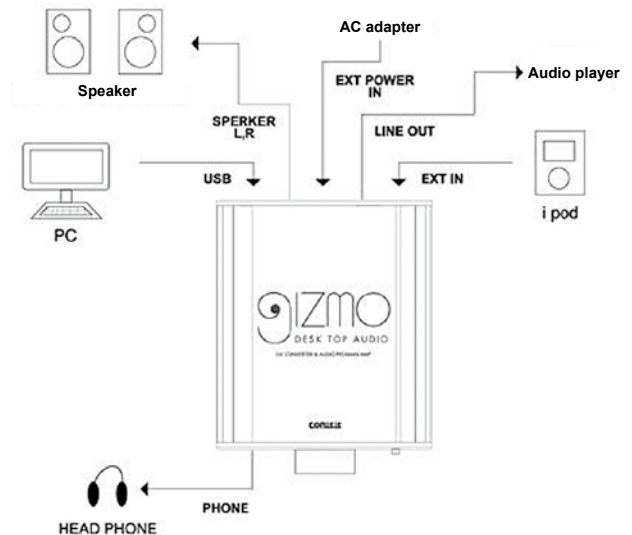

### USB audio adapter built-in headphone amplifier



#### Application

High quality HD USB audio amplifier which is a ready-to-assemble type. RCA analog connectors are ready in rear. You can enjoy your music on PC via a USB to RCA connector.

## Model railroad controller



### Application

High efficiency performance controller which makes you feel real driving.  
By using of the high and low RF signals, it makes your operation smoothly.

## CUSTOMIZING

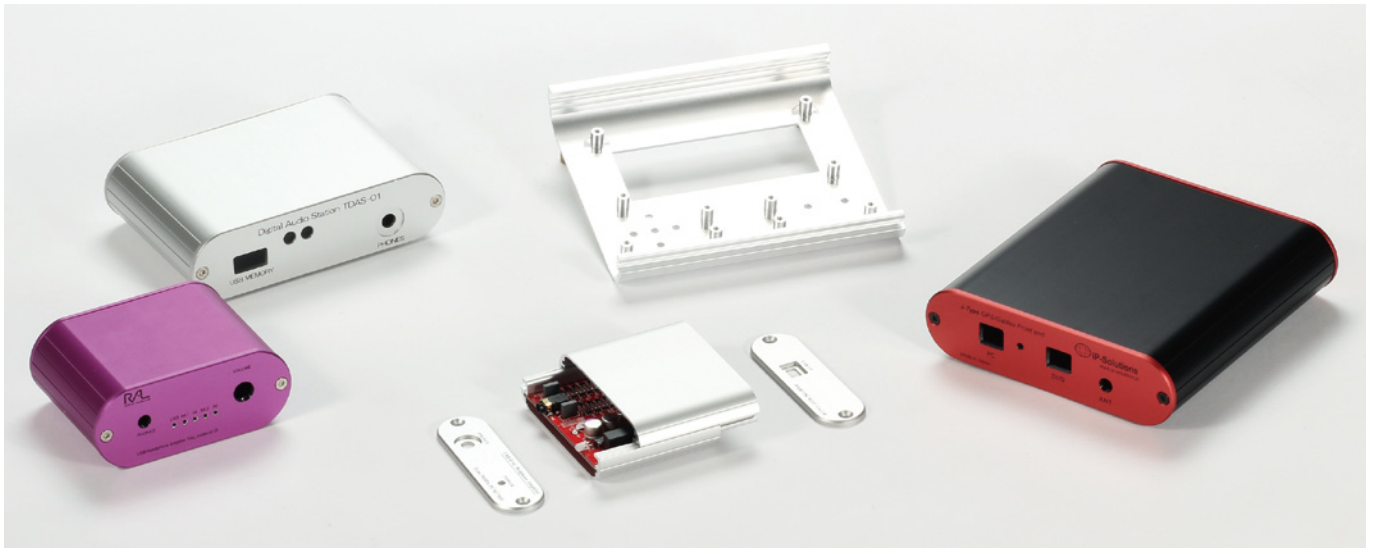

We take care of milling, silk-screening, sculpturing, colored anodizing, painting works and so on, from 1 unit with a quick delivery.

### Customize available



Contact us with your drawing

E-mail : [overseas@takachi-el.co.jp](mailto:overseas@takachi-el.co.jp)