

The distinguishing feature of Rittal Industrial Workstations is their flexible construction. Various possible combinations of individual components are illustrated below.



17" monitor housing
Model No. IW 6902.510

21" monitor housing
Model No. IW 6902.500



Feet
for monitor housing
Model No. IW 6902.610

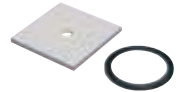

Spacer plate
Model No. IW 6902.630

Turntable
Model No. IW 6902.620

See page 16/17



Roof
solid
Model No. IW 6902.400



Worktop
small, solid
Model No. IW 6902.300

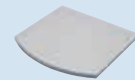

Worktop
solid
Model No. IW 6902.100

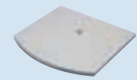

Worktop
prepared for turntable
Model No. IW 6902.110



Enclosure based on TS
Width 600 mm
Depth 600 mm

See page 12/13



Designer door, rear panel screw-fastened from the inside
Height 900 mm
Model No. IW 6900.000



Designer door, rear panel screw-fastened from the outside
Height 1000 mm
Model No. IW 6901.000



Designer door, rear door
Height 900 mm
Model No. IW 6900.100



Glazed door, rear door
Height 900 mm
Model No. IW 6900.200

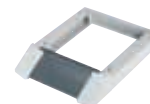

Stationary base/plinth
Model No. PC 8800.920



Twin castors
Model No. PC 4634.500

IW – VERSATILITY THROUGH MODULARITY



Optipanel
Custom made for TFT monitors or other display and input units



CP-L support arm system



Enclosure attachment tilting
Model No. IW 6902.640

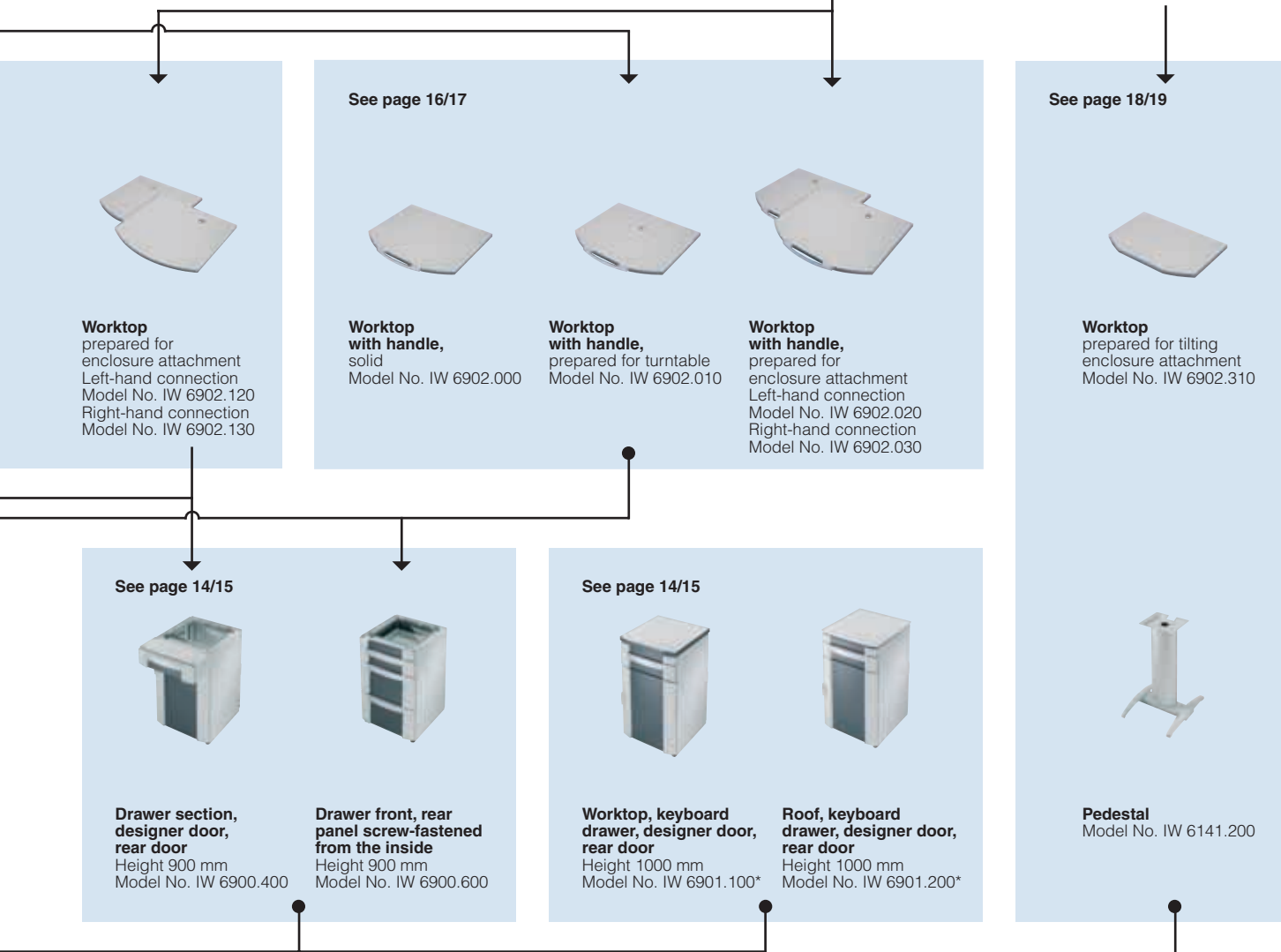

Worktop
prepared for enclosure attachment
Left-hand connection
Model No. IW 6902.120
Right-hand connection
Model No. IW 6902.130

See page 16/17

Worktop with handle, solid
Model No. IW 6902.000

Worktop with handle, prepared for turntable
Model No. IW 6902.010

Worktop with handle, prepared for enclosure attachment
Left-hand connection
Model No. IW 6902.020
Right-hand connection
Model No. IW 6902.030

See page 18/19

Worktop
prepared for tilting enclosure attachment
Model No. IW 6902.310

See page 14/15

Drawer section, designer door, rear door
Height 900 mm
Model No. IW 6900.400

Drawer front, rear panel screw-fastened from the inside
Height 900 mm
Model No. IW 6900.600

See page 14/15

Worktop, keyboard drawer, designer door, rear door
Height 1000 mm
Model No. IW 6901.100*

Roof, keyboard drawer, designer door, rear door
Height 1000 mm
Model No. IW 6901.200*

Pedestal
Model No. IW 6141.200

*The fitted variants IW 6901.100 (with worktop) and IW 6901.200 (with roof) are also available with other worktops on request.



Twin castors
Model No. PC 4634.500

Designer door, rear panel screw-fastened from the inside

Designer door, rear panel screw-fastened from the outside

Designer door, rear door

Glazed door, rear door

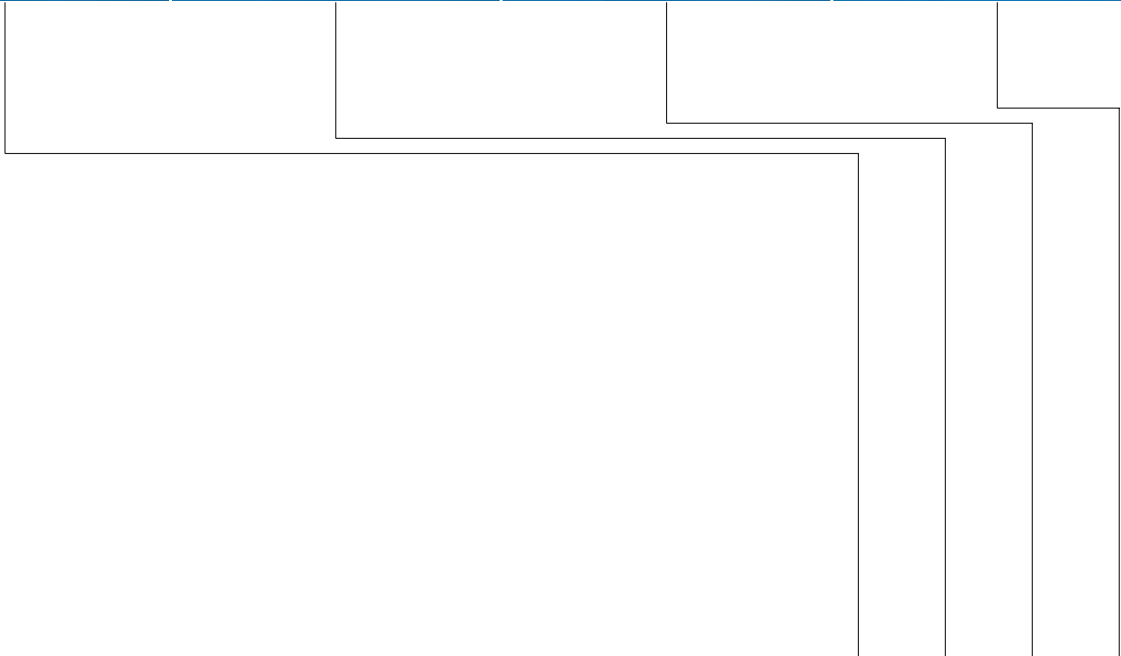

		Model No. IW	Width 600 mm Depth 600 mm	6900.000	6901.000	6900.100	6900.200
		Height mm		900	1000	900	900
		Weight kg		54.9	59.8	59.9	60.6

Supply includes	Design	Material	Colour				
Enclosure	Frame structure with side panels, screw-fastened from the inside	Sheet steel 1.5 mm	Textured RAL 7035 (light grey)	●	●	●	●
	Base with gland plate for cable entry						
	Levelling feet to compensate floor irregularities						
Designer door	Vertical bars with locking rod and double-bit insert, hinged on right-hand side	Aluminium section	RAL 7035	●	●	●	
	Door or installation plate, folded	Sheet steel 1.5 mm	RAL 7015 (slate grey)				
Glazed door	Vertical decorative trim panels	Plastic to UL 94-V0	RAL 7035				●
	Glass with screen-printed mask	Safety glass ESG 4.0 mm	RAL 7015				
Rear panel	Screw-fastened from the inside	Sheet steel 1.5 mm	Textured RAL 7035	●			
	Screw-fastened from the outside				●		
Rear door	With locking rod and double-bit insert, hinged on the right-hand side	Sheet steel 1.5 mm	Textured RAL 7035			●	●

Lock systems:

Standard double-bit lock insert, may be exchanged for lock inserts or comfort handle, see Catalogue 30, page 936 – 938, with front door only in conjunction with handle adaptor PC 8611.300, see Catalogue 30, page 153.

IW ENCLOSURE WITH DOOR VARIANTS

A modern workstation: Consistent lines from top to bottom! Monitor housings and enclosures – each equipped with a glazed door – create a formal unit including base/plinth. The worktop with handle and monitor turntable are stylishly integrated.



Note:

- Other enclosure depths or heights, variable on a 25 mm pitch pattern,
- all IW components as well as system accessories can be supplied fully assembled.

IW accessories see page 26 onwards.

Detailed drawings see page 22.

IW worktops see page 16/17.

IW monitor and operating housings see page 20/21.

Worktop, keyboard drawer, designer door, rear door

Roof, keyboard drawer, designer door, rear door

Drawer section, designer door, rear door

Drawer front, rear panel screw-fastened from the inside

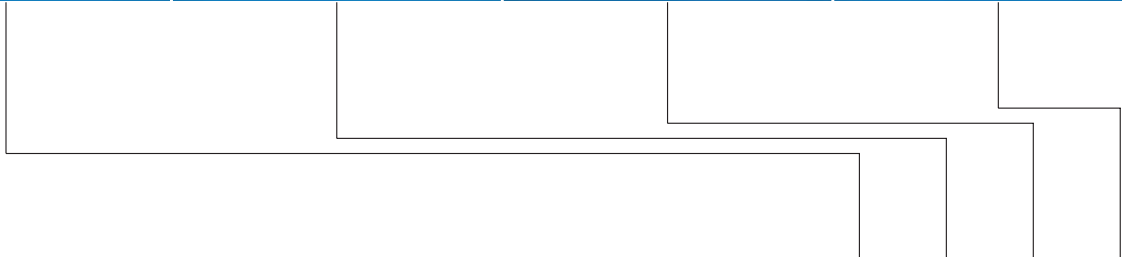

		Model No. IW	Width 600 mm Depth 600 mm	6901.100	6901.200	6900.400	6900.600
		Height mm		1000	1000	900	900
		Weight kg		91.2	85.7	73	78

Supply includes	Design	Material	Colour				
Enclosure	Frame structure with side panels, screw-fastened from the inside	Sheet steel 1.5 mm	Textured RAL 7035 (light grey)	●	●	●	●
	Base with gland plate for cable entry						
	Levelling feet to compensate floor irregularities						
Trim panel, top	To finish off the enclosure at the top	Plastic to UL 94-V0	RAL 7035 RAL 7015	●	●		●
Keyboard drawer	Drawer housing	Sheet steel 1.5 mm	RAL 7035	●	●		
	Extension piece with cable support, hinged, plus pull-out mousepad and keyboard cradle						
	Trim panel with recessed handle, folded as handrest, with lock no. 3524 E	Plastic to UL 94-V0	RAL 7035 RAL 7015 (slate grey) RAL 9006 (white aluminium)				
Drawer section	Drawer tray, fitted with drawer trim panel and telescopic slides	Sheet steel 1.5 mm	RAL 7035				
	Drawer trim panel with recessed handle, with fastener and lock no. 3524 E.	Plastic to UL 94-V0	RAL 7035 RAL 7015 RAL 9006			●	
Designer door	Vertical bars with locking rod and double-bit insert, hinged on right-hand side	Aluminium section	RAL 7035	●	●	●	
	Door or installation plate, folded	Sheet steel 1.5 mm	RAL 7015				
Drawer front	Drawer tray, slotted all round for cross member retainers, 1 x with low trim panel, 2 x with high trim panel, each with recessed handle, telescopic slides	Sheet steel 1.5 mm	RAL 7035 RAL 7015 RAL 9006				●
Worktop	Solid	Chipboard, plastic-laminated on both sides, with edge strips	Similar to RAL 7035 Edge strips: Similar to RAL 7015	●			
Roof	Edged, screw-fastened from the inside	Sheet steel 1.5 mm	Textured RAL 7035		●		
Rear panel	Screw-fastened from the inside	Sheet steel 1.5 mm	Textured RAL 7035				●
Rear door	With locking rod and double-bit insert, hinged on the right-hand side	Sheet steel 1.5 mm	Textured RAL 7035	●	●	●	

Lock systems:

Standard double-bit lock insert, may be exchanged for lock inserts or comfort handle, see Catalogue 30, page 936 – 938, for designer door only in conjunction with handle adaptor PC 8611.300, see Catalogue 30, page 153.

IW ENCLOSURE WITH DRAWERS

For a tidy workplace, the IW enclosure offers plenty of storage space, either with a complete drawer front or in combination with the designer door. The special base/plinth ensures stability, even with heavy loads.

A broad range of expansion options, e.g. with an elegant Optipanel enclosure for the TFT monitor and a pre-prepared worktop including handle, covers every conceivable requirement.



Note:

- Other enclosure depths or heights, variable on a 25 mm pitch pattern,
- all IW components as well as system accessories, fully assembled ex works,
- other drawer combinations,
- fitted variants IW 6901.100 (with worktop) and IW 6901.200 (with roof) also with other worktops, see page 16/17,
- drawers with extension lock are all available on request.

IW accessories see page 26 onwards.

Detailed drawings see page 22.

IW worktops see page 16/17.

IW monitor and operating housings see page 20/21.

Support arm system CP-L see Catalogue 30, page 242.

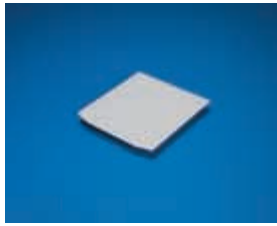

Roof

Edged, attached from the inside.

Material:

1.5 mm sheet steel

Surface finish:

Spray finished in textured RAL 7035

Design	solid
Width mm	600
Depth mm	640
Weight kg	7.4
Model No. IW	6902.400

Worktops

Material and surface finish:

Chipboard, plastic-laminated on both sides, similar to RAL 7035 (pale grey), with tough plastic edge strip, similar to RAL 7015 (slate grey).

Without handle

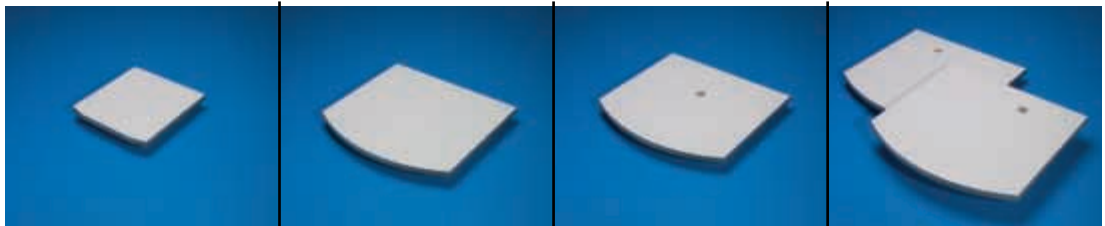

Design	Solid	Solid	Prepared for turntable	Prepared for enclosure attachment*	
				left	right
Mounting cutout for enclosure attachment	–	–	–	left	right
Width mm	610	1000	1000	1000	1000
Depth mm	645	895	895	895	895
Weight kg	11.6	24	23	23	23
Model No. IW	6902.300	6902.100	6902.110¹⁾	6902.120¹⁾	6902.130¹⁾

* For CP-L enclosure attachment CP 6525.5X0, housing coupling CP 6525.0X0, angle coupling CP 6526.0X0, see Catalogue 30, page 249 – 251.

¹⁾ Hole may be used in conjunction with the adaptor plate for connector grommet IW 6902.660 (see page 32) for cable entry!

With handle



(not suitable for use in enclosures with drawer section IW 6900.400)

Design	Solid	Prepared for turntable	Prepared for enclosure attachment*	
			left	right
Mounting cutout for enclosure attachment	–	–	left	right
Width mm	1200	1200	1200	1200
Depth mm	950	950	950	950
Weight kg	34	33	33	33
Model No. IW	6902.000	6902.010¹⁾	6902.020¹⁾	6902.030¹⁾

* For CP-L enclosure attachment CP 6525.5X0, housing coupling CP 6525.0X0, angle coupling CP 6526.0X0, see Catalogue 30, page 249 – 251.

¹⁾ Hole may be used in conjunction with the adaptor plate for connector grommet IW 6902.660 (see page 32) for cable entry!

Every worktop has its own particular strength: e.g. for TFT a monitor on the support arm system CP-L, for monitor housings on a turntable, or simply plenty of work space.

Need a very specific format with additional cutouts for your measurement, testing or production technology? Give us a call!

Note:

- Keyboard built into the worktop with mousepad (including IP 67),
- worktops in modified sizes and height-adjustable,
- all IW components as well as system accessories can be supplied fully assembled,
- fitted variants IW 6901.100 (with worktop) and IW 6901.200 (with roof) also available with other worktops upon request.

IW accessories see page 26 onwards.

Detailed drawings see page 24.



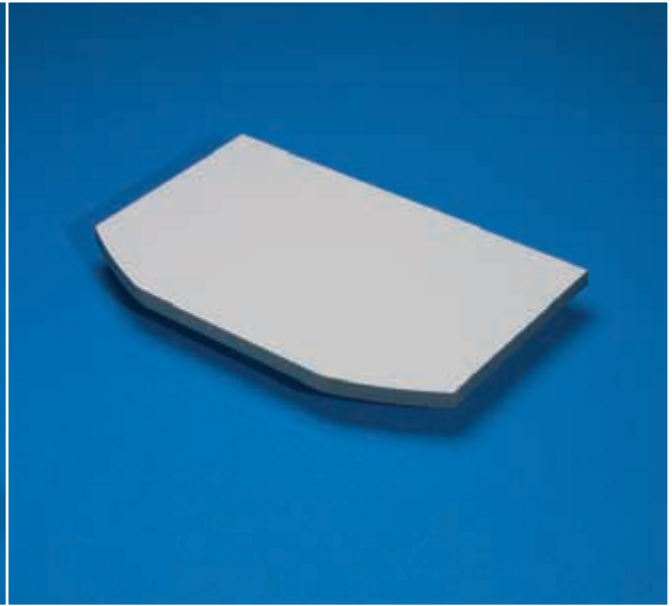

Pedestal

The panel moulding is opened for simple cable laying.

Material:

Feet: Cast aluminium
 Cross-member, vertical support tubes: Steel
 Panels: Aluminium section

Colour:

Feet, cross member, support tubes and worktop attachment: Textured RAL 7035
 Panels: Natural anodised

Width mm	600
Height mm	1093
Depth mm	700
Weight kg	33.7
Model No. IW	6141.200

Note:

Pedestal, height-adjustable, on request.

Worktop

Prepared for tilting enclosure attachment

Material and surface finish:

Chipboard, plastic-laminated on both sides, similar to RAL 7035 (pale grey), with tough plastic edge strips, similar to RAL 7015 (slate grey).

Width mm	960
Height mm	38
Depth mm	600
Weight kg	16
Model No. IW	6902.310



Enclosure attachment tilting

For mounting underneath the worktop.

Adjustable tilting angle: 40° backwards, 40° forwards.

Material:

Sheet steel, spray finished in RAL 7024

Weight kg	1.6
Model No. IW	6902.640

Foot rest

Material:

Connector pieces: Cast aluminium RAL 7035 (light grey)
 Round tube section: Aluminium, natural anodised

Supply includes:

Including assembly parts

Weight kg	0.6
Model No. CP	6145.100

Trim panel

Material:

Cast aluminium, powder-coated in textured RAL 7035 (light grey)

Supply includes:

Including assembly parts

Weight kg	1.6
Model No. CP	6144.100

Base mount

Material:

Sheet steel, zinc-plated

Supply includes:

Including posidrive raised countersunk screws M12

Weight kg	0.7
Model No. CP	6147.000

IW PEDESTAL WITH WORKTOP

If you are prepared to sacrifice some storage space in exchange for more workspace, the pedestal with worktop is the ideal choice. It boasts plenty of space for your keyboard, mousepad and production plans.

An ergonomic solution: The correct inclination of the TFT monitor at the top – e.g. in the customised Optipanel enclosure (see Catalogue 30, from page 196) – coupled with the foot rest at the bottom, for a relaxed posture and changing work positions.

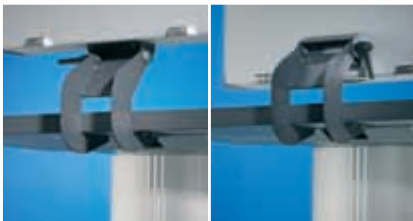
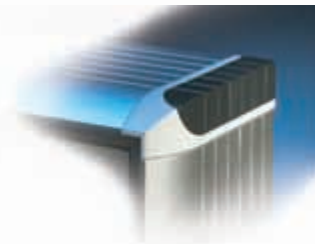

The enclosure attachment can be mounted both on the support arm connection of the Optipanel enclosure as well as on the underside or rear of any given enclosures.

Note:

- Other pedestal widths or heights,
- keyboard and mousepad built into the worktop (including IP 67),
- worktops in modified sizes available on request.

IW accessories see page 26 onwards.

Detailed drawings see page 25.

Twin castors see page 27.



Monitor housing

Front designer door, rear door with release for designer door. With cutout at the bottom and reinforcement for support arm connection CP-XL. Component shelf, slotted, for monitor.

Material:

Enclosure, rear door and component shelf:
1.5 mm sheet steel
Designer door:
Vertical plastic decorative trim panels to UL 94-V0
Glass pane:
Safety glass ESG 4.0 mm

Surface finish:

Enclosure and rear door:
Textured RAL 7035
Designer door:
Decorative trim panels
RAL 7035, screen-printed mask on glass pane RAL 7015
Component shelf: RAL 7015

Lock systems:

Standard double-bit lock insert may be exchanged for lock inserts or comfort handle, see Catalogue 30, page 936 – 938.

Dimensions (W x H x D mm)	Weight (kg)	For screen	Model No. IW
600 x 600 x 500	38	17"	6902.510
600 x 600 x 600	43	21"	6902.500



Feet

for monitor housing, see page 28.

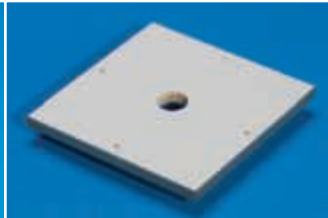

Spacer plate

for monitor housing, see page 28.



Turntable

for spacer or support plate, see page 28.



Rittal Optipanel

A special, stylish enclosure made from extruded aluminium section. For installation depths of 50, 100 and 150 mm, the width and height are adapted to suit your TFT monitors or other display and input units. All enclosure depths may be combined with support arm system CP-L, see Catalogue 30, page 196.



Support arm system CP-L

The support section CP-L allows Optipanel operating housings to be positioned in a swivel, tilting and height-adjustable arrangement depending on the respective ergonomic conditions required, see Catalogue 30, page 242.

IW MONITOR HOUSINGS, OPERATING HOUSINGS

As well as conventional monitors, TFT flat-screens are also becoming increasingly popular.

Within the context of its Industrial Workstations series, Rittal offers a wide range of standardised and individual accommodation options for both variants. Versatile ergonomic requirements, security standards, individual sizes and design lines are met to perfection.

IW accessories see page 26 onwards.

Detailed drawings see page 25.

IW worktops prepared for enclosure attachment or turntable, see page 16.



TECHNICAL DETAILS

Enclosure with door variants

Enclosure with designer door, rear panel
IW 6900.000 / IW 6901.000

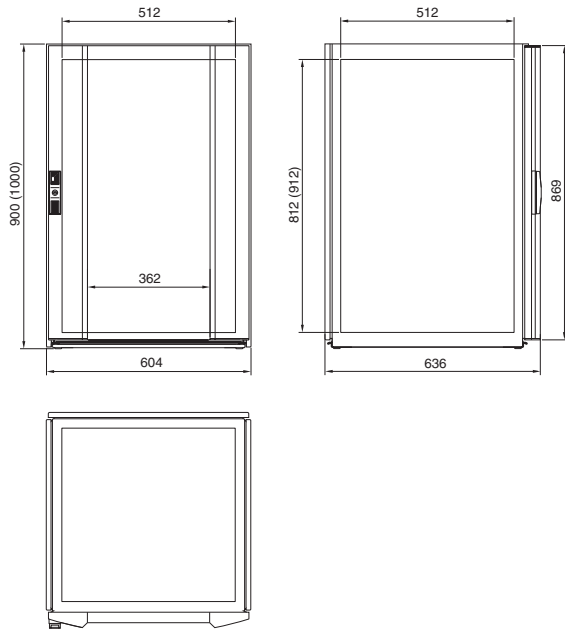

Enclosure with designer door, rear door
IW 6900.100

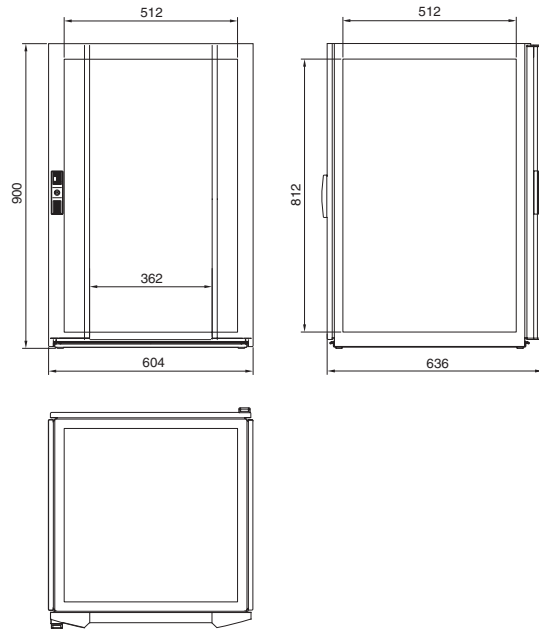

Enclosure with glazed door, rear door
IW 6900.200

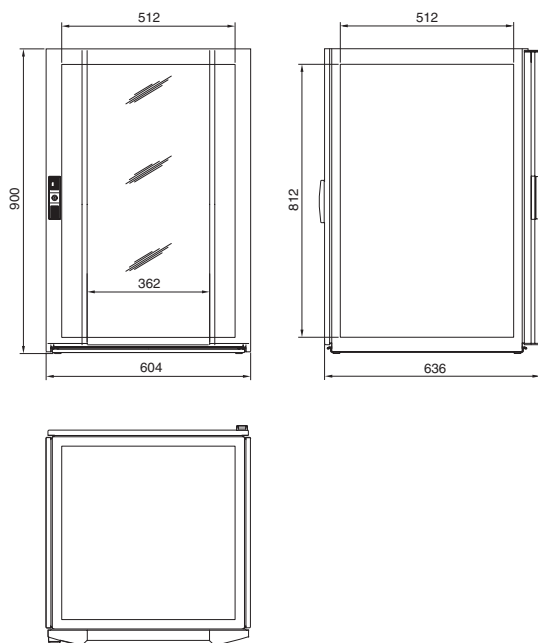

Enclosure with drawers

**Enclosure with worktop, keyboard drawer, designer door, rear door
IW 6901.100**

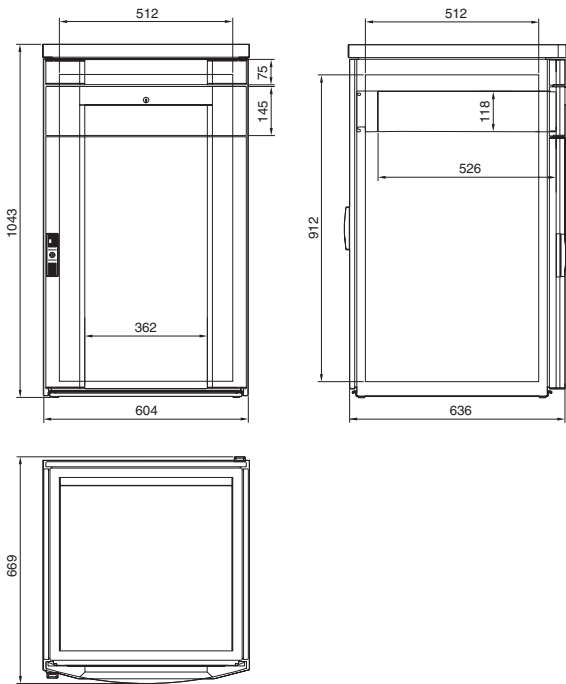

**Enclosure with roof, keyboard drawer, designer door, rear door
IW 6901.200**

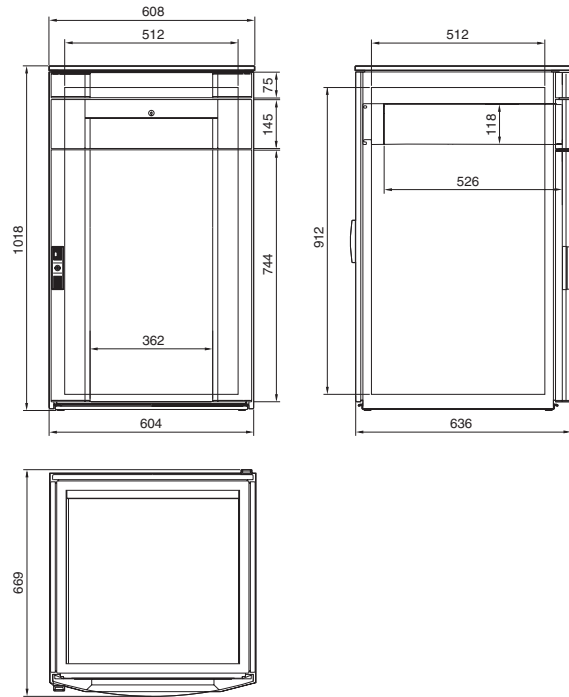

**Enclosure with drawer section, designer door, rear door
IW 6900.400**

Max. load capacity of drawer: 15 kg

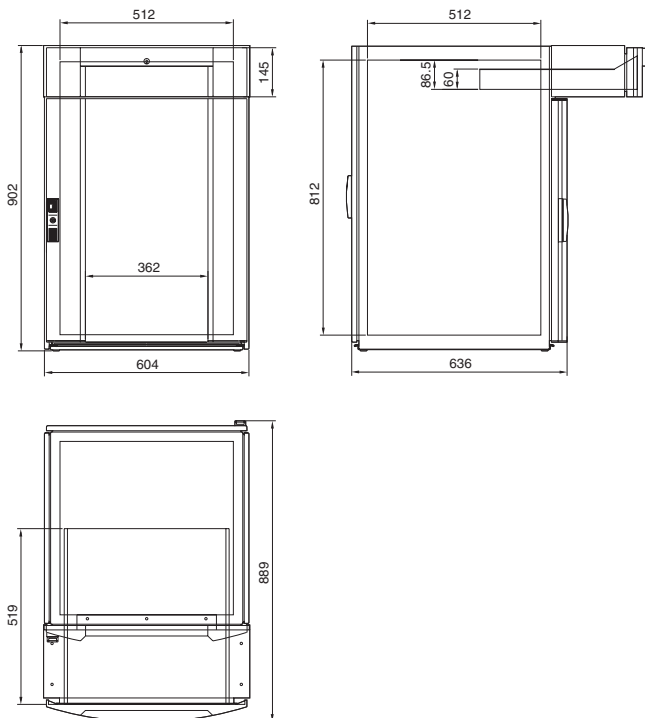

**Enclosure with drawer front, rear panel
IW 6900.600**

Max. load capacity per drawer: 30 kg

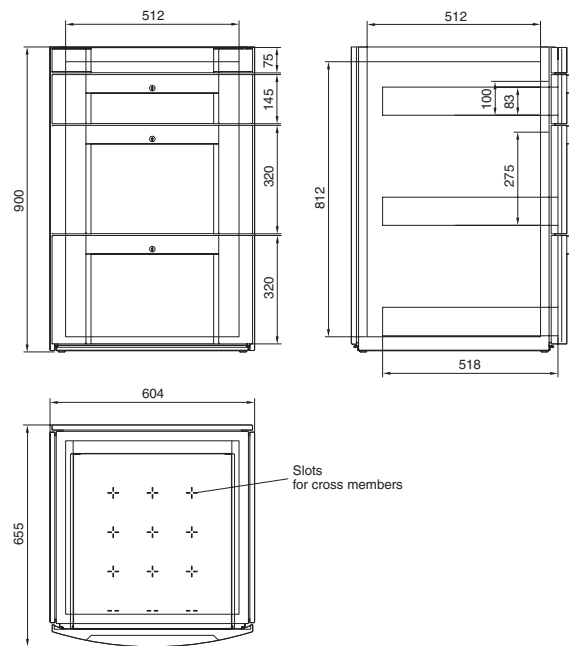

TECHNICAL DETAILS

Worktops/roof

Roof
IW 6902.400

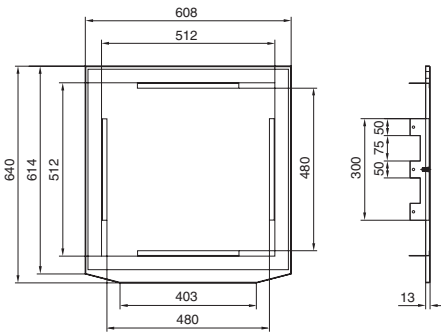

Worktop without handle, prepared for enclosure attachment
IW 6902.120 / IW 6902.130

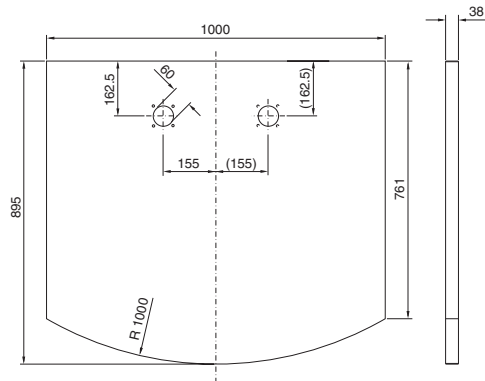

Worktop without handle, solid
IW 6902.300

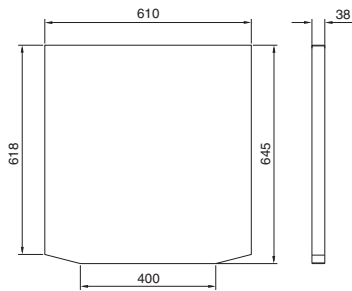

Worktop with handle, solid IW 6902.000,
prepared for turntable IW 6902.010

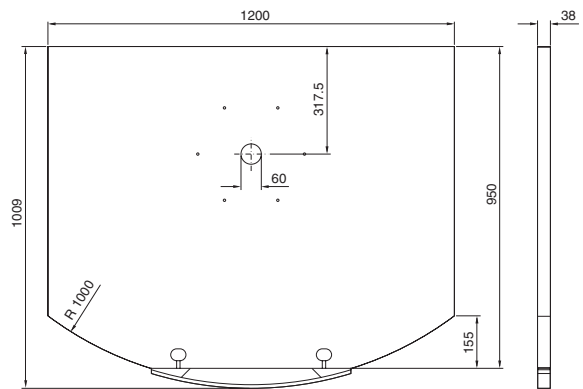

Worktop without handle, solid IW 6902.100,
prepared for turntable IW 6902.110

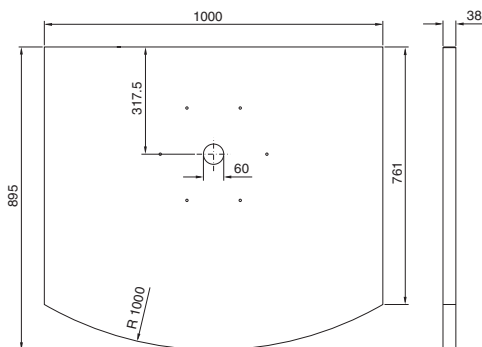

Worktop with handle, prepared for enclosure attachment
IW 6902.020 / IW 6902.030

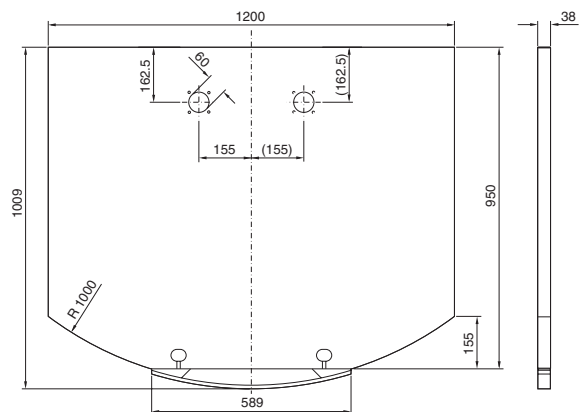

Pedestal with worktop/monitor housing/accessories

**Worktop for pedestal
IW 6902.310**

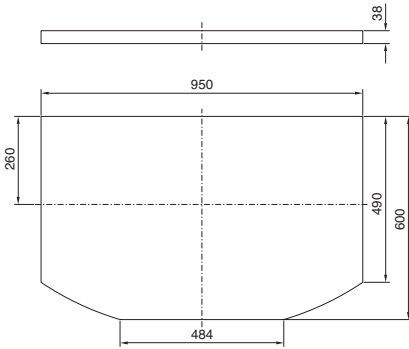

**Pedestal
IW 6141.200**

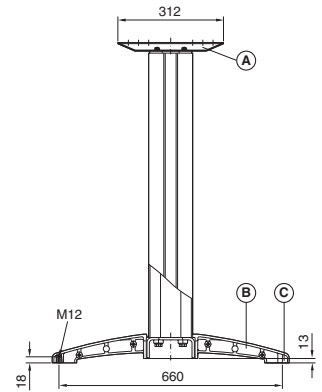
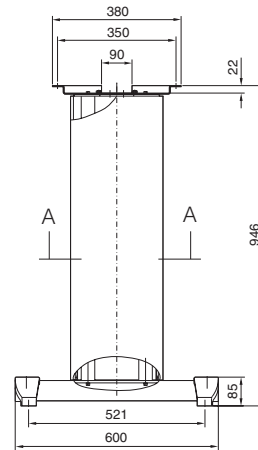

**Enclosure attachment, tilting
IW 6902.640**

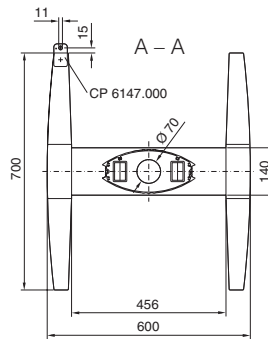
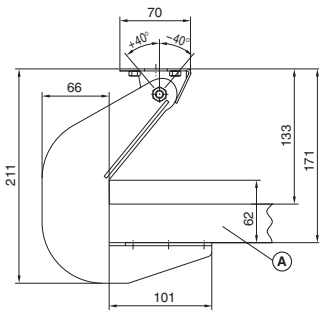

- (A) Preparation for worktop IW 6902.310
- (B) Preparation for trim panel CP 6144.100 or foot rest CP 6145.100
- (C) Preparation for twin castors CP 6148.000 or base mount CP 6147.000

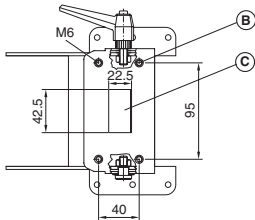

- (A) IW 6902.310
- (B) Prepared for enclosure with CP-L corner connection or CP-L connection console CP 6508.0X0
- (C) Prepared for connector gland SZ 2400.300 / SZ 2400.500

**Monitor housing
IW 6902.500 / IW 6902.510**

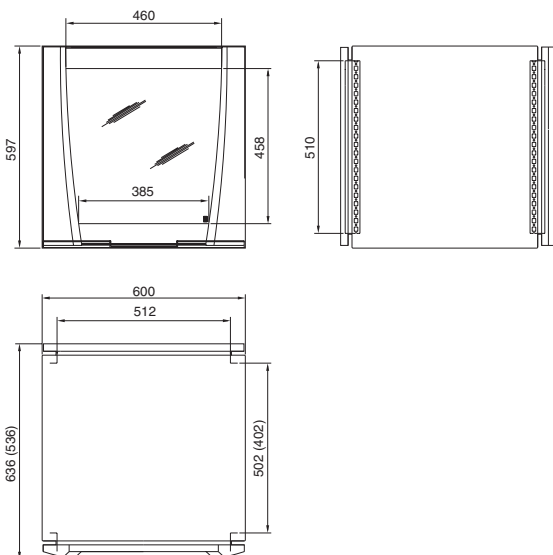

**Support plate
IW 6902.650**

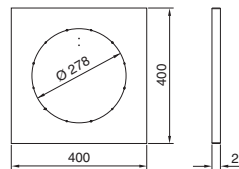

**Turntable
IW 6902.620**

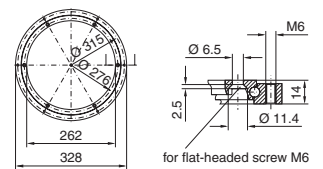

**Spacer plate
IW 6902.630**

