

## Electronic housing - ME MAX 22,5 2-2 KMGY VPE1 - 2201319

Please be informed that the data shown in this PDF Document is generated from our Online Catalog. Please find the complete data in the user's documentation. Our General Terms of Use for Downloads are valid (<http://phoenixcontact.com/download>)



Electronic housing consisting of: Housing shells left and right, front plate, transparent cover, metal foot catch and spring, open housing, 16-pos. (4 x 4 pos.), width: 22.5 mm, color: Light gray

The illustration shows the housing versions

### Why buy this product

- Plug-in connection with screw, spring-cage or fast connection technology
- DIN rail bus connector as an option
- Labels for additional labeling as an option
- Large PCB surface despite compact housing dimensions
- Large front surface for high-pos. plugs or operating and setting elements
- Easy module replacement without interrupting the contact chain
- The fitted cover is easy to adapt and print
- Fixed or plug-in connection technology can be combined on up to three connection levels, with different pitches
- Functional earth ground contact as an option
- Transparent front cover can be swiveled



### Key commercial data

Packing unit	1
GTIN	 4 046356 766975
Custom tariff number	85472000

### Technical data

Product type	Complete housing
Approval	UL Recognized
	cUL Recognized
	cULus Recognized
Width	22.5 mm
Height	114.5 mm
Depth	99 mm

# Electronic housing - ME MAX 22,5 2-2 KMGY VPE1 - 2201319

## Technical data

No. of pos. for cross connection	5
Type of cross connection	DIN rail bus connector
Functional earth ground contact	Integrated
	without
Color	light gray (7035)
Connection method	Fixed
	Pluggable

## Classifications

### eCl@ss

eCl@ss 4.0	27180401
eCl@ss 4.1	27180401
eCl@ss 5.0	27180506
eCl@ss 5.1	27180506
eCl@ss 6.0	27180802
eCl@ss 7.0	27182702
eCl@ss 8.0	27182702

### ETIM

ETIM 2.0	EC001031
ETIM 3.0	EC001031
ETIM 4.0	EC001031
ETIM 5.0	EC001031

### UNSPSC

UNSPSC 6.01	31261501
UNSPSC 7.0901	31261501
UNSPSC 11	31261501
UNSPSC 12.01	31261501
UNSPSC 13.2	31261501

## Approvals

### Approvals

---

Approvals

UL Recognized / cUL Recognized / cULus Recognized

---

### Ex Approvals

---

## Electronic housing - ME MAX 22,5 2-2 KMGY VPE1 - 2201319

### Approvals

Approvals submitted

---

#### Approval details

UL Recognized 

cUL Recognized 

cULus Recognized 

### Accessories

Accessories

Ground contact

Electronic housing - ME FE-CONTACT - 2908294



Functional earth ground contact, for intermediate elements.

---

### Drawings

# Electronic housing - ME MAX 22,5 2-2 KMGY VPE1 - 2201319

Dimensioned drawing

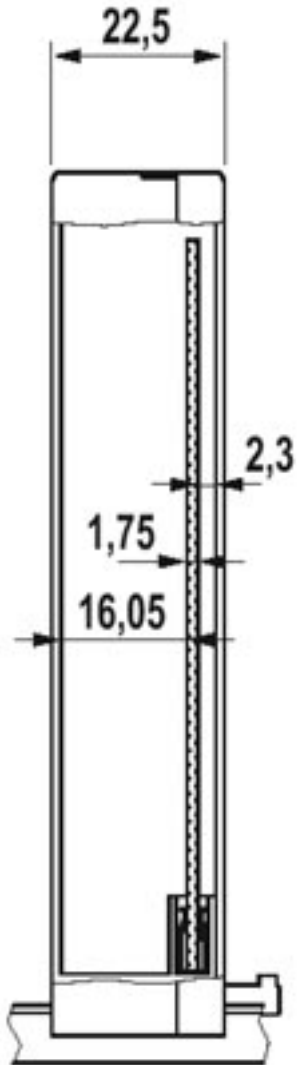

Dimensioned drawing

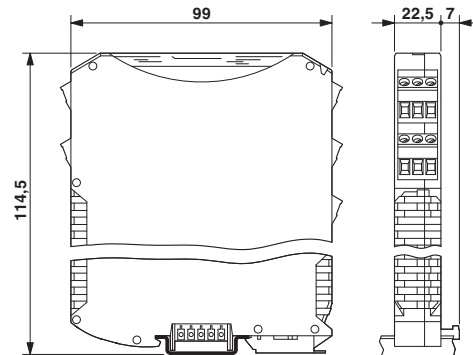

## Electronic housing - ME MAX 22,5 2-2 KMGY VPE1 - 2201319

Explosion drawing

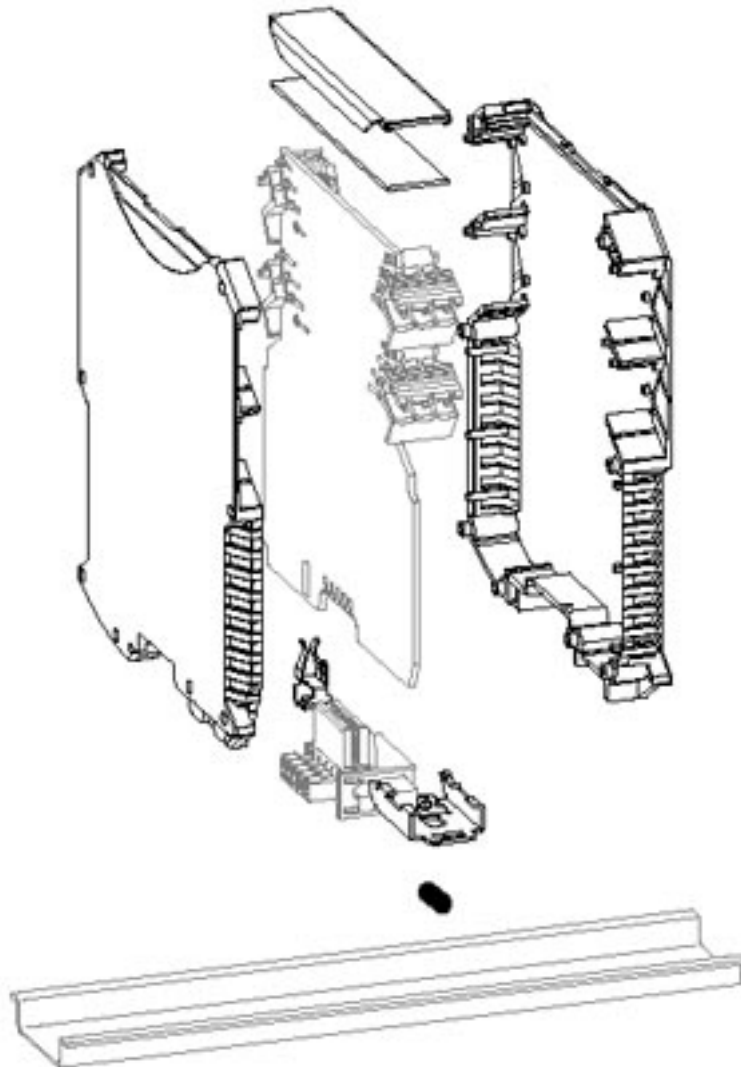

The illustration shows a version of the product (open housing) with accessories

## Electronic housing - ME MAX 22,5 2-2 KMGY VPE1 - 2201319

Drilling diagram

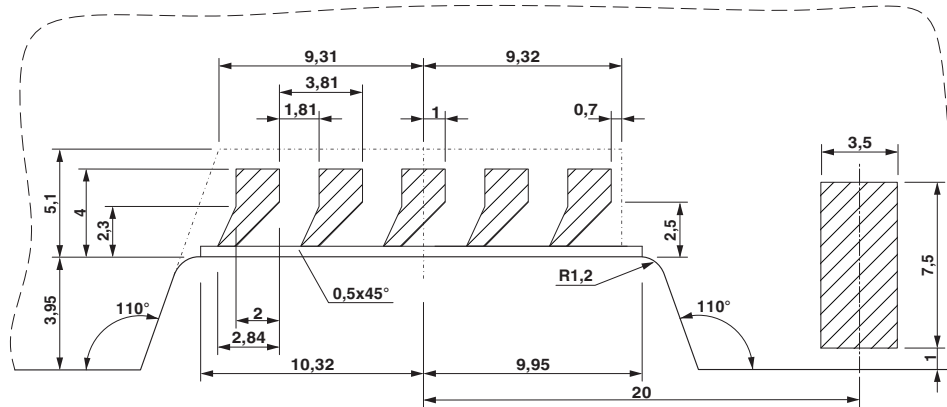

Detailed dimensional drawing of the DIN rail connector contact pads

# Electronic housing - ME MAX 22,5 2-2 KMGY VPE1 - 2201319

Dimensioned drawing

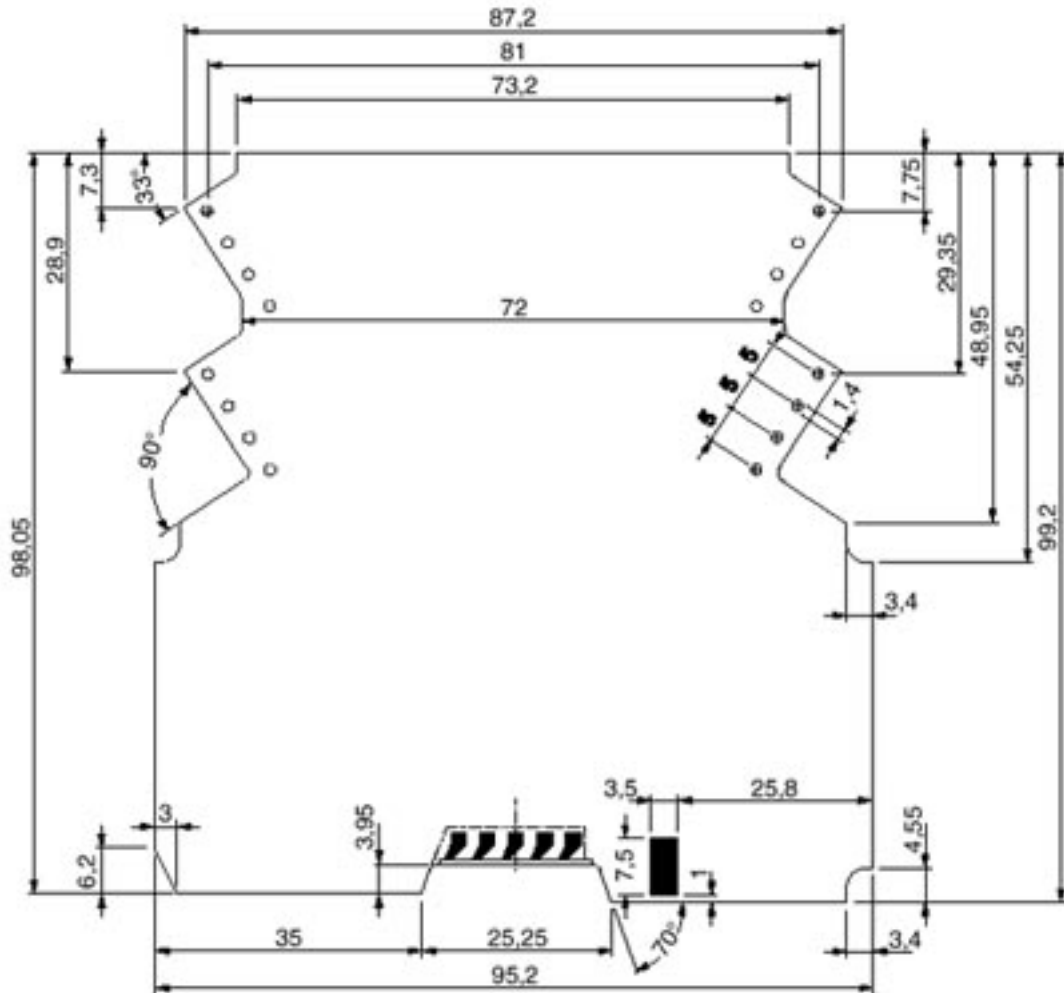

Dimensional drawing of the ME MAX 2-2 printed circuit board, for printed circuit terminal block connection (MKDSO), view: component side

# Electronic housing - ME MAX 22,5 2-2 KMGY VPE1 - 2201319

Dimensioned drawing

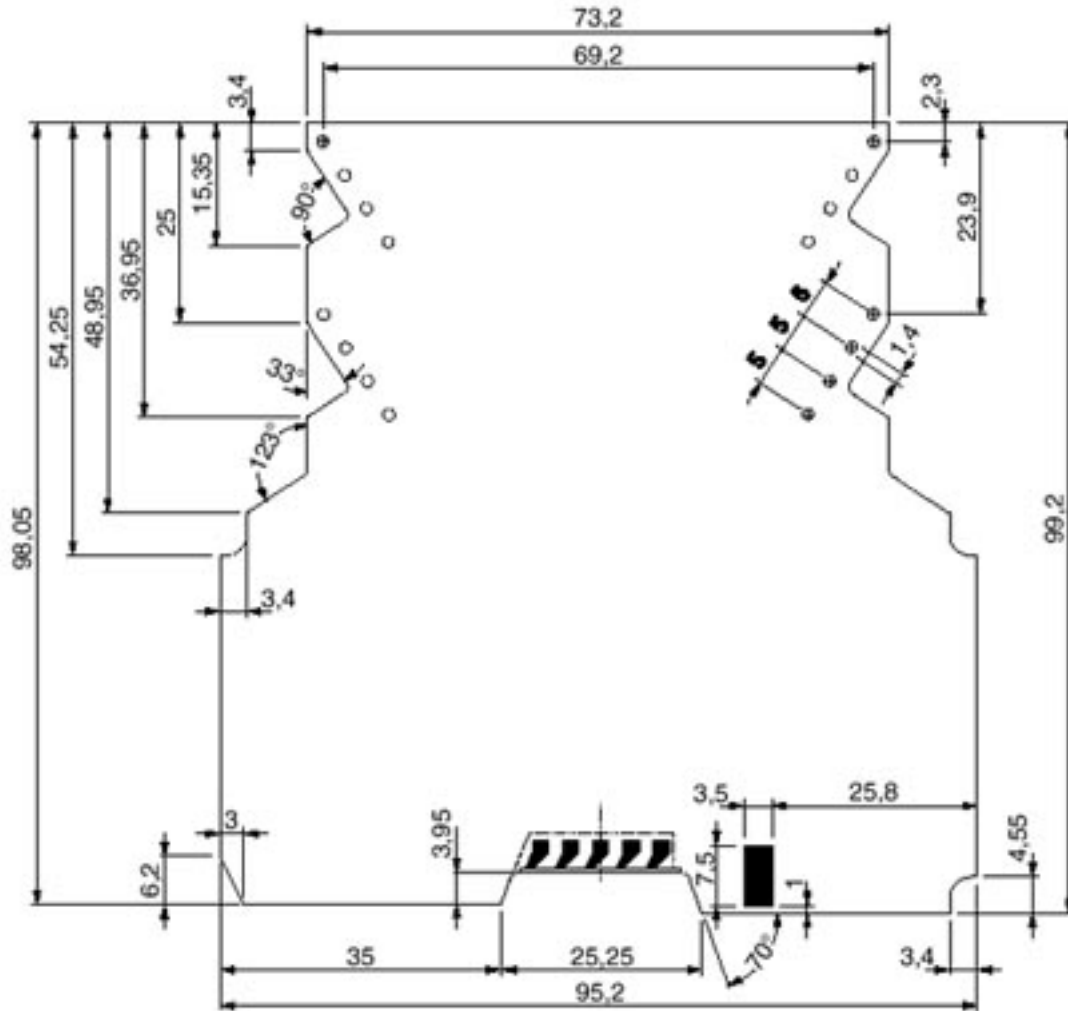

Dimensional drawing of the ME MAX 2-2 printed circuit board for plug connection (MSTBO), view: component side