

Fuse Links/Sicherungseinsätze

D

ETI

ELEKTROELEMENT d.d.

61411 Izlake, Obrezija 5
Slovenija
Phone: + 386 (0)601 74 112, 73 513
Fax: + 386 (0)601 74 077
Telex 35010 SI eeiz

CERTIFICATE



ISO 9001

Fuse Links

Application

Ordinary (quick-acting) fuse links are used for common protection against short circuits and overloads in electric installation lines.

- Time-lag fuse links are used for protection of input circuits of electromotors, for protection of circuits with current peaks and in combination with circuit breakers and motor protection switches.
- The C insulating class permits the use in industrial and similar installations.

- Fuse links gL-gG are used for common protection against short circuits and overloads in all electric installation lines.

Sicherungseinsätze

Anwendung:

Flink Sicherungseinsätze sind vor Überlastungen und Kurzschlüssen vorgesehen.

- Träge Sicherungseinsätze finden Verwendung in folgenden Fällen
- Sicherung von Speiseleitungen der Elektromotoren

- Stromkreise mit Stromspitzen

- In Kombination mit Installationsselbstschaltern

- Mit C Isolationsklasse ist Anwendung in der Industrie und anderen Installationen zulässig.

- gL-gG Sicherungseinsätze sind vor Überlastungen und Kurzschlüssen in alle Installationen vorgesehen.

Technical data:

rated voltage U_N	Nennspannung U_N	500 V.
rated currents I_N	Nennstromstärken I_N	DI, DII 2 - 25 A, DIII 35 - 63 A DIV 80 - 100 A, DV 125 - 200 A
breaking capacity at 1,1 U_N	Ausschaltvermögen bei 1,1 U_N	50 kA ~ $\cos\varphi = 0,2$ 8kA ~ $T = 15$ ms
fusing characteristics	Betriebsklasse bzw. Charakteristik	gL - gG, ordinary/flink, time-lag/träge
insulating class	Isolationsklasse	C - VDE 0110
standards, publications	Vorschriften, Bestimmungen	IEC 269, CEE 16, VDE 0636, VDE 0635, DIN 49515

Technische Beschreibung:

DI for fuse base E 16

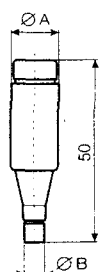
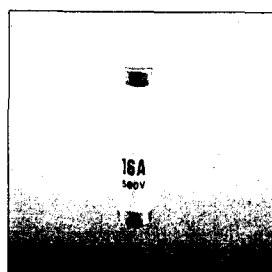

DI für Sicherungsunterteile E 16

I_N (A)	colour	Farbe	code No./Bestell-Nr.		weight (g) Gewicht (g)	packaging (pcs) Verpackung (Stck.)	dimens./Abmess.	
			ordinary/flink gL - gG	time-lag/träge gL - gG			$\varnothing A$	$\varnothing B$
2	pink	rosa	2311101	2311401	12	20/500	13,2	6
4	brown	braun	2311102	2311402	12	20/500	13,2	6
6	green	grün	2311103	2311403	12	20/500	13,2	6
10	red	rot	2311104	2311404	13	20/500	13,2	8
16	grey	grau	2311105	2311405	14	20/500	13,2	10
20	blue	blau	2311106	2311406	15	20/500	13,2	12
25	yellow	gelb	2311107	2311407	16	20/500	13,2	14

DII for fuse base E 27

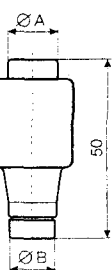
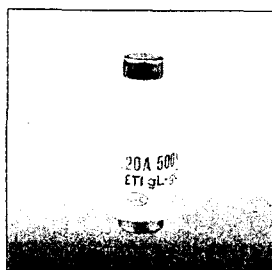

DII für Sicherungsunterteile E 27

I_N (A)	colour	Farbe	code No./Bestell-Nr.		weight (g) Gewicht (g)	packaging (pcs) Verpackung (Stck.)	dimens./Abmess.	
			ordinary/flink gL - gG	time-lag/träge gL - gG			$\varnothing A$	$\varnothing B$
2	pink	rosa	2312101	2312401	27	5/500	21,5	6
4	brown	braun	2312102	2312402	27	5/500	21,5	6
6	green	grün	2312103	2312403	27	5/500	21,5	6
10	red	rot	2312104	2312404	27	5/500	21,5	8
16	grey	grau	2312105	2312405	28	5/500	21,5	10
20	blue	blau	2312106	2312406	29	5/500	21,5	12
25	yellow	gelb	2312107	2312407	30	5/500	21,5	14

fuse links

Sicherungseinsätze

DIII for fuse base E 33

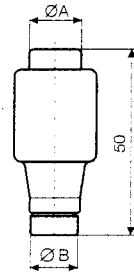
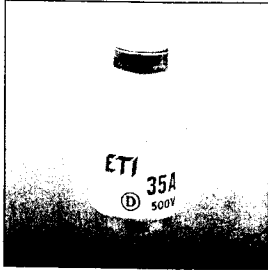

DIII für Sicherungsunterteile E 33

I _N (A)	colour	Farbe	code No./Bestell-Nr.		weight (g) Gewicht (g)	packaging (pcs) Verpackung (Stck.)	dimens./Abmess.	
			ordinary/flink gL - gG	time-lag/träge gL - gG			∅A	∅B
35	black	schwarz	2313101	2313401	48	5/500	27	16
50	white	weiss	2313102	2313402	49	5/500	27	18
63	copper	kupferf.	2313103	2313403	52	5/500	27	20

DIV for fuse base R 1 1/4"

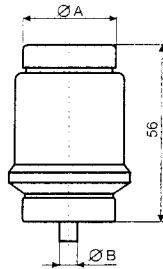
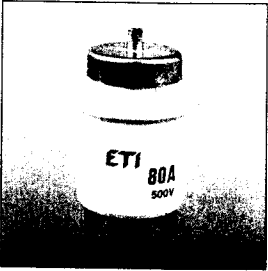

DIV für Sicherungsunterteile R 1 1/4"

I _N (A)	colour	Farbe	code No./Bestell-Nr.		weight (g) Gewicht (g)	packaging (pcs) Verpackung (Stck.)	dimens./Abmess.	
			ordinary/flink gL - gG	time-lag/träge gL - gG			∅A	∅B
80	silver	silbern	2314101	2314401	105	25/100	33	5
100	red	rot	2314102	2314402	110	25/100	33	7

DV for fuse base R 2"

DV für Sicherungsunterteile R 2"

I _N (A)	colour	Farbe	code No./Bestell-Nr.		weight (g) Gewicht (g)	packaging (pcs) Verpackung (Stck.)	dimens./Abmess.	
			ordinary/flink gL - gG	time-lag/träge gL - gG			∅A	∅B
125	yellow	gelb	2315101	2315401	185	10/60	46	5
160	copper	kupferf.	2315102	2315402	210	10/60	46	7
200	blue	blau	2315103	2315403	215	10/60	46	9

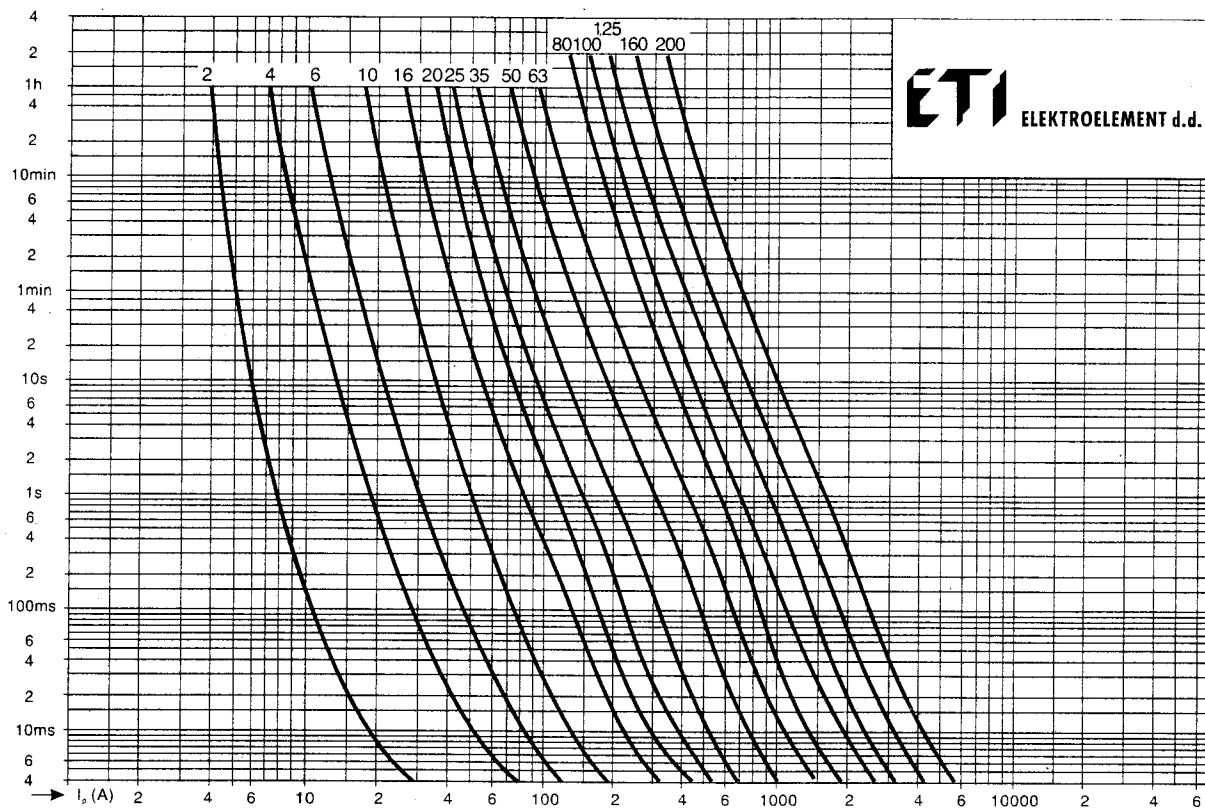

Gauge Pieces

Passeinsätze

VD II for fuse base E 27

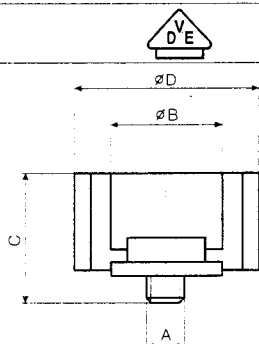
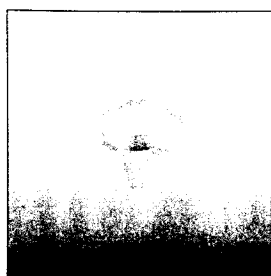

VD II für Sicherungsunterteile E 27

I _N (A)	colour	Farbe	code No. Bestell-Nr.	weight (g) Gewicht (g)	packaging (pcs) Verpackung (Stck.)	dimensions/Abmessungen			
						A	B	C	D
2	pink	rosa	2342001	13	25/1500	3/16"	6,5	17	24
4	brown	braun	2342002	13	25/1500	3/16"	6,5	17	24
6	green	grün	2342003	13	25/1500	3/16"	6,5	17	24
10	red	rot	2342004	11	25/1500	3/16"	8,5	17	24
16	grey	grau	2342005	11	25/1500	3/16"	10,5	17	24
20	blue	blau	2342006	11	25/1500	3/16"	12,5	17	24
25	yellow	gelb	2342007	11	25/1500	3/16"	14,5	17	24

VD III for fuse base E 33

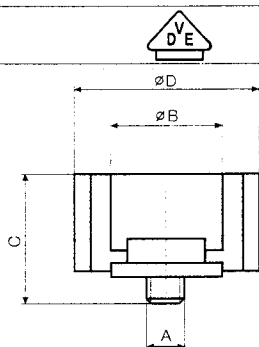
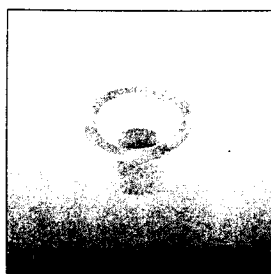

VD III für Sicherungsunterteile E 33

I _N (A)	colour	Farbe	code No. Bestell-Nr.	weight (g) Gewicht (g)	packaging (pcs) Verpackung (Stck.)	dimensions/Abmessungen			
						A	B	C	D
35	black	schwarz	2343001	19	25/850	3/16"	16,5	17	30
50	white	weiss	2343002	18	25/850	3/16"	18,5	17	30
63	copper	kupferf.	2343003	16	25/850	3/16"	20,5	17	30

VD IV for fuse base R 1 1/4"

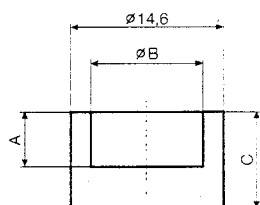

VD IV für Sicherungsunterteile R 1 1/4"

I _N (A)	colour	Farbe	code No. Bestell-Nr.	weight (g) Gewicht (g)	dimensions/Abmessungen		
					A	B	C
80	red	rot	2344001	18	6	6	14
100	silver	silbern	2344002	18	6	8	14

VD V for fuse base R 2"

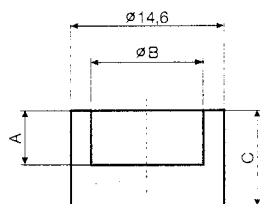

VD V für Sicherungsunterteile R 2"

I _N (A)	colour	Farbe	code No. Bestell-Nr.	weight (g) Gewicht (g)	dimensions/Abmessungen		
					A	B	C
125	yellow	gelb	2345001	18	9	6	14
160	copper	kupferf.	2345002	18	9	8	14

Fuse Bases

Application:

The fuse bases type D are made to be incorporated into distribution boxes for individual application, in industrial and public edifices. The bases most up-to-date design are EZN for mounting on rails (according to EN 50022) and bases EZR type, because they can be directly fastened to the EZR-busbar.

Technical data:

rated voltage U_n
 rated currents I_n
 insulating class
 cross-section of connecting lead
 standards, publications

Sicherungsunterteile

Anwendung:

Die Sicherungsunterteile D werden zum Einbau in Installationsverteilern und zur Einzelmontage, auch für Industrie- und für Geschäftsgebäude verwendet. Die modernsten Ausführungen alle Unterteile haben die Typen EZN mit Schnappbefestigung an Hutschienen (nach EN 50022) und EZR mit Befestigung an EZR Stromschienen.

Technische Beschreibung:

Nennspannung U_n 500 V
 Nennstromstärken I_n DIN 25 A, DIN 63 A
 Isolationsklasse C - VDE 0110
 Anschluss Querschnitt DIN 1 - 10 mm² DIN 1,5 - 25 mm²
 Vorschriften, Bestimmungen IEC 269, VDE 0636, CEE 16

Single-pole fuse bases

Einpolige Sicherungsunterteile

EZ

EZ

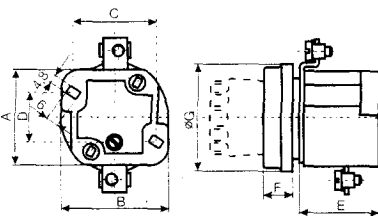

type Typ	I_n (A)	code No. Bestell-Nr.	screw Gewinde	weight Gewicht (g)	packaging (pcs) Verpackung (Stck.)	dimensions/Abmessungen													
						A	B	C	D	E	F	G	H	I					
EZ	25	2322001	E 27	120	15/195	41	47	36	20	35	13	49							
EZ	63	2323001	E 33	175	15/180	45	56	45	20	36	14	58							
ZO*	25	6111202	E 27	24								49							
ZO*	63	6111205	E 33	30								58							

* Schutzring
 * Porcelain ring

TZ

TZ

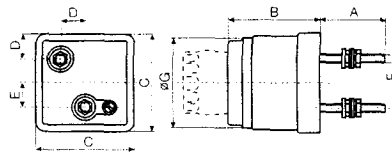
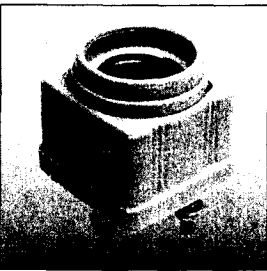

type Typ	I_n (A)	code No. Bestell-Nr.	screw Gewinde	weight Gewicht (g)	packaging (pcs) Verpackung (Stck.)	dimensions/Abmessungen													
						A	B	C	D	E	F	G	H	I					
TZ	25	2322003	E 27	185	24/192	26	50	53	13,5	14	M5	49							
TZ	63	2323002	E 33	368	10/100	31	58	64	16	18	M6	58							

UZ

UZ

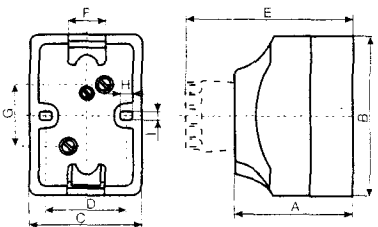
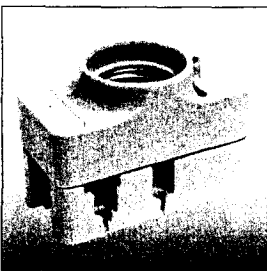

type Typ	I_n (A)	code No. Bestell-Nr.	screw Gewinde	weight Gewicht (g)	packaging (pcs) Verpackung (Stck.)	dimensions/Abmessungen													
						A	B	C	D	E	F	G	H	I					
UZ	25	2322015	E 27	200	10/200	56	80	41	33	82	20	46	4,5	4,5					
UZN	25	2322024	E 27	200	10/200	56	80	41	33	82	20	46	4,5	4,5					
UZ	63	2323004	E 33	452	6/78	57	100	66	48,8	81	46	31	8	6					

EZR

EZR

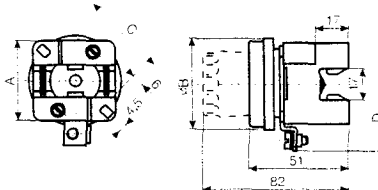
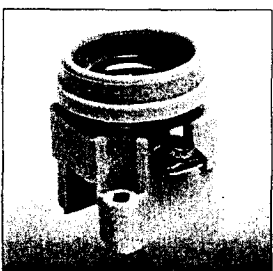

type Typ	I_n (A)	code No. Bestell-Nr.	screw Gewinde	weight Gewicht (g)	packaging (pcs) Verpackung (Stck.)	dimensions/Abmessungen													
						A	B	C	D	E	F	G	H	I					
EZR	25	2322006	E 27	97	15/195	42	49	45	35										
EZR	63	2323005	E 33	132	15/180	47	58	48,5	38										

Busbar

for fuse base EZR

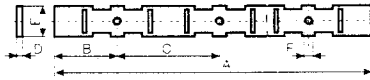
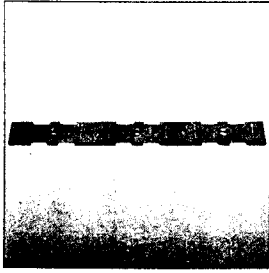

Stromschiene

für Sicherungsunterteile EZR

type Typ	I _N (A)	code No. Bestell-Nr.	screw Gewinde	weight Gewicht (g)	packaging (pcs) Verpackung (Stck.)	dimensions/Abmessungen								
						A	B	C	D	E	F	G	H	I
EZR 25	25	2923032	E 27	380	50	1000	32	50	3	16	3/16"			
EZR 63	63	2923033	E 33	380	50	1000	38	60	3	16	3/16"			

Terminals

for neutral terminals and busbars EZR

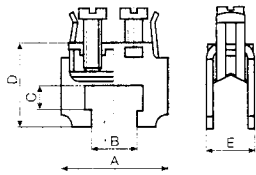
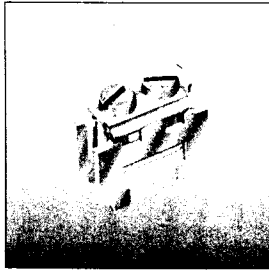

Klemme

für Nullklemmen und Stromschienen EZR

code No. Bestell-Nr.	for cross-section für Querschnitt (mm ²)	weight Gewicht (g)	packaging (pcs) Verpackung (Stck.)	dimensions/Abmessungen				
				A	B	C	D	E
2923032	16	9	100/2200	25	12,5	3,5	17	7,3
2923033	35	21	100/2200	28	12,5	6,5	21,5	12,6

EZN, EZV

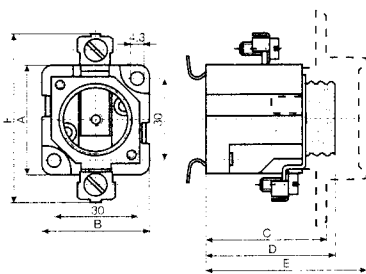
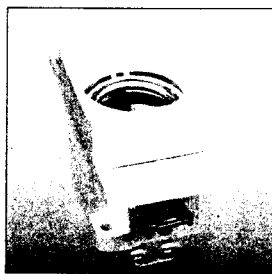

* Fuse bases with protection cover
* Sicherungsunterteile mit Einzelabdeckung

EZN fuse base for mounting on omega rail
EZN Sicherungsunterteil für schnappbefestigung

EZV fuse base for screw type mounting
EZV Sicherungsunterteil für Schraubbefestigung

EZN, EZV

type Typ	I _N (A)	code No. Bestell-Nr.	screw Gewinde	weight Gewicht (g)	packag. (pcs) Verpackung (Stck.)	dimensions/Abmessungen								
						A	B	C	D	E	F	G	H	
EZN 25 [®]	25	2322009	E 27	102	15/195	41	39	44	47	60	62			
EZN 63 [®]	63	2323008	E 33	135	15/180	43	47	44	47	56	79			
EZN 63-M6 [®]	63	2323013	E 33	135	15/180	43	47	44	47	56	79			
EZV 25	25	2322011	E 27	98	15/195	41	39	44	47	60	62			
EZV 63	63	2323010	E 33	133	15/180	43	47	44	47	56	79			
EZV 63-M6	63	2323020	E 33	133	15/180	43	47	44	47	56	79			
EZN 25-ZP*	25	2322016	E 27	118	10/130	41	39	44	47	60	62			
EZN 63-ZP*	63	2323028	E 33	150	10/120	43	47	44	47	56	79			
EZV 25-ZP*	25	2322017	E 27	108	10/130	41	39	44	47	60	62			
EZV 63-ZP*	63	2323029	E 33	140	10/120	43	47	44	47	56	79			

Protection cover

for fuse bases EZN and EZV

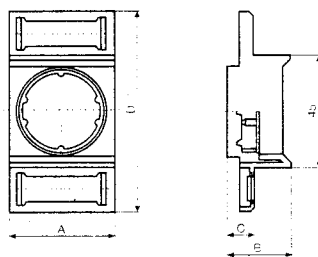
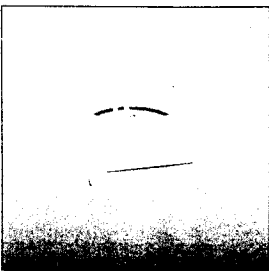

Einzelabdeckung

für Sicherungsunterteile EZN und EZV

type Typ	I _N (A)	code No. Bestell-Nr.	screw Gewinde	weight Gewicht (g)	packaging (pcs) Verpackung (Stck.)	dimensions/Abmessungen								
						A	B	C	D	E	F	G	H	
EZN, EZV 25	25	2352001	E 27	16	30/390	40	24	10,8	80					
EZN, EZV 63	63	2353002	E 33	15	30/360	49	21	9	80					

Fuse Carriers

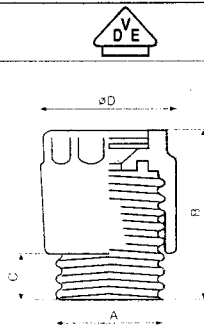
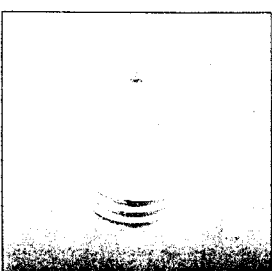

Schraubkappen

type Typ	I _N (A)	code No. Bestell-Nr.	screw Gewinde	weight Gewicht (g)	packaging (pcs) Verpackung (Stck.)	dimensions/Abmessungen			
						A	B	C	D
K DII 25	25	2332003	E 27	35	50/600	E 27	44	12	34
K DII 63	63	2333002	E 33	59	30/360	E 33	44	12	43

Three-pole fuse bases

EZN/3, EZV/3 - DELTA

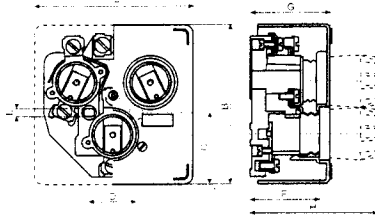

Dreipolige Sicherungsunterteile

EZN/3, EZV/3 - DELTA

type Typ	I _N (A)	code No. Bestell-Nr.	weight Gewicht (g)	packaging (pcs) Verpackung (Stck.)	dimensions/Abmessungen							
					A	B	C	D	E	F	G	H
EZN 25/3	25	2322036	410	8	106	106	48	/	/	45	52	86
EZV 25/3	25	2322037	400	8	106	106	48	32	5,2	45	52	86
EZN 63/3	63	2323043	590	8	127	130	54	/	/	45	52	85
EZV 63/3	63	2323044	580	8	127	130	54	32	5,2	45	52	85

EZN/3, EZV/3 - LINEAR

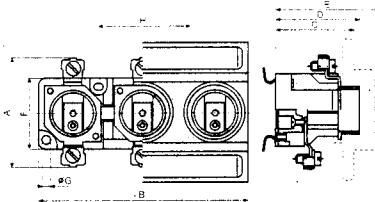

EZN/3, EZV/3 - LINEAR

type Typ	I _N (A)	code No. Bestell-Nr.	screw Gewinde	weight Gewicht (g)	packaging (pcs) Verpackung (Stck.)	dimensions/Abmessungen							
						A	B	C	D	E	F	∅G	H
EZN 25/3	25	2322025	E 27	352	4/60	41	121	44	47	60	30	4,3	50
EZV 25/3	25	2322026	E 27	346	4/60	41	121	44	47	60	30	4,3	50
EZN 63/3	63	2323016	E 33	488	6/42	43	148	44	47	56	32	4,3	62
EZV 63/3	63	2323017	E 33	484	6/42	43	148	44	47	56	32	4,3	62

EZN fuse base for mounting on omega rail
EZN Sicherungsunterteil für schnappbefestigung

EZV fuse base for screw type mounting
EZV Sicherungsunterteil für Schraubbefestigung

Protection Cover

for fuse bases EZN/3 and EZV/3

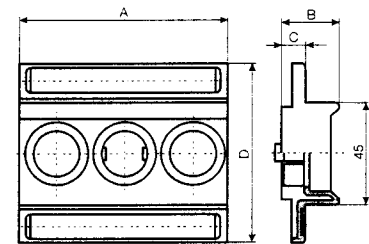

Einzelabdeckung

für Sicherungsunterteile EZN/3 und EZV/3

type Typ	code No. Bestell-Nr.	weight Gewicht (g)	packaging (pcs) Verpackung (Stck.)	dimensions/Abmessungen			
				A	B	C	D
EZN, EZV 25/3	2352003	40	12/120	121	24	10,8	80
EZN, EZV 63/3	2353004	40	12/120	148	21	9	80

Fuse Carriers

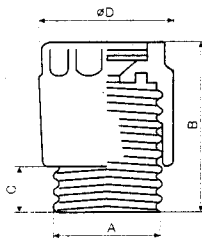
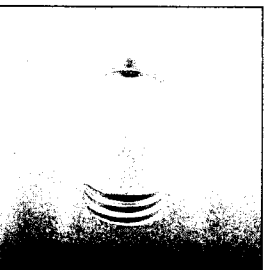

Schraubkappen

type Typ	I _N (A)	code No. Bestell-Nr.	screw Gewinde	weight Gewicht (g)	packaging (pcs) Verpackung (Stck.)	dimensions/Abmessungen			
						A	B	C	D
K DII	25	2332003	E 27	35	50/600	E 27	44	12	34
K DIII	63	2333002	E 33	59	30/360	E 33	44	12	43

Fuse Bases

for Overhead Lines

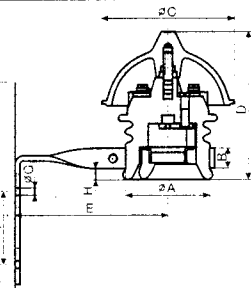
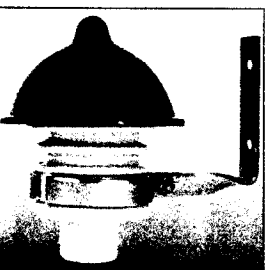

Sicherungsunterteile

für Freileitungen

type Typ	I _N (A)	code No. Bestell-Nr.	screw Gewinde	weight Gewicht (g)	packaging (pcs) Verpackung (Stck.)	dimensions/Abmessungen							
						∅A	B	∅C	D	E	F	∅G	H
FZ	25	2322007	E 27	750	1/22	61	14	104	118	90	50	7	20
FZ	63	2323006	E 33	1050	1/16	70	21	114	120	130	58	7	21

Armoured Fuses - DELTA

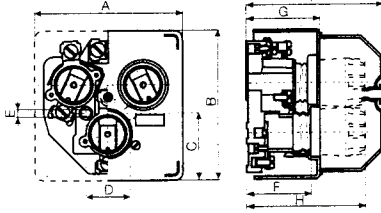
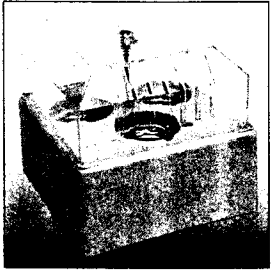

Panzersicherungen - DELTA

type Typ	code No. Bestell-Nr.	weight Gewicht (g)	packaging (pcs) Verpackung (Stck.)	dimensions/Abmessungen								
				A	B	C	D	E	F	G	H	I
T 25/3N	2362003	460	4	106	106	48	/	/	45	52	86	97
T 63/3N	2363003	660	4	127	130	54	/	/	45	52	85	97
T 25/3V	2362004	450	4	106	106	48	32	5,2	45	52	86	97
T 63/3V	2363004	650	4	127	130	54	32	5,2	45	52	85	97