

## Changeover switch - RS20-US-S0212-0303-014H-001 - 3069712

Please be informed that the data shown in this PDF Document is generated from our Online Catalog. Please find the complete data in the user's documentation. Our General Terms of Use for Downloads are valid (<http://phoenixcontact.com/download>)



Changeover switch, with 0 position, Connection method: Screw connection, Number of positions: 3, Function: 1 - 0 - 2, Switching zones: 3, Switching program number: S0212, Rated continuous current: 20 A, Voltage: 690 V

### Why buy this product

- ✓ The compact rotary switch is designed for use in energy technology applications with the available switching programs
- ✓ The use of high-quality materials results in a long mechanical and electrical service life
- ✓ Comprehensive approvals ensure international use
- ✓ High level of safety thanks to non-conductive plastic parts
- ✓ The terminal points are designed in such a way that shock protection according to BGV A2 is ensured
- ✓ The rotary switch is free from cadmium and compliant with the RoHS directive



### Key commercial data

|                                      |   |
|--------------------------------------|---|
| Packing unit                         | 1 pc  |
| GTIN                                 | <br>4 046356 771580 |
| Weight per Piece (excluding packing) | 9.99 g  |
| Custom tariff number                 | 85365080  |
| Country of origin                    | Ireland   |

### Technical data

#### General

|                          |              |
|--------------------------|--------------|
| Number of connections    | 12           |
| Color                    | silver/black |
| Rotary switch function   | 1 - 0 - 2    |
| Switching program number | S0212        |
| Switching angle          | 60 °         |
| Rated continuous current | 20 A         |
| Maximum load current     | 20 A         |
| Rated surge voltage      | 6 kV         |
| Rated insulation voltage | 690 V        |

# Changeover switch - RS20-US-S0212-0303-014H-001 - 3069712

## Technical data

### General

|  |  |
|--|--|
| Additional text  | Valid for networks with grounded neutral point, surge voltage category III, pollution degree 3 |
| Rated operating current according to AC-15 (switching of solenoid drives, contactors, valves, pulling electromagnets)                        | 5 A (220 - 240 V)  |
|  | 4 A (380 - 440 V)  |
| Rated operating current according to AC-21A (switching of ohmic loads including small overloads)   | 20 A   |
| Rated operating current according to AC-22A (switching of mixed ohmic and inductive loads, including small overloads)                        | 20 A (220 - 500 V)   |
|  | 20 A (660 - 690 V)   |
| Switching power according to AC-3 (squirrel-cage motors: direct starting, switching off motors during operation, star-delta startup (CH16B)) | 3 kW (220 - 240 V; 3-phase, 3-pos.)  |
|  | 5.5 kW (380 - 440 V; 3-phase, 3-pos.)  |
|  | 5.5 kW (500 V; 3-phase, 3-pos.)  |
|  | 5.5 kW (660 - 690 V; 3-phase, 3-pos.)  |
|  | 0.6 kW (110 - 120 V; 1-phase, 2-pos.)  |
|  | 2.2 kW (220 - 240 V; 1-phase, 2-pos.)  |
|  | 3 kW (380 - 440 V; 1-phase, 2-pos.)  |
| Switching power according to AC-4 (squirrel-cage motors: starting, reversing, plugging, inching)   | 0.55 kW (220 - 240 V; 3-phase, 3-pos.)   |
|  | 1.5 kW (380 - 440 V; 3-phase, 3-pos.)  |
|  | 1.5 kW (500 V; 3-phase, 3-pos.)  |
|  | 1.5 kW (660 - 690 V; 3-phase, 3-pos.)  |
|  | 0.3 kW (110 - 120 V; 1-phase, 2-pos.)  |
|  | 0.75 kW (220 - 240 V; 1-phase, 2-pos.)   |
|  | 1.5 kW (380 - 440 V; 1-phase, 2-pos.)  |
| Switching power according to AC-23A (frequent switching of motors or other highly inductive loads)   | 3.7 kW (220 - 240 V; 3-phase, 3-pos.)  |
|  | 7.5 kW (380 - 440 V; 3-phase, 3-pos.)  |
|  | 7.5 kW (500 V; 3-phase, 3-pos.)  |
|  | 7.5 kW (660 - 690 V; 3-phase, 3-pos.)  |
|  | 0.75 kW (110 - 120 V; 1-phase, 2-pos.)   |
|  | 2.5 kW (220 - 240 V; 1-phase, 2-pos.)  |
|  | 3.7 kW (380 - 440 V; 1-phase, 2-pos.)  |
| Breaking capacity  | 150 A (220 - 240 V)  |
|  | 150 A (380 - 440 V)  |
|  | 80 A (660 - 690 V)   |
| IP immunity to short-circuiting with maximum backup fuse   | 25 A   |
| Additional text  | gL/gG characteristics  |
| Rated short-time current resistance  | 140 A  |
| Additional text  | 1 s current  |

### Dimensions

# Changeover switch - RS20-US-S0212-0303-014H-001 - 3069712

## Technical data

### Dimensions

|                    |          |
|--------------------|----------|
| Width              | 48 mm    |
| Length             | 82.5 mm  |
| Height             | 48 mm    |
| Hole diameter      | 7 mm     |
| Height             | 29.00 mm |
| Installation depth | 52.50 mm |

### Ambient conditions

|                                 |  |
|---------------------------------|--|
| Ambient temperature (operation) | -35 °C ... 55 °C (Open, at 100% load, with peaks up to 60°C)         |
|                                 | -35 °C ... 35 °C (Encapsulated, at 100% load, with peaks up to 60°C) |

### Connection data

|   |                      |
|---|----------------------|
| Conductor cross section solid min.  | 0.5 mm <sup>2</sup>  |
| Conductor cross section solid max.  | 2.5 mm <sup>2</sup>  |
| Conductor cross section AWG/kcmil min.  | 20                   |
| Conductor cross section AWG/kcmil max.  | 14                   |
| Conductor cross section stranded min.   | 0.75 mm <sup>2</sup> |
| Conductor cross section stranded max.   | 2.5 mm <sup>2</sup>  |
| Min. AWG conductor cross section, stranded  | 18                   |
| Max. AWG conductor cross section, stranded  | 14                   |
| Conductor cross section / stranded with ferrule without plastic sleeve min.                         | 2.5 mm <sup>2</sup>  |
| Conductor cross section / stranded with ferrule without plastic sleeve max.                         | 2.5 mm <sup>2</sup>  |
| Conductor cross section / stranded with ferrule with plastic sleeve min.                            | 1.5 mm <sup>2</sup>  |
| Conductor cross section / stranded, with ferrule with plastic sleeve max.                           | 1.5 mm <sup>2</sup>  |
| 2 conductors with same cross section, solid min.  | 0.5 mm <sup>2</sup>  |
| 2 conductors with same cross section, solid max.  | 2.5 mm <sup>2</sup>  |
| Two conductors with the same cross section, AWG solid min.  | 20                   |
| Two conductors with the same cross section, AWG solid max.  | 14                   |
| 2 conductors with same cross section, stranded min.   | 0.75 mm <sup>2</sup> |
| 2 conductors with same cross section, stranded max.   | 2.5 mm <sup>2</sup>  |
| Two conductors with the same cross section, AWG stranded, min.                                      | 18                   |
| Two conductors with the same cross section, AWG stranded, max.                                      | 14                   |
| 2 conductors with the same cross section/stranded, with ferrule and without plastic sleeve, minimum | 2.5 mm <sup>2</sup>  |
| 2 conductors with the same cross section/stranded, with ferrule and without plastic sleeve, maximum | 2.5 mm <sup>2</sup>  |
| 2 conductors with the same cross section/stranded, with ferrule and plastic sleeve, minimum         | 1.5 mm <sup>2</sup>  |
| 2 conductors with the same cross section/stranded, with ferrule and plastic sleeve, maximum         | 1.5 mm <sup>2</sup>  |

# Changeover switch - RS20-US-S0212-0303-014H-001 - 3069712

## Classifications

### eCl@ss

|            |          |
|------------|----------|
| eCl@ss 4.0 | 27141111 |
| eCl@ss 4.1 | 27141111 |
| eCl@ss 5.0 | 27141133 |
| eCl@ss 5.1 | 27141133 |
| eCl@ss 6.0 | 27141133 |
| eCl@ss 7.0 | 27141133 |

### ETIM

|          |          |
|----------|----------|
| ETIM 3.0 | EC001121 |
| ETIM 4.0 | EC002498 |
| ETIM 5.0 | EC002498 |

### UNSPSC

|               |          |
|---------------|----------|
| UNSPSC 6.01   | 30211811 |
| UNSPSC 7.0901 | 39121410 |
| UNSPSC 11     | 39121410 |
| UNSPSC 12.01  | 39121410 |
| UNSPSC 13.2   | 39121410 |

## Approvals

### Approvals

---

#### Approvals

UL Listed / cUL Listed / EAC / cULus Listed

---

#### Ex Approvals

---

#### Approvals submitted

---

### Approval details

|                                |       |
|--------------------------------|-------|
| UL Listed                      |       |
| mm <sup>2</sup> /AWG/kcmil     | 20-12 |
| Nominal current I <sub>N</sub> | 20 A  |
| Nominal voltage U <sub>N</sub> | 300 V |

# Changeover switch - RS20-US-S0212-0303-014H-001 - 3069712

## Approvals

|                                |       |
|--------------------------------|-------|
| cUL Listed                     |       |
| mm <sup>2</sup> /AWG/kcmil     | 20-12 |
| Nominal current I <sub>N</sub> | 20 A  |
| Nominal voltage U <sub>N</sub> | 300 V |

|     |
|-----|
| EAC |
|-----|

|              |
|--------------|
| cULus Listed |
|--------------|

## Drawings

Drilling diagram

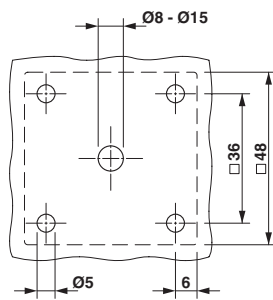

Dimensioned drawing

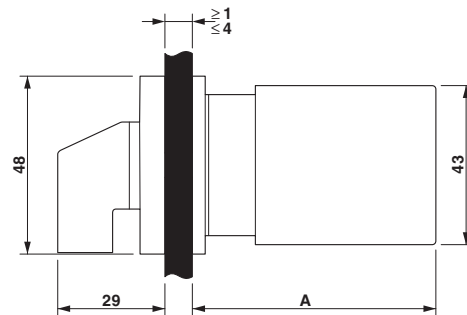

Circuit diagram

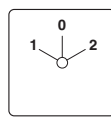

S0212

|   |   |   |   |   |    |    |
|---|---|---|---|---|----|----|
|   | 1 | 3 | 5 | 7 | 9  | 11 |
|   | 2 | 4 | 6 | 8 | 10 | 12 |
| 1 |   | X |   | X |    | X  |
| 0 |   |   |   |   |    |    |
| 2 | X |   | X |   | X  |    |