

Hypra[®] IP 44 and IP 44/55 Prisinter[™]

LV 16 to 125 A

Prisinter - panel mounting sockets - LV 16-32-63 A (p. 340)

Terminal connection (max.)

BT 16 A : rigid - 1 x 4 mm²

BT 32 A : rigid - 1 x 10 mm²

BT 63 A : rigid - 1 x 25 mm²

Prisinter sockets 32 A : flexible - 1 x 6 mm²

Prisinter sockets 63 A : flexible - 1 x 16 mm²

Conform to EN 60309-1, NF EN 60309-2, IEC 60309-1 and IEC 60309-2

IK 09 : plastic and rubber

IK 10 : metal according to EN 62262 et IEC 62262

Self-extinguishing :

850 °C support of active parts, 950 °C for Prisinter

650 °C plastic housing

- 50 °C à + 100 °C (- 20 °C for Prisinter)

Icc 10 kA according to EN 60309-1 and IEC 60309-1

Dust resistance IP may be increased by rubber push-button (on request)

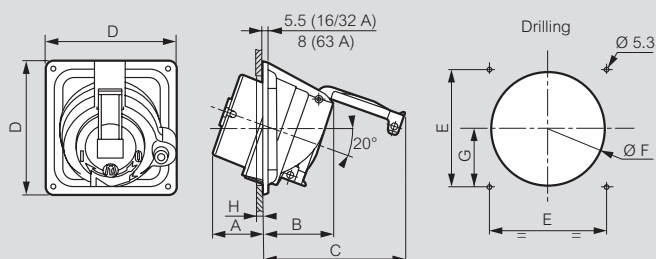

	Material	Weight (kg)	A	B	C	D	E	F		G	H
								min	max		max
16 A											
2P+E	Plastic	0.420	46	70	132	115	100	92	98	46	6 to 10
	Metal	1.250									
3P+E	Plastic	0.480	46	70	138	115	100	92	96	46	6 to 10
	Metal	1.330									
3P+N+E	Plastic	0.570	46	75	156	125	110	102	106	51.5	7
	Metal	1.470									
32 A											
2P+E	Plastic	0.570	54	77	153	143	125	115	122	58.5	10 to 20
	Metal	1.470									
3P+E	Plastic	0.610	54	77	153	143	125	115	122	58.5	10 to 20
	Metal	1.500									
3P+N+E	Plastic	0.650	55	79	169	143	125	119	122	58.5	9 to 13
	Metal	1.800									
63 A											
2P+E	Plastic	0.870	55	99	205	143	125	120	122	59.5	10 to 20
	Metal	1.500									
3P+E	Plastic	0.950	55	99	205	143	125	120	122	59.5	10 to 20
	Metal	1.850									
3P+N+E	Plastic	0.980	55	99	205	143	125	120	122	59.5	10 to 20
	Metal	2.200									

Breaking capacity 3 x 400 V_~ according to IEC 60947-1-3

Category	16 A	32 A	63 A	Category	125 A	
AC 1	16 A	32 A	63 A	AC 22 AC 23	400 V	70 kW
AC 23	8.4 kW	16.8 kW	33 kW		500 V	87 kW
AC 3					600 V	120 kW

Reversible box for Prisinter sockets

LV 16 A (p. 340)

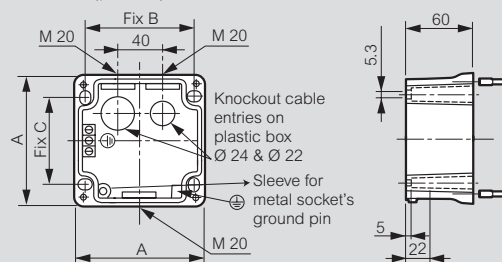

3 entries among which

2 entries M20 sealed with B20P blanking plug for auxiliary contact use
Fitted with 2 connected earth terminals and 1 outside terminal on metal box

	Material	Weight (kg)	A (mm)	B (mm)	C (mm)
2P+E	Plastic	0.140	115	97	78
	Metal	0.800			
3P+E	Plastic	0.160	125	107	88
	Metal	0.900			

LV 32 A (p. 340)

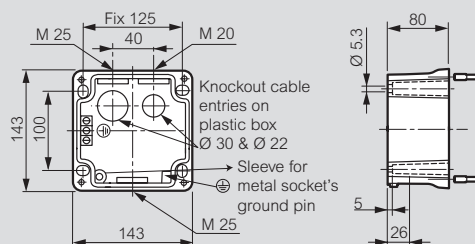

3 entries among which

1 M20 sealed with B20P blanking plug for auxiliary contact
1 M25 sealed with B25P blanking plug

Fitted with 2 connected earth terminals and 1 outside terminal on metal box

LV 63 A (p. 340)

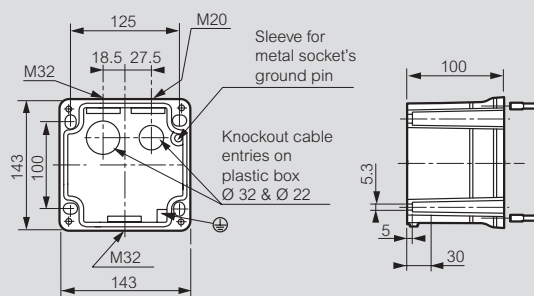

3 entries among which

1 M20 sealed with B20P blanking plug for auxiliary contact
1 M32 sealed with B32P blanking plug

Fitted with 1 outside earth terminal on metal box

Dust resistance IP can be increased by a rubber push-button,
On special request

