

# Centrif® Duo Plus

## Centrifugal Kitchen & Utility Room Fans



### Features & Benefits

- Meets current Building Regulations Approved Document F
- Optional filter available
- Easy installation
- Fan can be wall or ceiling mounted
- Suitable for both kitchen and utility rooms
- Constant trickle boost speed available on DP & HTP models
- IPX4 Rated

### Ultra Quick Ventilation

Centrif Duo Plus is designed to provide extraction levels that comply with Building Regulations Approved Document requirements, with special humidity sensing variants for local authority use.

The Centrif Duo Plus is for kitchens and utility rooms and large bathrooms. Surface mounting directly into standard 100mm diameter ducting, through the wall or ceiling installation.

### Fast installation

The Centrif Duo Plus has a 100mm circular spigot. The Flush mounting kit enables the spigot to be converted to a side outlet.

The spigot also encloses a built-in, spring operated back draught shutter. The Centrif Duo Plus Range can be wall mounted using a telescopic wall fitting kit available as an accessory (requires a 115mm diameter hole). For ceiling applications the range is ducted either through a soffit outlet or roof cowl assembly. There is convenient access for wiring which accommodates surface or recessed installation.

### Improved Humidistat control

Humidistat is selectable for either kitchen or utility speed separate to any other control to reduce nuisance noise. Boost operation by pullcord or switch live.

### Models

#### Centrif Duo Plus P (Pullcord)

Two speed kitchen extract fan with pullcord. Choice of two speeds for boost, set at installation.

Stock Ref  
**431613**

#### Centrif Duo Plus T (Timer)

Two speed with adjustable timer between 2-30 minutes. Choice of two speeds for boost, set at installation.

Stock Ref  
**431614**

#### Centrif Duo Plus DP (Two speed)

Two speed and Off with pullcord or remote switch. Switches between Off, low and one of the 2 boost speeds.

Stock Ref  
**431615**

#### Centrif Duo Plus HTP (Humidity)

Intermittent on 1 of 2 speeds (Utility or Kitchen selectable at installation). Operation by integral humidity sensor or pullcord. Separate speeds selectable for humidistat and pullcord. Optional continuous trickle speed available at installation.

Stock Ref  
**431616**

### Flush Mounting Kit

Bezel, clips and 90° duct elbow reduces the need to make good.

Stock Ref  
**439256**

### Centrif Duo Plus Filter

Stock Ref  
**439927**

### Wall Kit

Stock Ref  
**254102 (White)**  
**254100 (Brown)**

### Decoration Frame Assembly

Stock Ref  
**442551**

### Dimensions (mm)

A	B	C	D	E	FØ
231	261	140	79	58	98

Weight 1.75kg

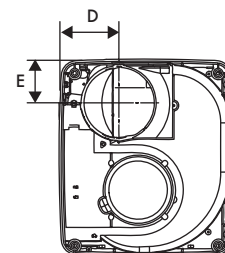
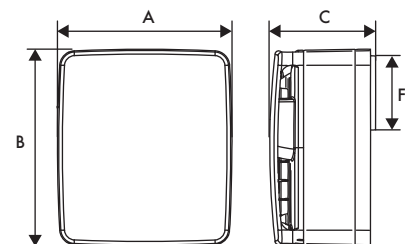

### Performance

Performance @ 0 Pa

Model	High speed		Med speed		Low speed		Power (W)			Sound dB(A) @3m		
	m³/h	l/s	m³/h	l/s	m³/h	l/s	Kitchen	Utility	Trickle	Kitchen	Utility	Trickle
Centrif Duo P/T	220	61	130	36	-	-	60	41	N/A	51.8	38	N/A
Centrif Duo DP/HTP	220	61	130	36	90	25	60	41	9	51.8	38	21.5