



IFC certification

Certificate number: FS453/09



SERVICE PENETRATIONS



PFC Corofil Intumescent Pillows



Application

PFC Corofil Intumescent Pillows will provide up to 4 hours fire protection to metal services and cables passing through compartment floors and walls.

General benefits:

- Simple to install
- Easy to remove and reinstate whilst changing services
- Maintenance free
- Dry System
- 3rd Party Certificated

Fire Rating

PFC Corofil Intumescent Pillows will provide 4 hours fire integrity and 2 hours insulation rating as tested in accordance with BS 476:Part 20 & BS EN 1366-3.

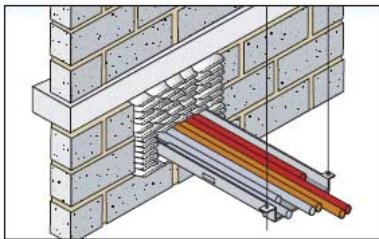

PFC Corofil Intumescent Pillows friction fitted between services and firewall.

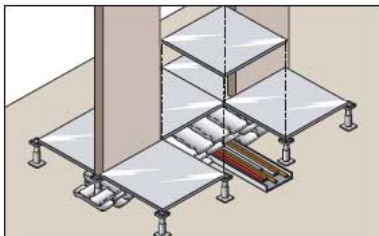

PFC Corofil Intumescent Pillows forming cavity barrier under raised access floor.

Specification

Install PFC Corofil Intumescent Pillows to provide up to 4 hours fire protection where services pass through fire rated walls and floors. Installation to be fully in accordance with manufacturer's instructions.

Description

The pillows are simply packed tightly in between penetrating services and the wall. In a floor, pillows are additionally supported by means of a mesh support system (see diagram).

Under fire conditions, the pillows expand several times their original volume to form an effective seal around service penetrations. Pillows are suitable for use with:

- Metal Pipework
- Cable Trays
- Electrical Trunking (inside and outside)

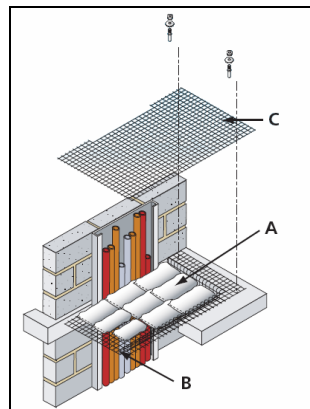

PFC Corofil Intumescent Pillows supported by mesh cage in service riser floor.

Labels

- A** = PFC Corofil Intumescent Pillows
- B** = Basket of galvanised steel wire mesh 50mm x 50mm squares, wire diameter 2.5mm mesh basket mechanically fixed to floor slab.
- C** = Wire mesh as above, overlapping basket mesh and tied together with steel wire

Estimating Quantities

| Pillow Size | Approximate Number |
|----------------------|--------------------|
| 300mm x 50mm x 35mm | 660 per m2 opening |
| 300mm x 100mm x 35mm | 330 per m2 opening |
| 300mm x 150mm x 35mm | 220 per m2 opening |
| 300mm x 200mm x 35mm | 165 per m2 opening |

FIRE RATINGS



Tested to BS 476:Part 20 & EN 1366-3

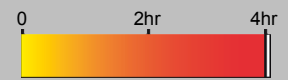

TECHNICAL INFORMATION

You can request from our technical sales office the following information:

- Material Safety Data Sheets
- Installation Instructions
- Product Certification

ORDERING

When ordering this product you will need the following information:

- Details of hole size
- Details of service penetrations
- Quantity required

Please order from our technical sales office.

PFC Corofil
 Units 3-4
 King George Trading Estate
 Davis Road
 Chessington
 Surrey KT9 1TT

Tel: + 44 (0) 208 391 0533
 Fax: + 44 (0) 208 391 2723
 Email: sales@pfc-corofil.com
 www.pfc-corofil.com

