

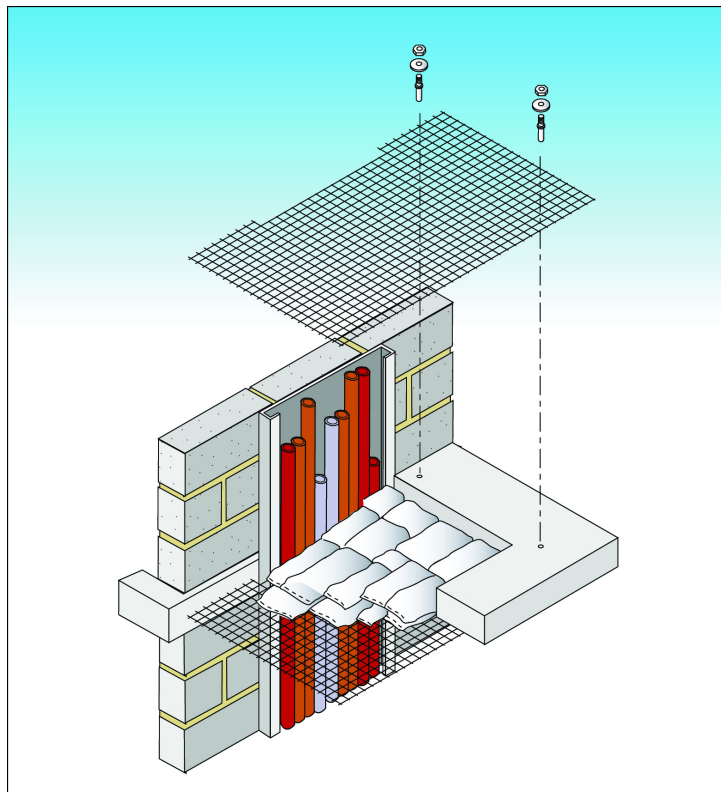

C300P INTUMESCENT PILLOWS

PFC Corofil C300 P Intumescent Pillows have been developed to provide both a temporary and permanent fire barrier to services passing through compartment walls and floors.

- Up to 4 hour fire protection
- Maintenance free
- Clean and simple installation
- Easy to remove and reinstate for new services

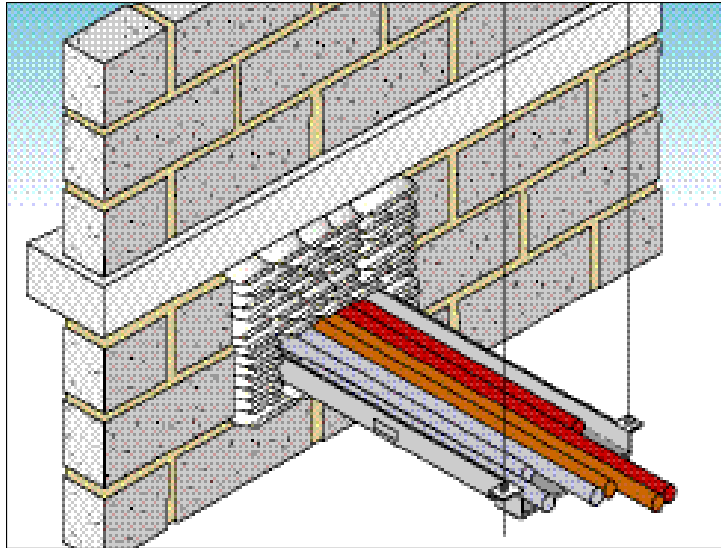



C300P INTUMESCENT PILLOWS

Description

PFC Corofil C300 P Intumescent Pillows are manufactured from a durable glass fibre cloth. The pillow contains a mixture of non-hazardous, water resistant exfoliating fillers.

PFC Corofil C300 P Intumescent Pillows are simply packed tightly in between penetrating services and the wall. In a floor, pillows are additionally supported by means of mesh support system. (See Diagram)

Under fire conditions, PFC Corofil C300 P Intumescent Pillows expand several times their original volume to form an effective seal around service penetrations.

PFC Corofil C300 P Intumescent Pillows are suitable for use with:

- Metal pipework
- Cable Trays
- Electrical Trunking (inside and outside)

Estimating Quantities

PFC Corofil C300 P Intumescent Pillows are available in four sizes and the table below outlines approximate quantities of each size to fill one m² area.

Pillow size (mm)	Approximate number per m ² opening
300 x 200 x 30	165
300 x 150 x 30	220
300 x 100 x 30	330
300 x 50 x 30	660

Fire Ratings

PFC Corofil C300 P Intumescent Pillows have been shown to provide four hour fire integrity and two hour insulation rating as tested in accordance with BS476 Part 20.

Specification

Install PFC Corofil C300 P Intumescent Pillows to provide a four hour rating. Installation to be fully in accordance with manufacturers instructions.

To order

Contact our technical sales office (Tel: 020 8391 0533) with details of hole sizes, penetrating services and quantities.

Technical

For further information relating to the installation and health and safety please refer to the Fire Stop installation instructions.