

D2E146-HT67-02

# AC centrifugal fan with housing (small flange)

forward curved, dual inlet



**ebm-papst Mulfingen GmbH & Co. KG**

Bachmühle 2

74673 Mulfingen

Phone: +49 7938 81-0

Fax: +49 7938 81-110

[www.ebmpapst.com](http://www.ebmpapst.com)

[info1@de.ebmpapst.com](mailto:info1@de.ebmpapst.com)

## Nominal data

Type	D2E146-HT67-02		
Motor	M2E068-EC		
Phase		1~	1~
Nominal voltage	[V]	230	230
Frequency	[Hz]	50	60
Type of data definition		ml	ml
Valid for approval / standard		CE	CE
Speed	[min <sup>-1</sup> ]	1850	2100
Power input	[W]	355	400
Current draw	[A]	1.55	1.75
Motor capacitor	[µF]	8	8
Capacitor voltage	[VDB]	450	450
Capacitor standard		P2 (CE)	P2 (CE)
Min. back pressure	[Pa]	0	200
Max. ambient temperature	[°C]	55	50
Air flow	[m <sup>3</sup> /h]	1060	875
Back pressure	[Pa]	0	200
Sound pressure level	[dB(A)]	66	63

ml = max. load · me = max. efficiency · rfa = running at free air · cs = customer specs · cu = customer unit  
Subject to alterations

## Technical features

Leakage current	< 0,75 mA
Size	146 mm
Operation mode	S1
Direction of rotation	Counter-clockwise, seen on rotor
Speed steps	4
Mounting position	Any
Electrical leads	Via terminal box, integrated capacitor connected via terminal box; With plug
Insulation class	"F"
Cable exit	Variable
Condensate discharge holes	None
Bearing motor	Ball bearing
Mass	3.6 kg
Housing material	PP plastic, black
Material of terminal box	PP plastic, black
Material of impeller	Sheet steel, hot-galvanised
Motor suspension	Motor anti-vibration mounted on both sides
Motor protection	Thermal overload protector (TOP) wired internally
Product conforming to standard	CE; EN 60335-2-31
Surface of rotor	Partially cast in aluminium
Type of protection	IP 20
Protection class	I
Max. permissible ambient motor temp. (transp./ storage)	+ 80 °C
Min. permissible ambient motor temp. (transp./storage)	- 40 °C
Approval	VDE

Product drawing

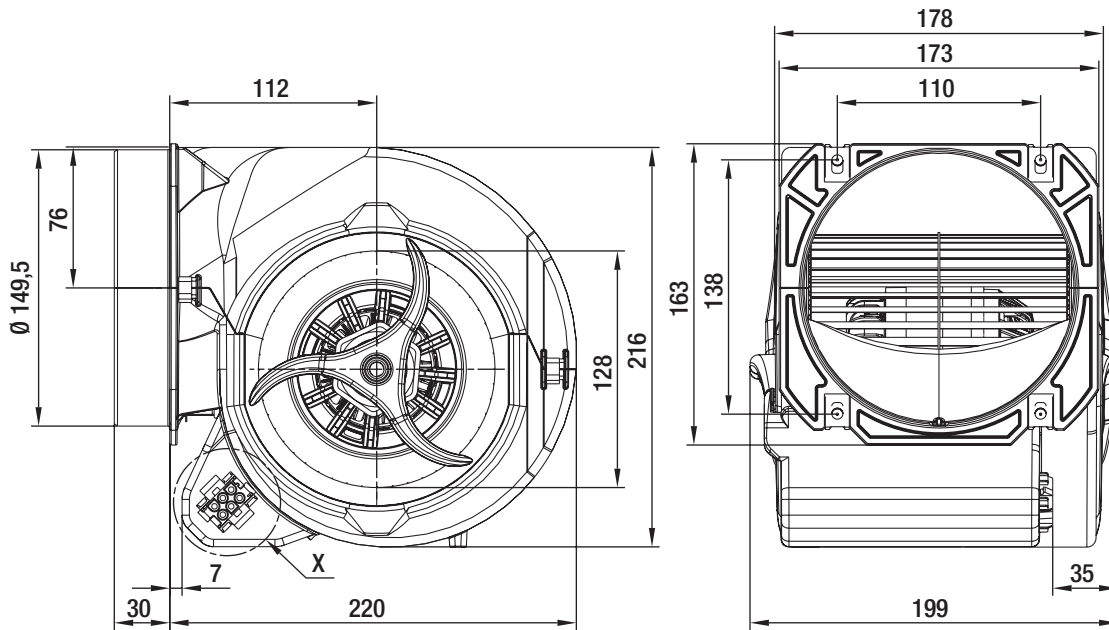

## Connection screen

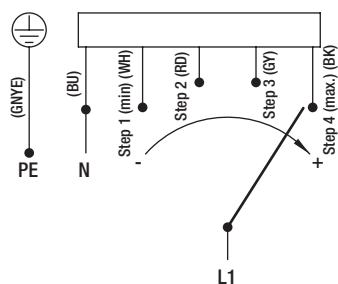

## Charts: Air flow

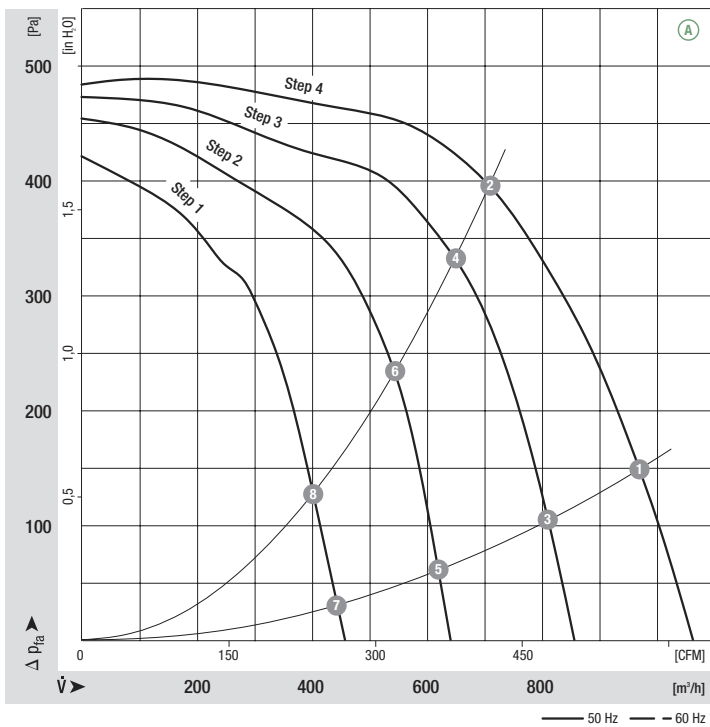

## Measured values

	<b>n</b>	<b>P<sub>1</sub></b>	<b>I</b>	<b>LpA<sub>ss</sub></b>
	[min <sup>-1</sup> ]	[W]	[A]	[dB(A)]
1	2075	328	1.42	66
2	2430	269	1.17	61
3	1770	268	1.2	61
4	2230	222	1.04	62
5	1375	225	1.03	54
6	1885	197	0.94	57
7	1000	192	0.88	45
8	1415	180	0.84	49