

REV.	DATE	DESCRIPTION
NC	04/06/03	INITIAL RELEASE

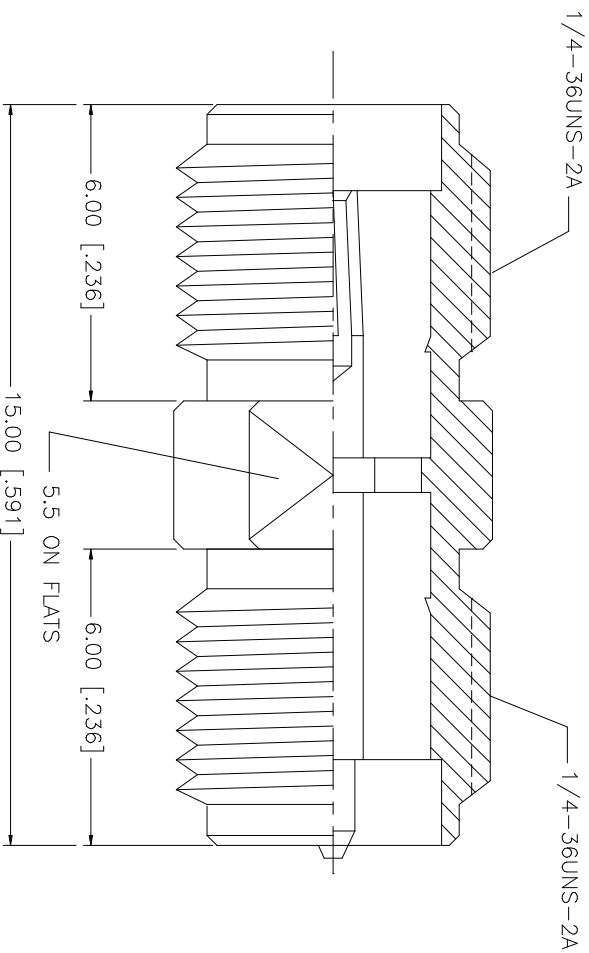

UNLESS OTHERWISE SPECIFIED DIMENSIONS ARE IN MILLIMETERS. DIMENSIONS IN [] ARE IN INCHES AND FOR CUSTOMER REFERENCE ONLY. TOLERANCES FOR MILLIMETERS ARE:	APPROVALS	DATE	PART DESCRIPTION
0.5 - 8mm ± 0.20mm	DRAWN G.R.S.	04/06/03	Amphenol Connex SMA JACK TO REVERSE POLARITY JACK ADAPTER 132169RP
8 - 30mm ± 0.40mm	CHECKED		
30 - 120mm ± 0.50mm	ISSUED		
	SHEET 1 OF 1		
UNLESS OTHERWISE SPECIFIED DIMENSIONS ARE IN MILLIMETERS. DIMENSIONS IN [] ARE IN INCHES AND FOR CUSTOMER REFERENCE ONLY. TOLERANCES FOR INCHES ARE:	CAD FILE		
0.20 - .315 = ± 0.007"	C:/132/132169RP.DWG		
.315 - 1.180 = ± 0.015"	DWG. NO.		
1.180 - 4.724 = ± 0.020"	132169RP.DWG		
	REV.	NC	
	SIZE	A	
	SCALE	NA	
8			
7			
6			
5			
4			
3	CONTACT PIN	BER. COPPER	GOLD
2	INSULATOR	TEFLON	NATURAL
1	HOUSING/BODY	BRASS	GOLD
	DESCRIPTION	MATERIAL	FINISH
			QTY
			DO NOT SCALE DRAWING