

产品说明 Product Description

- ◆ Uses a new type impeller made of plastic or high-quality aluminum alloy, the former to the blade.
叶轮采用新型塑料或优质铝合金制成，前向式叶片。
- ◆ Scroll wheel and impeller made of galvanized steel sheet
蜗壳和风轮均采用镀锌钢板制成。
- ◆ Scroll plastic, wind-round use of galvanized steel plates.
电机由蜗壳两侧的安装支架固定。
- ◆ Impeller and external rotor motor constitute a whole, as the impeller wheel of the drive motor is air cooled efficiently.
叶轮与外转子电机构成整体，成为叶轮轮毂的驱动电机被气流高效地冷却。
- ◆ Motor protection class: IP44
电机防护等级：IP44

AC centrifugal blowers 交流离心鼓风机
dual inlet Ø 133 mm 双进风式



技术参数 Specifications



Model	Rated Voltage	Frequency	Current Amp	Rated Input Power	Speed	Max Air Flow	Max Static Pressure	Start capacitor	Noise Level
(型号)	(VAC) (额定电压)	(Hz) (频率)	(Amp) (额定电流)	(Watt) (额定功率)	(rpm) (转速)	(m³/h) (风量)	(Inch-H₂O) (风压)	(uF/VAC) (启动电容)	(dB-A) (噪音)
F13392E-23G-B21	1~230	50/60	1.2/1.25	275/285	1250/1140	890/805	1.61/155	5/450	57

* The max. air flow and the speed are measured in free air; max. air pressure is measured at zero air flow

*以上数据是在最大气流量和速度测量，压力是零空气流量测量。

特性曲线图 Characteristic curve

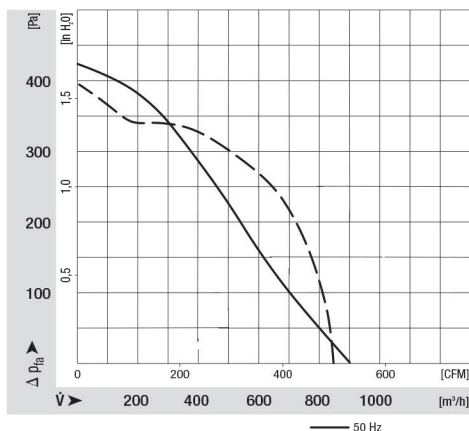

Use of the environment

- ◆ Temperature: -20 ° -- + 55 °
- ◆ Relative Humidity: ≤ 90%
- ◆ Pressure: 55 Kpa (Considerable elevation 4000m)
- ◆ Vibration: 10-55Hz, Double amplitude 1.5mm
- ◆ 40 °C when the expected life of 30,000 hours

使用环境

- ◆ 温度：-20° — +55°
- ◆ 相对湿度：≤ 90%
- ◆ 气压：55 Kpa (相当海拔4000m)
- ◆ 振动：10-55Hz，双振幅1.5mm
- ◆ 40 °C时期望使用寿命30000小时

外形图 Dimensions (Unit:mm)

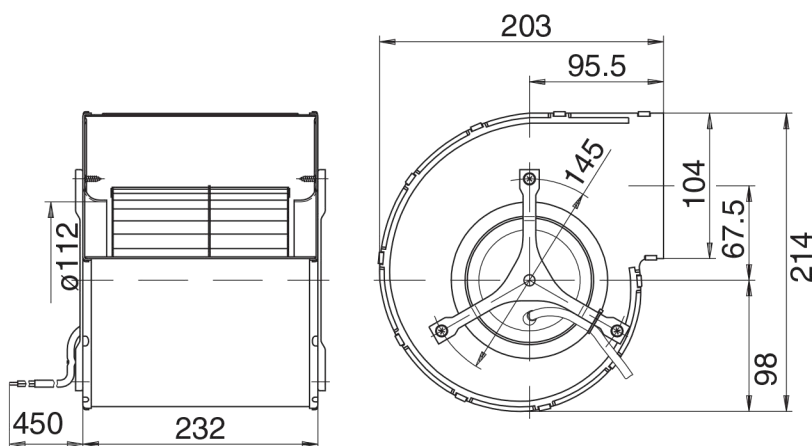

AC后倾式风机
Ø 133 ~ Ø 400

AC单进风式风机
Ø 108 ~ Ø 200

AC双进风式风机
Ø 133 ~ Ø 150

AC前倾式风机
Ø 108 ~ Ø 200

DC后倾式风机
Ø 133 ~ Ø 355

DC单进风式风机
Ø 108 ~ Ø 150